



finder[®]
RELAYING INNOVATION

Finder YOU

Configuration manual



Free app for configuring Finder smart system products
YESLY and BLISS

Available on:



FIRST STEPS & “MORE” SECTION	3
YESLY DEVICES	4
COMMON CONFIGURATION	5
FUNCTIONS OF INDIVIDUAL YESLY DEVICES	10
• TYPE 13.72 FUNCTIONS	10
• TYPE 13.22 FUNCTIONS	11
• TYPE 13.21-B FUNCTIONS	12
• TYPE 15.71 FUNCTIONS	13
• TYPE 15.21.8 FUNCTIONS	14
• TYPE 15.21.9 FUNCTIONS	15
• TYPE 13.S2 FUNCTIONS	16
• TYPE 1Y.P2 FUNCTIONS	17
• WIRELESS BUTTON FUNCTIONS	18
SCENE CREATION	19
APPLICATION CONFIGURATION	25
• CONFIGURATION OF ACTUATORS AND DIMMERS	26
• CONFIGURATION OF INPUT INTERFACES	28
• CONFIGURATION OF THE GATEWAY	30
• CONFIGURATION OF WIRELESS BUTTONS	32
BLISS DEVICES	34
THERMOSTAT PAIRING	35
• BLISS WI-FI PAIRING (TYPE 1C.91)	35
• BLISS2 PAIRING (TYPE 1C.B1)	40
• RADIO-FREQUENCY ACTUATOR PAIRING (TYPE 13.21-S)	44
BLISS THERMOSTAT FUNCTIONS	48
• GENERAL FUNCTIONS	48
• MANUAL SETTINGS	49
• WEEKLY PROGRAM	50
• PRESET: CREATION AND APPLICATION	53
• BLISS WI-FI SPECIFIC FUNCTIONS (TYPE 1C.91)	58
• BLISS2 SPECIFIC FUNCTIONS (TYPE 1C.B1)	59
SETTINGS SECTION	60
HOUSE CUSTOMIZATION	61
• ROOM CUSTOMIZATION	61
• CUSTOMIZATION OF INDIVIDUAL DEVICES OR SCENES	63
• MOVING INDIVIDUAL DEVICES OR SCENES INTO OTHER ROOMS	65
• REARRANGING HOMEPAGE ELEMENTS	67
• HOMEPAGE ELEMENT CUSTOMIZATION	69
SHARING AND ACCESSES	71

FIRST STEPS & “MORE” SECTION

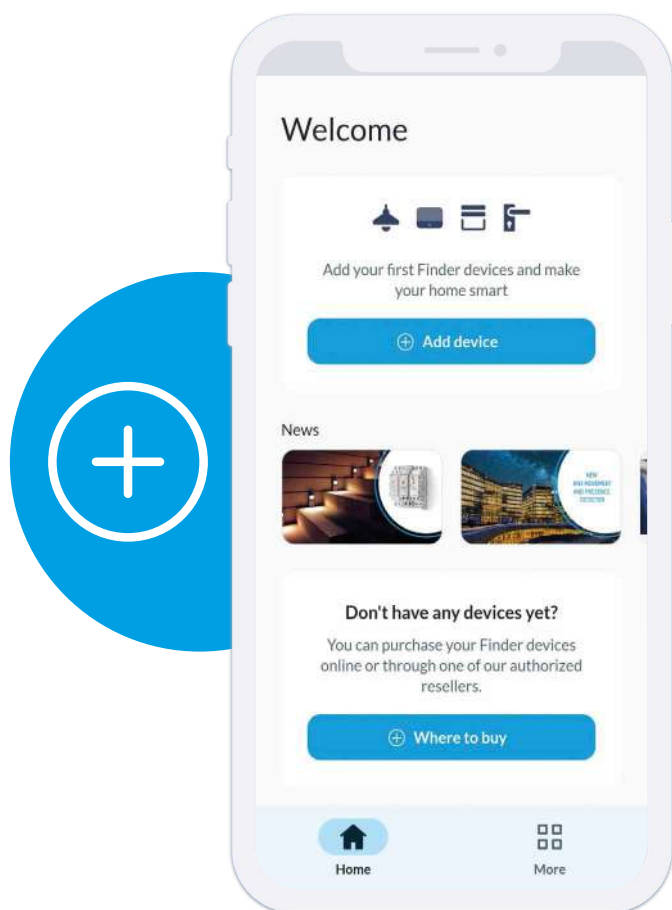

After logging in, it's possible to click on "Add Device" to start configuring the devices.

It is possible to do a complete configuration without being physically on site.

In the "More" section it's possible to get the following useful information:

- Houses of which the user is Owner or Technician
- Details on the Finder Account, like the access email
- Information on the App version
- App theme (light or dark)
- Receive assistance
- Information on privacy legislation

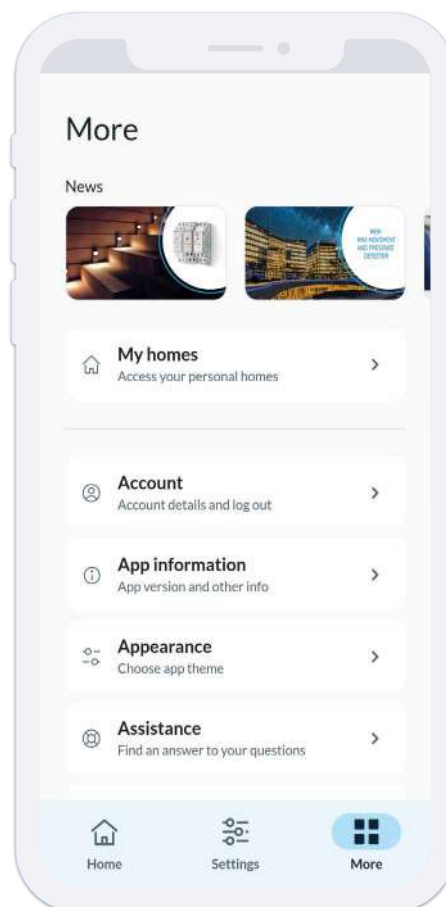

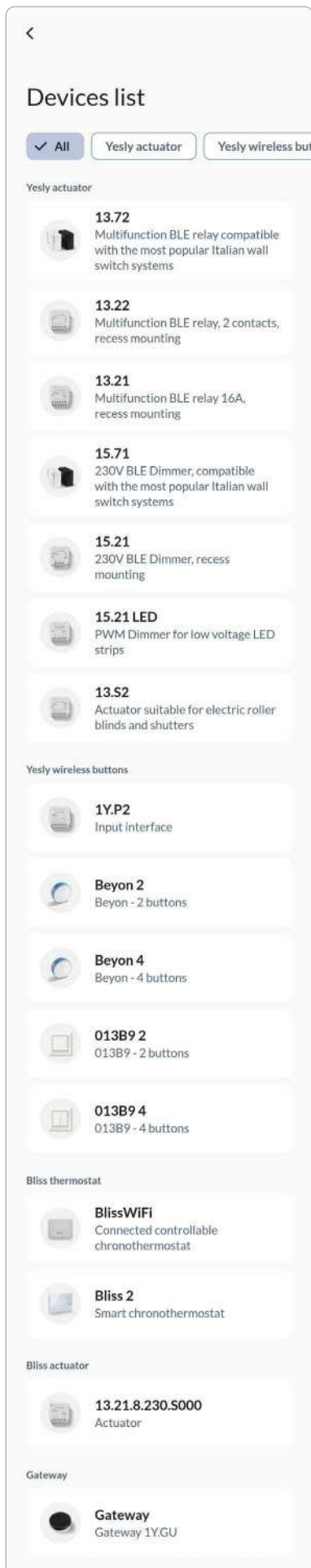

After selecting on “**Add Device**”, the Device Catalogue is displayed, from which the user can select the product to be installed in the electrical system later on.

It's possible to choose from the YESLY and BLISS devices that can be configured through the Finder YOU App.

It is strongly recommended to do the “**logic**” configuration of the system first and then to apply the settings to the devices once installed and powered up.

COMMON CONFIGURATION

THE FOLLOWING CONFIGURATION SEQUENCE IS REPEATED FOR ALL YESLY DEVICES.



LOGIC ENTRY OF THE YESLY DEVICES

Entry of actuators, dimmers and gateways.
Creation of the various rooms.
Entry and pairing of the wireless buttons.

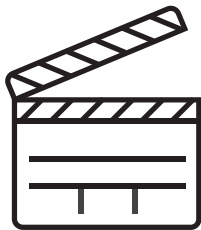

LOGIC ENTRY OF THE YESLY DEVICES

Entry of actuators, dimmers and gateways.
Creation of the various rooms.
Entry and pairing of the wireless buttons.

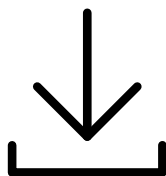

LOGIC ENTRY OF THE YESLY DEVICES

Entry of actuators, dimmers and gateways.
Creation of the various rooms.
Entry and pairing of the wireless buttons.

ALL YESLY DEVICES FOLLOW A SIMILAR CONFIGURATION SEQUENCE, MEANING THAT IT'S POSSIBLE TO DECIDE WHETHER TO PAIR THEM TO A GATEWAY OR NOT BASED ON THE USER'S NEEDS

01

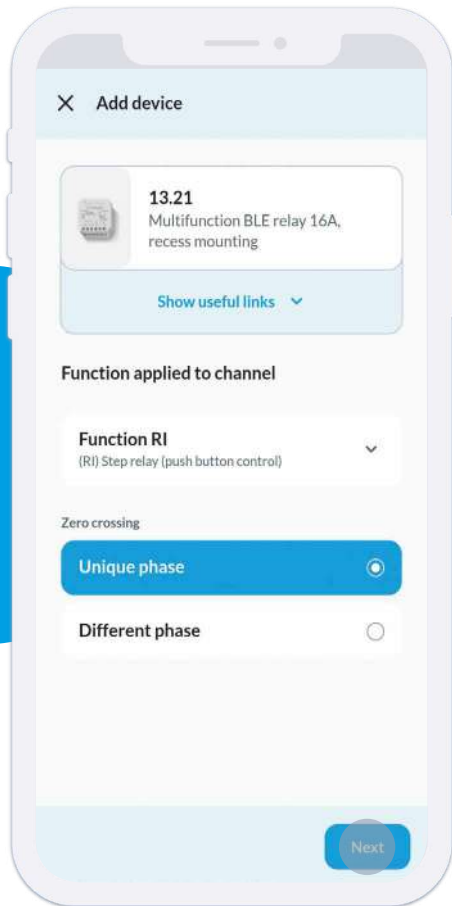

Once the product has been chosen it's possible to select the function and the various settings of the device (see following section).
Select **"Next"** to continue.

Name the device to identify it later on, select an icon and input the name of the room in which it will be installed (if unknown, name a generic room).
Select **"Next"** to continue.

02

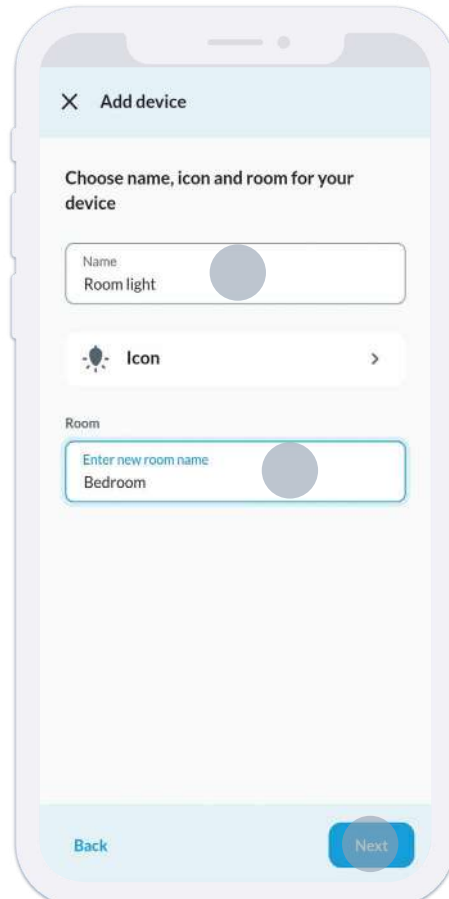

03

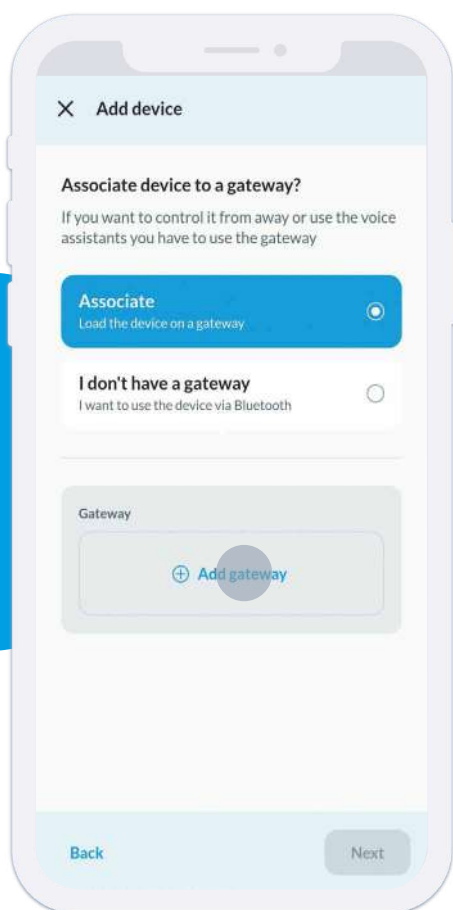

Select **"Add gateway"** if you wish to use a Type 1Y.GU.005.1 gateway to access the system remotely and/or with voice assistants, then follow the pairing procedure.

Otherwise, select **"I don't have a gateway"** if you wish to use the system locally or if you'll add the gateway later on.

Then skip to point n.7.

In this step we are adding a gateway to the system. Name the device and select **"Finish"**.

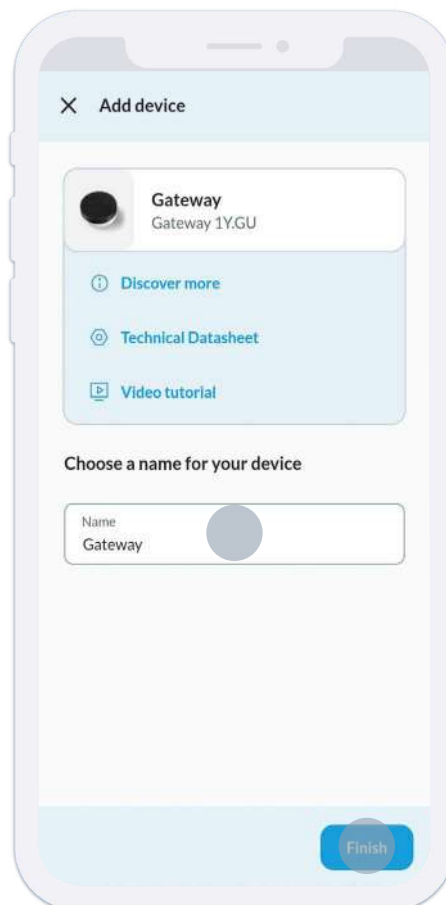

04

05

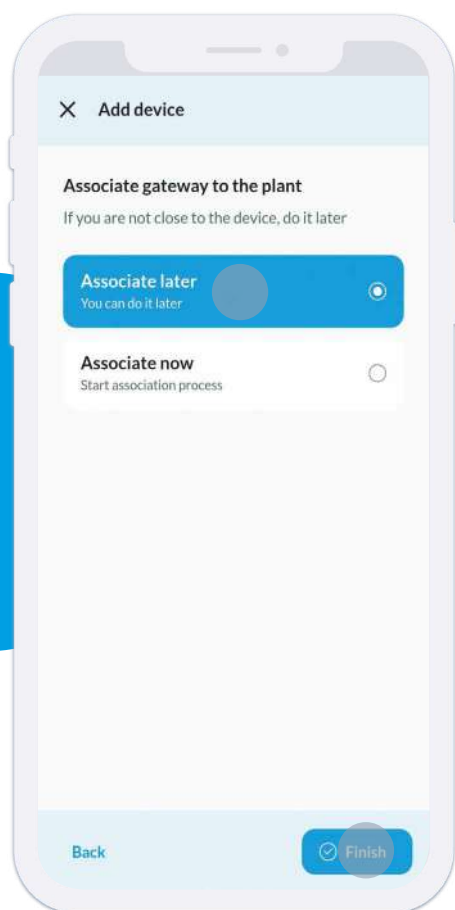

Select “Pair later” and then “Finish” to proceed with the configuration.

Once a gateway has been added to the system the display will look like this. Select “Next” to continue.

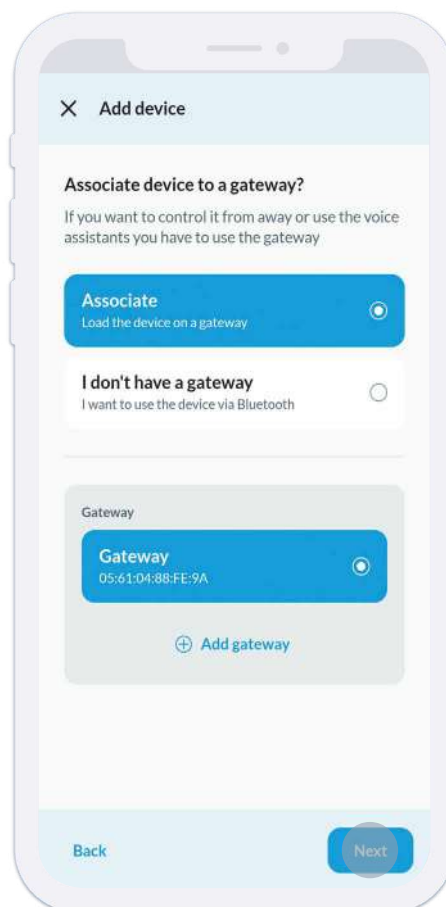

06

07

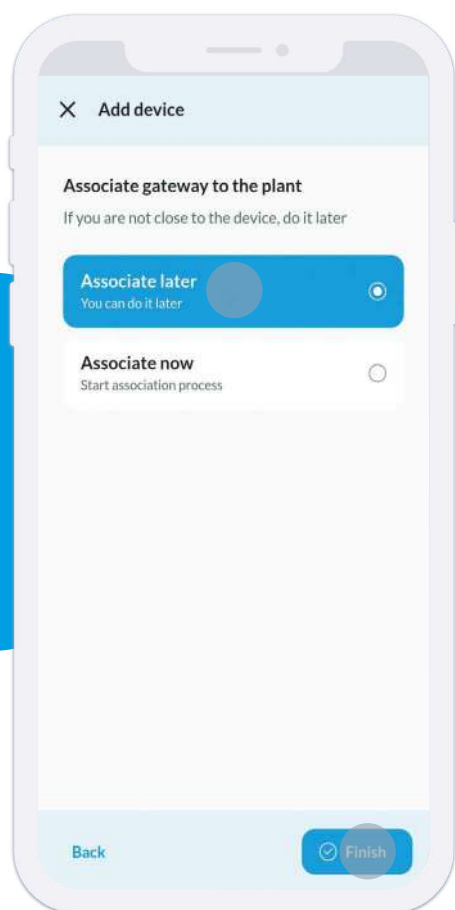

Select **“Pair later”** and then **“End”** to proceed with the configuration.

Now the first device has been added to the system. Select **“Add device”** and repeat the process to enter the other devices that make up the system. Once all the devices are added, go to the **“Creation of a scene”**. If no scenes are needed, skip to **“Configuration Application”**.

08

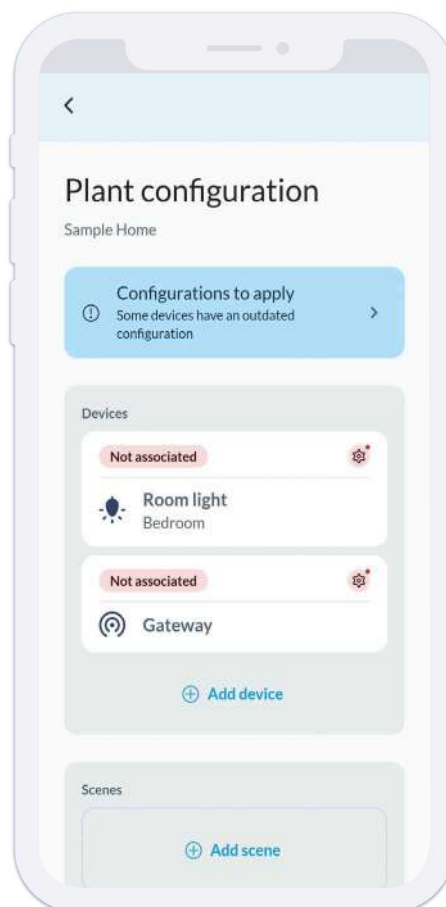

FUNCTIONS OF THE INDIVIDUAL YESLY DEVICES

EACH YESLY DEVICE HAS SPECIFIC FUNCTIONS, IN THIS SECTION WE GO INTO DETAIL FOR EACH ONE OF THEM

TYPE 13.72 FUNCTIONS

THE TYPE 13.72 (AS IN THE CASE OF THE 13.22) CAN HAVE ITS CHANNELS WORK “TOGETHER” OR “SEPARATELY”

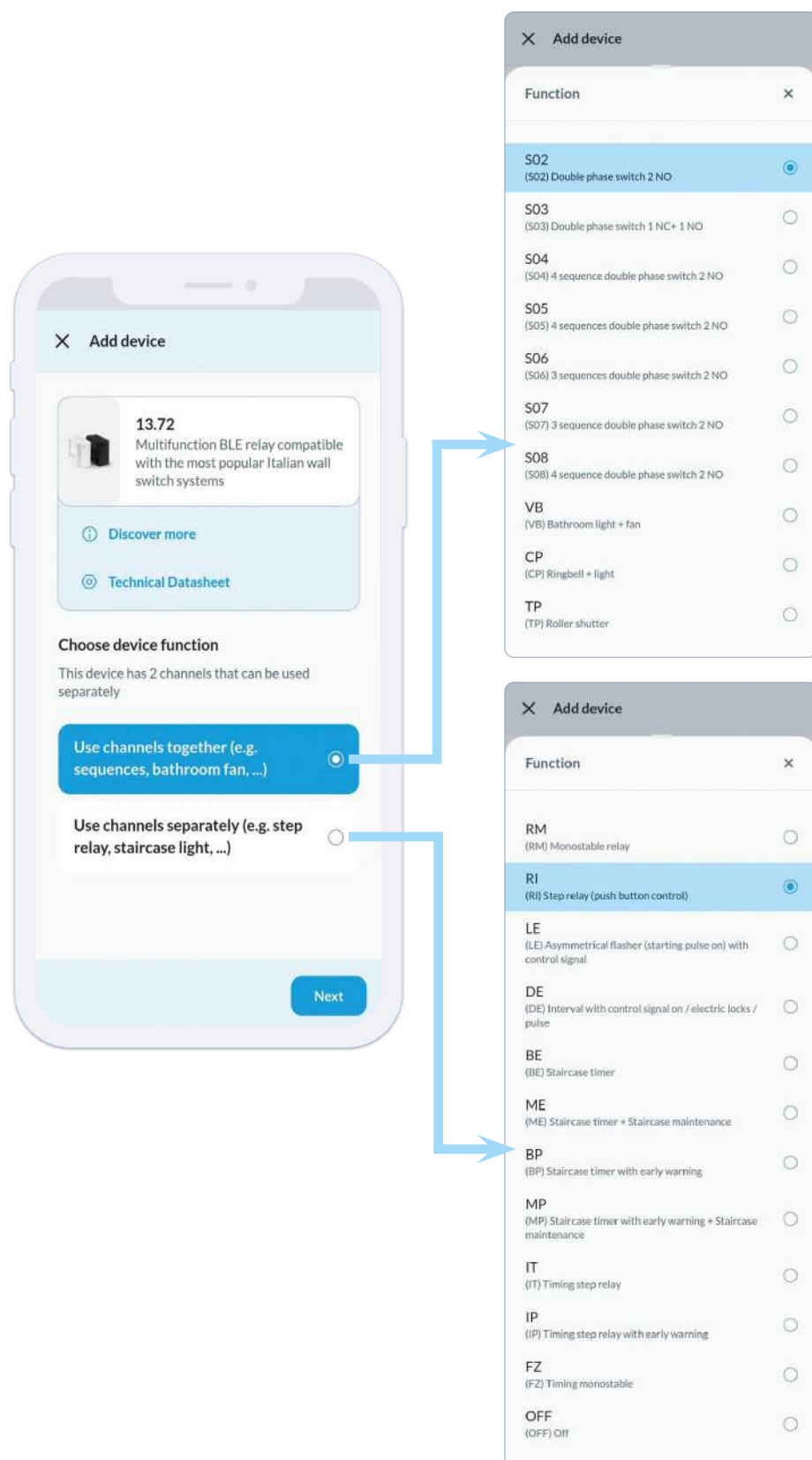

Using the channels “together” we can use the device as a sequence step relay or activate special functions, like:

- Bathroom light + fan
- Ringbell + light
- Roller blinds

KEEP IN MIND

The Type 13.72 is the only device that can control both lights and roller blinds, but it cannot manage the shutter opening percentages.

By using the channels “separately”, a large selection of functions become available, such as step relay (push-button only), staircase light timer, flashers, pulses (DE 2 sec) and many more. Select “**More info**” for further information and the related timing diagram.

KEEP IN MIND

If one of the channels remains unused, it is necessary to set it to the OFF function.

KEEP IN MIND

Once the channels are set up as together or separate, this setting cannot be changed. To switch settings, remove and pair the device again.

TYPE 13.22 FUNCTIONS

THE TYPE 13.22 (AS IN THE CASE OF THE 13.72) CAN HAVE ITS CHANNELS WORK “TOGETHER” OR “SEPARATELY”

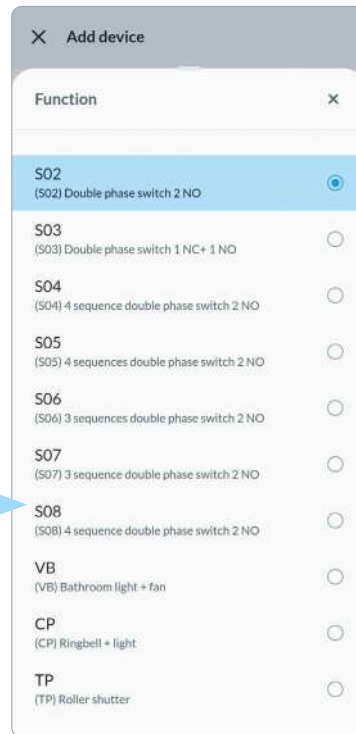
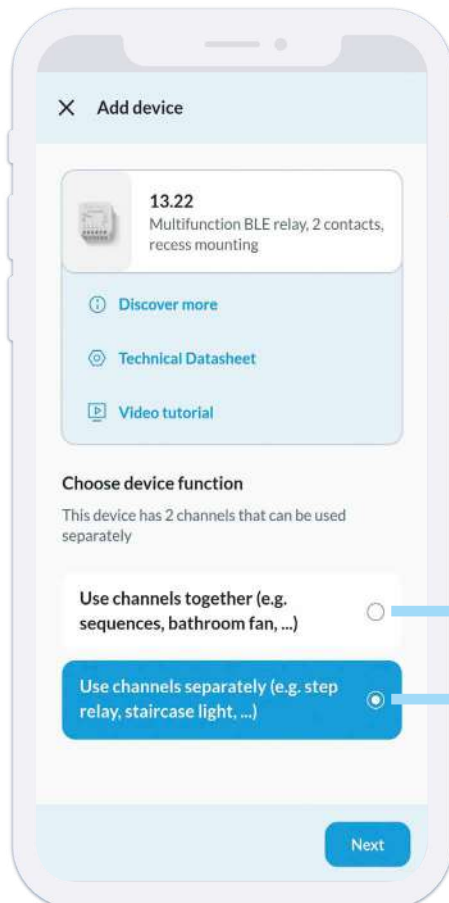

Using the channels “**together**” we could use the device as a sequence step relay or activate special functions, like:

- Bathroom light + fan
- Ringbell + light

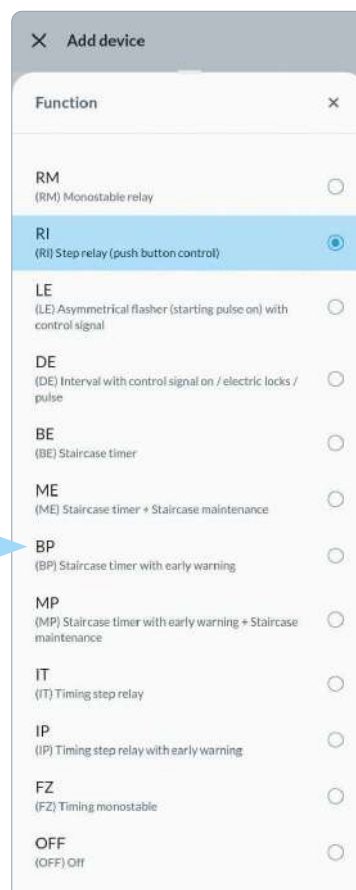

By using the channels “**separately**”, a large selection of functions become available, such as step relay (push-button or switch), staircase light timer, flashers, pulses (DE 2 sec) and many more. Select “**More info**” for further information and the related timing diagrams.

KEEP IN MIND

If one of the channels remains unused, it is necessary to set it to the OFF function.

KEEP IN MIND

Once the channels are set up as together or separate, this setting cannot be changed. To switch settings, remove and pair the device again.

TYPE 13.21-B FUNCTIONS

THE TYPE 13.21-B IS THE YESLY SINGLE-CHANNEL ACTUATOR (CONTRARY TO THE 13.21-S THAT CAN BE USED ONLY AS A REMOTE CONTACT FOR THE BLISS2 THERMOSTAT). THE AVAILABLE FUNCTIONS ARE AS FOLLOWS

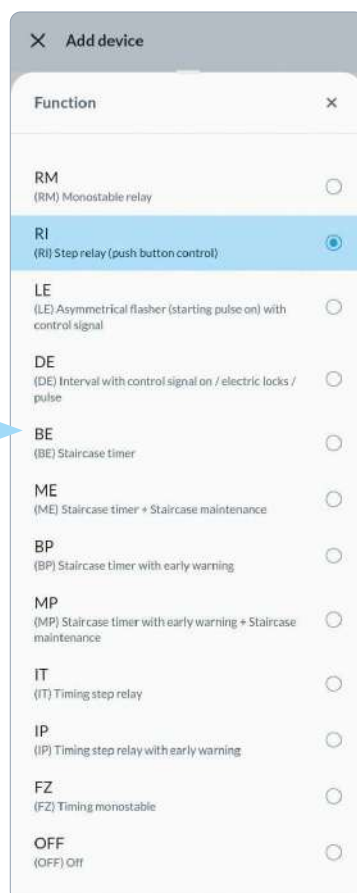
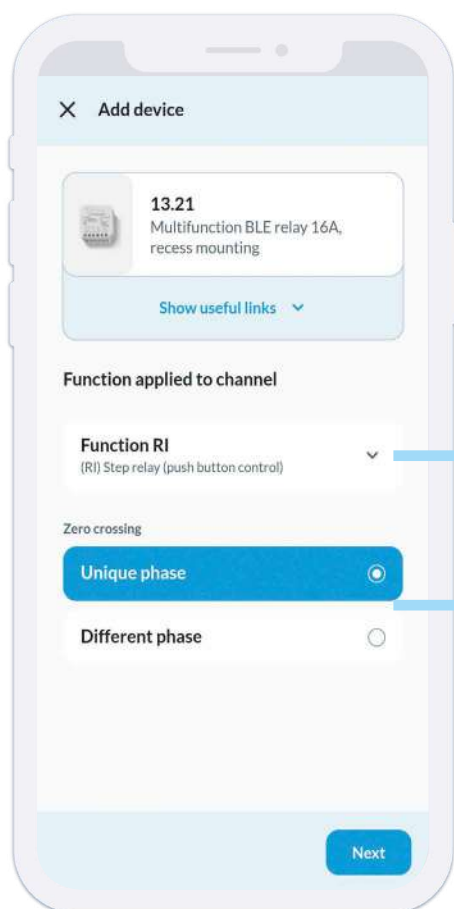

A large selection of functions become available, such as step relay (push-button or switch), staircase light timer, flashers, pulses (DE 2 sec) and many more. Select **“More info”** for further information and the related timing diagrams.

KEEP IN MIND

To use the Type 13.21-B to control an electric lock or any other pulse command, select function DE and set a timer of at least 2 seconds.

To guarantee a correct zero-crossing keep **“Same phase”** set up. Use the **“Different phase”** function only in case of a device installed in a 3-phase system while using a phase for power supply and another for the switching. In this case, the output gets a 50% maximum current reduction.

TYPE 15.71 FUNCTIONS

THE TYPE 15.71 IS A 230 V AC PHASE CUTTING DIMMER, HENCE IT HAS MANY FUNCTIONS AND PARAMETER AT ITS DISPOSAL, TO ADAPT TO VARIOUS SYSTEM CONDITIONS

15.71

230V BLE Dimmer, compatible with the most popular Italian wall switch systems

Discover more

Technical Datasheet

Function applied to channel

LEDRC1

(1) LED, Halogen, Electronic transformers – TE – Linear

Minimum light value

5 %

Switch time

0''

Regulation time

1''

Scene time

1''

Memory

Inactive

Restore after blackout

Inactive

Next

Function	
LEDRC1 (1) LED, Halogen, Electronic transformers - TE - Linear	<input checked="" type="radio"/>
LEDRC2 (2) LED, Halogen, Electronic transformers - LE - Linear	<input type="radio"/>
LED3 (3) LED - TE - Exponential	<input type="radio"/>
LED4 (4) LED - LE - Exponential	<input type="radio"/>
CFL1 (5) CFL - TE - Exponential	<input type="radio"/>
CFL2 (6) CFL - LE - Exponential	<input type="radio"/>
L (7) Electromagnetic transformer - LE - Exponential	<input type="radio"/>
AUTO (AUTO) AUTOMATIC	<input type="radio"/>

It's possible to set up trailing edge or leading edge functions, based on the type of applied load.

If the load is unknown it's possible to use the AUTO function so that the dimmer adapts automatically to it.

The default function is the linear trailing edge for LED (LEDRC1), it is advised to keep it as it is and to modify it only in case of possible anomalies during dimming.

Minimum light value	5 %
---------------------	-----

Minimum value that the light can reach in percentage.

It is advised to raise it in case of early shutdowns during dimming or flickering at the minimum value.

Switch time	0"
-------------	----

Time employed to reach the maximum or minimum after a short pulse or a switching command.

Regulation time 1''

Time employed to reach the maximum or minimum after a long pulse or a precise percentage command.

Scene time 1"

Time employed to reach the value required by the scene.

Memory 

When enabled, the dimmer comes back to the value previous to the shutdown following a short pulse or a switching command.

Restore after blackout 

Inactive

When enabled, the dimmer goes back to the value previous to the shutdown following a supply interruption.

TYPE 15.21.8 FUNCTIONS

THE TYPE 15.21.8 IS A 110/230 V AC PHASE CUTTING DIMMER, HENCE IT HAS MANY FUNCTIONS AND PARAMETER AT ITS DISPOSAL, TO ADAPT TO VARIOUS SYSTEM CONDITIONS

Function

- LEDRC1**
(1) LED, Halogen, Electronic transformers - TE - Linear ☒
- LEDRC2
(2) LED, Halogen, Electronic transformers - LE - Linear ☐
- LED3
(3) LED - TE - Exponential ☐
- LED4
(4) LED - LE - Exponential ☐
- CFL1
(5) CFL - TE - Exponential ☐
- CFL2
(6) CFL - LE - Exponential ☐
- L
(7) Electromagnetic transformer - LE - Exponential ☐
- AUTO
(AUTO) AUTOMATIC ☐

Minimum light value 5 %

— +

Minimum value that the light can reach in percentage.
It is advised to raise it in case of early shutdowns during dimming or flickering at the minimum value

Switch time 0''

— +

Time employed to reach the maximum or minimum after a short pulse or a switching command

Regulation time 1''

— +

Time employed to reach the maximum or minimum after a long pulse or a precise percentage command

Scene time 1''

— +

Time employed to reach the value required by the scene

Memory
Inactive

☐

When enabled, the dimmer comes back to the value previous to the shutdown following a short pulse or a switching command

Restore after blackout
Inactive

☐

When enabled, the dimmer goes back to the value previous to the shutdown following a supply interruption

It's possible to set up trailing edge or leading edge functions, based on the type of applied load. If the load is unknown it's possible to use the AUTO function so that the dimmer adapts automatically to it.

The default function is the linear trailing edge for LED (LEDRC1), it is advised to keep it as it is and to modify it only in case of possible anomalies during dimming.

TYPE 15.21.9 FUNCTIONS

THE TYPE 15.21.9 IS A PWM A 12...24 V DC DIMMER, HENCE IT HAS MANY FUNCTIONS AND PARAMETER AT ITS DISPOSAL, TO ADAPT TO VARIOUS SYSTEM CONDITIONS

Add device

15.21 LED
PWM Dimmer for low voltage LED strips

[Discover more](#)

[Technical Datasheet](#)

Function applied to channel

LOW
(LOW) Low frequencies

Minimum light value 5 %

Switch time 0"

Regulation time 1"

Scene time 1"

Memory
Inactive

Restore after blackout
Inactive

Next

Add device

15.21 LED
PWM Dimmer for low voltage LED strips

[Discover more](#)

[Technical Datasheet](#)

Function applied to channel

LOW
(LOW) Low frequencies

Function

LOW
(LOW) Low frequencies

MED
(MED) Medium frequencies

HIGH
(HIGH) High frequencies

It is possible to set the duty cycle frequency of the PWM, that is the number of cycles per second. It is advised to modify this parameter only when the dimming frequency interferes with security cameras, making checking recordings annoying. Raising the frequency lowers the dimmer's performance.

Minimum value that the light can reach in percentage. It is advised to raise it in case of early shutdowns during dimming or flickering at the minimum value

Time employed to reach the maximum or minimum after a short pulse or a switching command

Time employed to reach the maximum or minimum after a long pulse or a precise percentage command

Time employed to reach the value required by the scene

When enabled, the dimmer comes back to the value previous to the shutdown following a short pulse or a switching command

When enabled, the dimmer goes back to the value previous to the shutdown following a supply interruption

TYPE 13.S2 FUNCTIONS

THE TYPE 13.S2 IS THE SPECIALIZED ACTUATOR FOR RUNNING ELECTRIC CURTAINS AND ROLLER BLINDS. THE AVAILABLE FUNCTIONS ARE AS FOLLOWS

13.S2
Actuator suitable for electric roller blinds and shutters

Show useful links ▾

TP function - shutter automation

Opening time 30"
⊖ ⊞

Closing time 30"
⊖ ⊞

Command delay 0"
⊖ ⊞

Next

Time employed by the blind to go from complete shutting to complete opening

Time employed by the blind to go from complete opening to complete shutting

Delay time used by this actuator to wait from the reception of the scene command to its execution.
Use this parameter only in case of centralized commands that involve a high number of particularly powerful motors

KEEP IN MIND

Update the devices afterwards if you wish to manage the opening percentage.

TYPE 1Y.P2 FUNCTIONS

THE TYPE 1Y.P2 IS THE INTERFACE THAT ALLOWS TO TRANSFORM ANY CLEAN OR PHASED CONTACT INTO A BLUETOOTH COMMAND.
IT IS POSSIBLE TO HIGHLIGHT THE DIFFERENT CHANNELS PUSHING THE RELATIVE PHYSICAL BUTTONS.
THE AVAILABLE FUNCTIONS ARE AS FOLLOWS

STANDARD

Used for point to point commands.
Use when the channel commands a single YESLY device

SCENE

Useful for centralized commands.
Always use this one when this channel has to command multiple YESLY device at the same time, as in centralized commands.

Add button

1Y.P2
Input interface

Show useful links ▾

Buttons' configuration

If you want to control scenarios and centralized functions, is needed to select the scenario mode on the Input Interface.

Press your device's buttons to highlight the corresponding box

Button 1

Standard ☒ Scenario

+ Add action

Button 2

Standard ☒ Scenario

+ Add action

Next

From here it is possible to quickly select the device or command that this channel needs to command.

WIRELESS BUTTONS FUNCTIONS

THE BEYON AND TYPE 013.B9 ARE WIRELESS PUSH-BUTTONS WITH NO BATTERIES REQUIRED. THEY ARE SET UP IN A VERY SIMILAR WAY, AND IT'S POSSIBLE TO HIGHLIGHT THE DIFFERENT CHANNELS PRESSING THE RELATIVE PHYSICAL BUTTONS

The image displays four sequential screenshots of a mobile application interface for configuring wireless buttons. Each screen is titled 'Add button' and shows a specific device model and its button count. Below the device information, there is a section titled 'Buttons' configuration' with instructions: 'Press your device's buttons to highlight the corresponding box'. Each button is represented by a box with an 'Add action' button. The devices shown are Beyon 2 (2 buttons), Beyon 4 (4 buttons), 013B9 2 (2 buttons), and 013B9 4 (4 buttons). A blue arrow points from the 'Next' button of the Beyon 4 screen to the text below.

Beyon 2
Beyon - 2 buttons

Buttons' configuration
Press your device's buttons to highlight the corresponding box

Button 1
+ Add action

Button 2
+ Add action

Next

Beyon 4
Beyon - 4 buttons

Buttons' configuration
Press your device's buttons to highlight the corresponding box

Button 1
+ Add action

Button 2
+ Add action

Button 3
+ Add action

Button 4
+ Add action

Next

013B9 2
013B9 - 2 buttons

Buttons' configuration
Press your device's buttons to highlight the corresponding box

Button 1
+ Add action

Button 2
+ Add action

Next

013B9 4
013B9 - 4 buttons

Buttons' configuration
Press your device's buttons to highlight the corresponding box

Button 1
+ Add action

Button 2
+ Add action

Button 3
+ Add action

Button 4
+ Add action

Next

From here it is possible to quickly select the device or command that this channel needs to command.

SCENE CREATION

SCENES ARE CENTRALIZED COMMANDS MADE TO RECALL A DEFINED CONDITION LIKE FOR EXAMPLE “I’M GOING OUT” WITH ALL THE LIGHTS OFF AND THE BLINDS DOWN

01

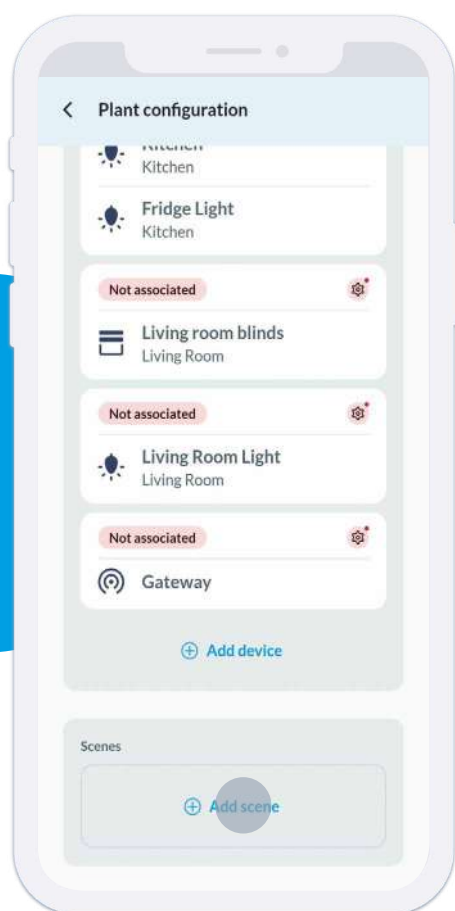

Once all the devices that compose the system are entered, select “Add scene”.

Name the scene, possibly select an icon, and input the name of the room in which it will be added (or no room at all). These parameters are purely graphical. Select “Next” to continue.

02

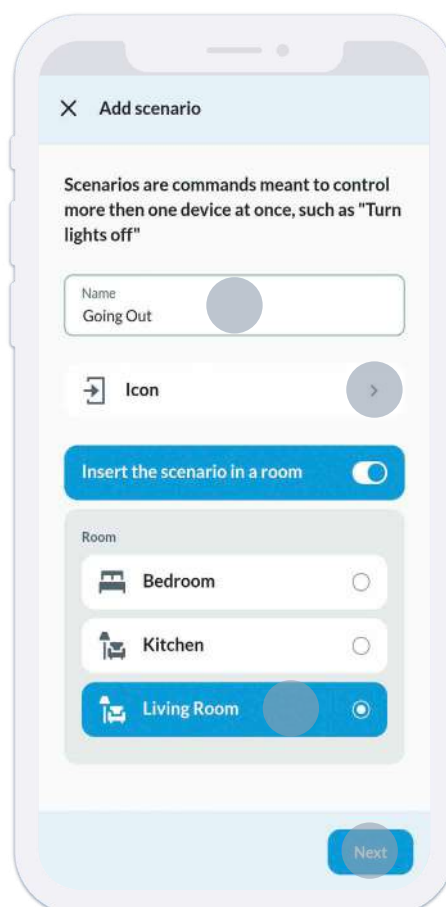

03

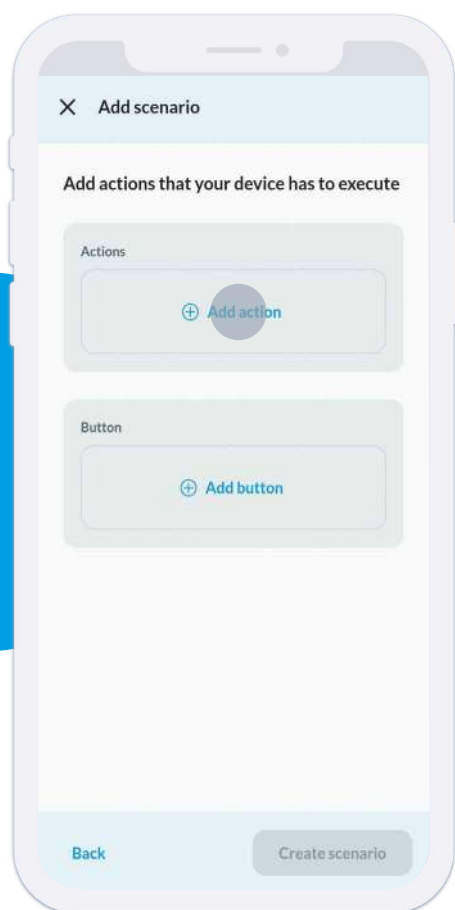

Select **"Add action"** to choose the devices that will be included in the scene.

Choose the type of device you want to add, for example **"Lights and dimmers"**. Select **"Next"** to continue.

KEEP IN MIND

Multichannel functions are relative to the channel used **"together"** on Types 13.72 or 13.22 (see pertinent section).

04

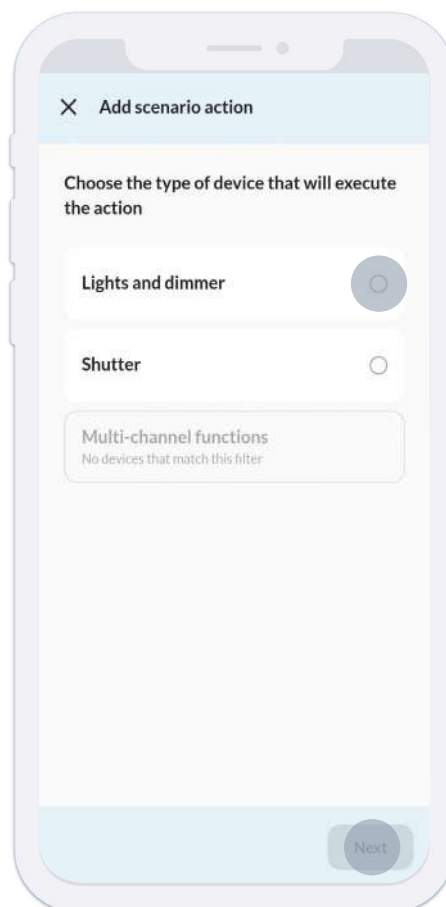

05

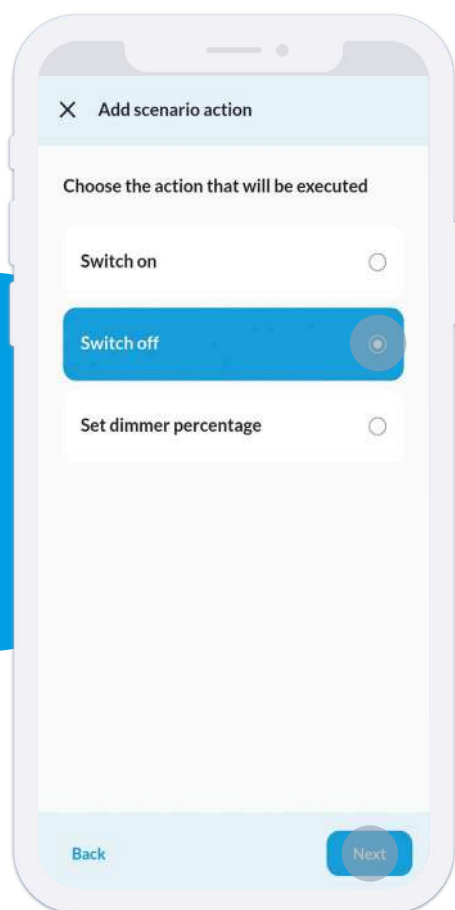

Choose the action that those lights need to execute when the scene gets recalled, for example **“Switch off”**.
Select **“Next”** to continue.

Select all the lights that are getting involved in the scene.
Select **“Apply”** to continue.

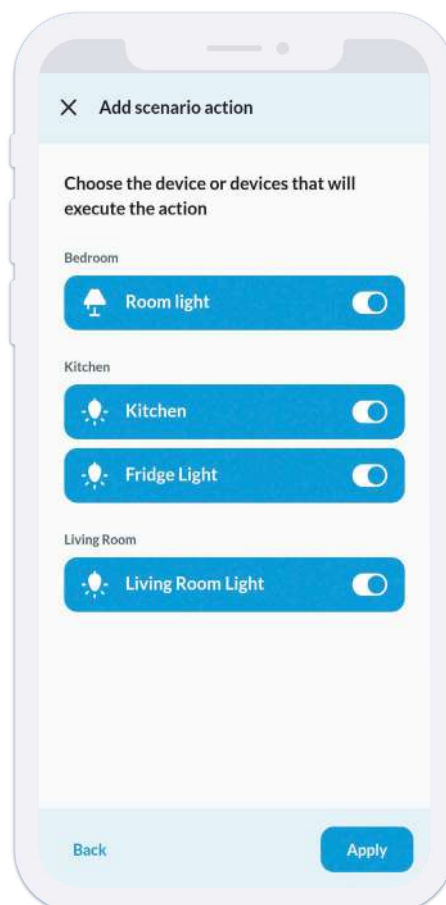

06

07

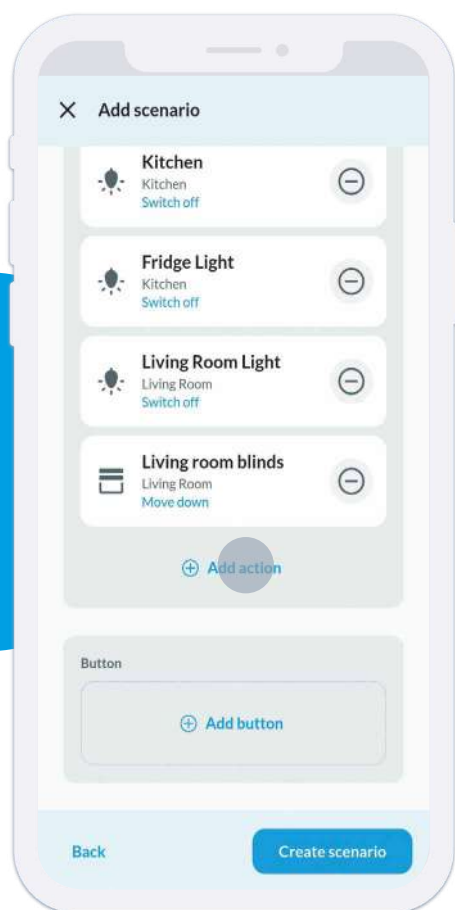

At this point the scene could already be completed, but if roller blinds need to be involved as well, select “**Add action**”.

Select “**Shutter**”, then “**Close**”.
Afterwards, select all the shutters that need to be involved.
Select “**Apply**” to continue.

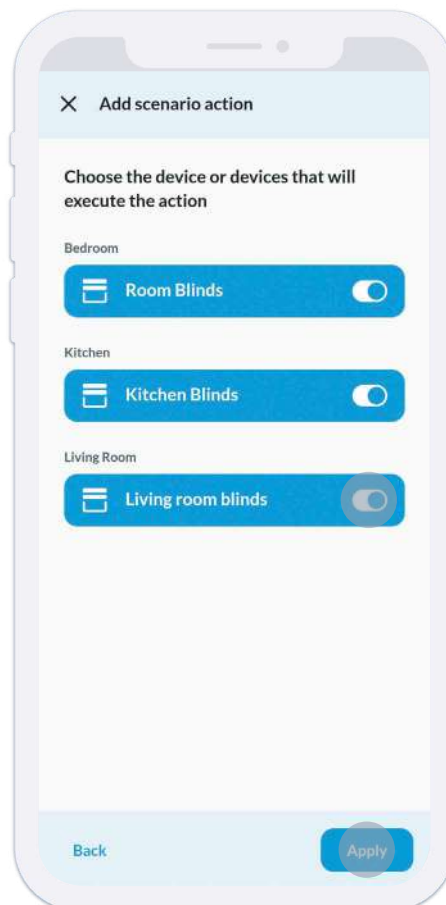

08

09

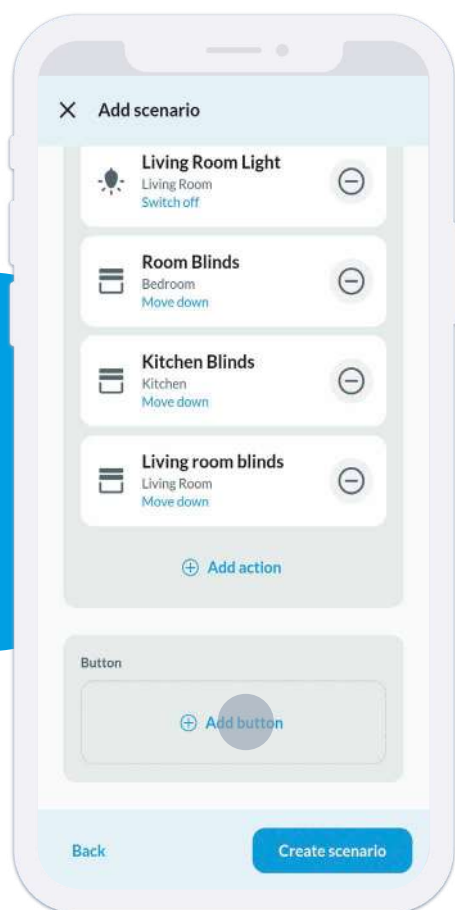

At this point the scene could already be completed, but if it's necessary to use a physical command to recall it, select **"Add button"**.

Select the previously added button.
Select **"Next"** to continue.

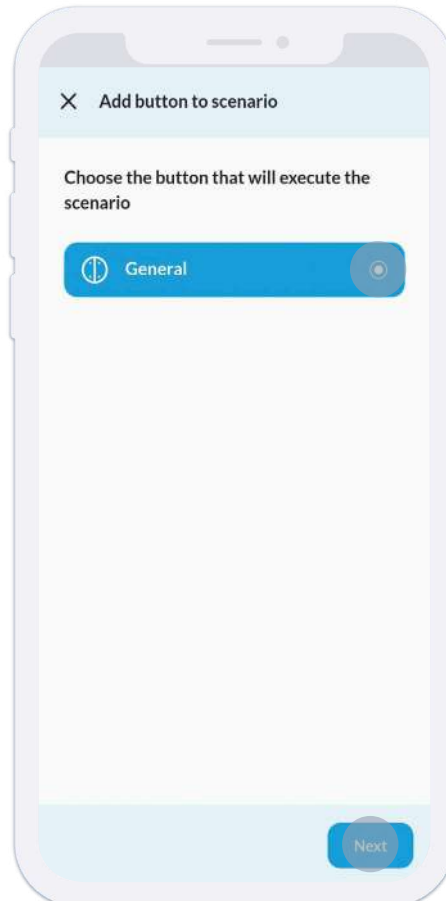

10

11

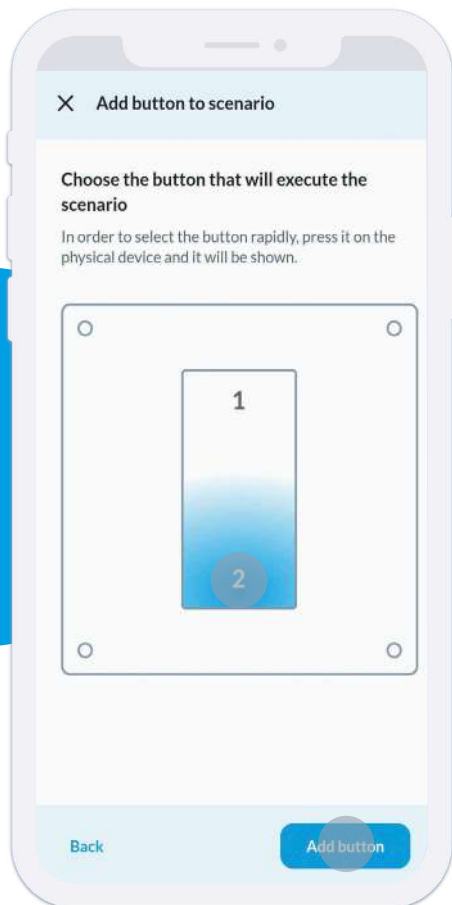

Select the desired button channel.
If unknown, press on the button itself
to graphically highlight it.
Select **"Add button"** to continue.

Select **"Create scenario"** to complete the process.

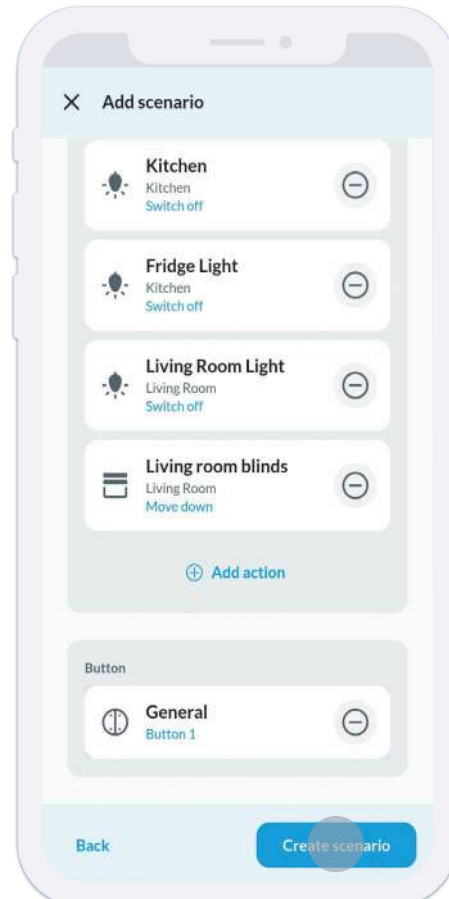

12

CONFIGURATION APPLICATION

ONCE ALL THE DEVICES AND THE SCENES ARE ADDED YOU CAN PROCEED WITH THE CONFIGURATION OF ALL THE DEVICES. THE DEVICES NEED TO BE CORRECTLY POWERED.

ONCE THE ASSOCIATION PROCESS IS DONE, MODIFICATIONS OF THE CONFIGURATIONS CAN BE APPLIED WITHOUT PHYSICALLY MANIPULATING THE DEVICES BUT PRESENCE WITHIN THE BLUETOOTH RANGE IS STILL NECESSARY.

EACH DEVICE CATEGORY HAS ITS OWN APPLICATION MODE FOR THE CONFIGURATION.

IT IS ADVISED TO PERFORM THE ASSOCIATION TOP TO BOTTOM FOLLOWING HOW THE DEVICES ARE VISUALIZED IN THE “CONFIGURATIONS YET TO APPLY” SCREEN.

ENTER THE “SYSTEM SETTINGS” SECTION AND CLICK ON THE BANNER.

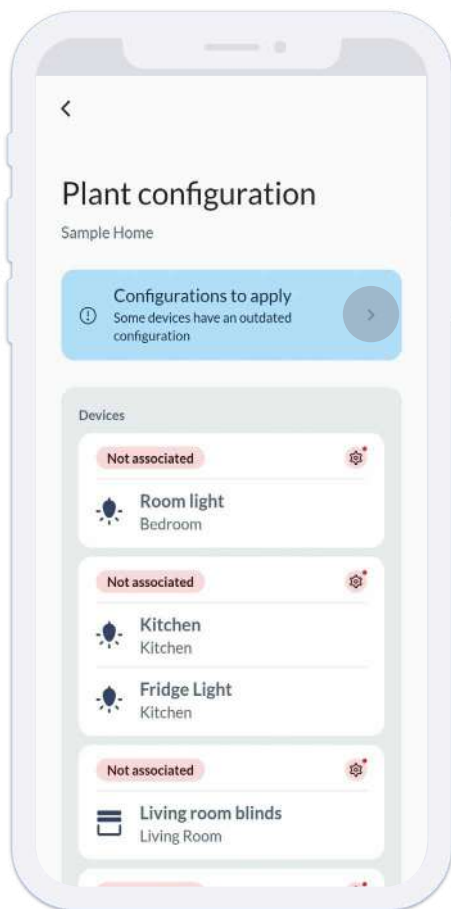

Once all the devices are added and all the scenes are created, select “**Configurations to apply**”.

KEEP IN MIND

To apply the configuration, the devices have to be correctly powered and it's necessary being within their bluetooth range.

CONFIGURATION APPLICATION ON ACTUATORS AND DIMMERS

THE FOLLOWING TYPES ARE INTENDED AS ACTUATORS AND DIMMERS:

13.72, 13.22, 13.21-B, 15.71, 15.21.8, 15.21.9 AND 13.S2

01

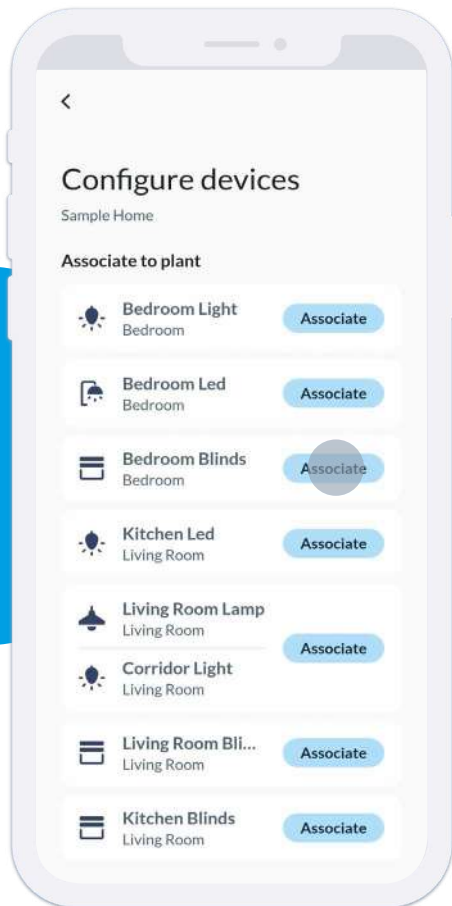

Select "Associate" to start the first device pairing.

Select "Start Pairing" to continue.

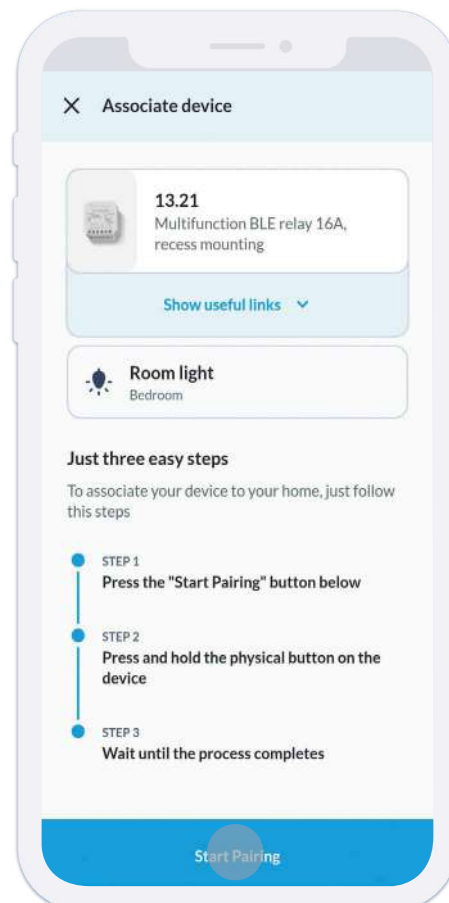

03

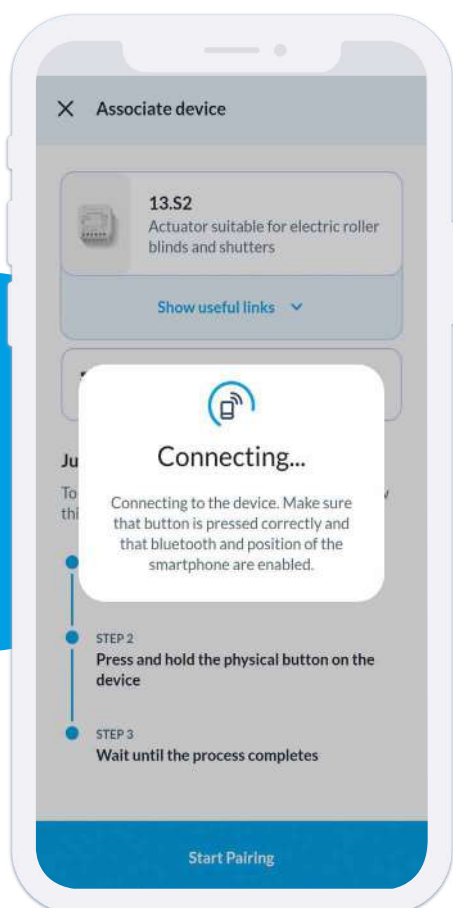

Keep the physical button on the device pressed (either P1 or P2) or bring and maintain voltage on the terminal; by other means (keeping safety as a priority).

Release the button or remove the voltage from P1 or P2 terminal when requested to do so. The device will then be correctly paired and configured.

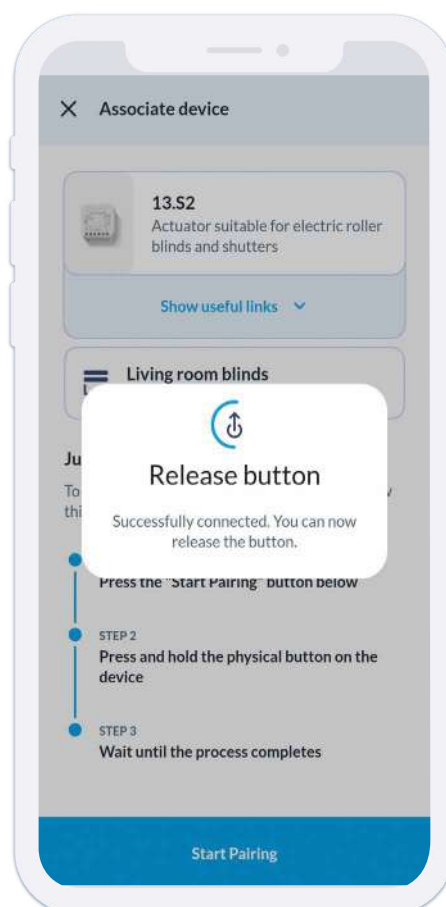

04

CONFIGURATION APPLICATION ON INPUT INTERFACES TYPE 1Y.P2

01

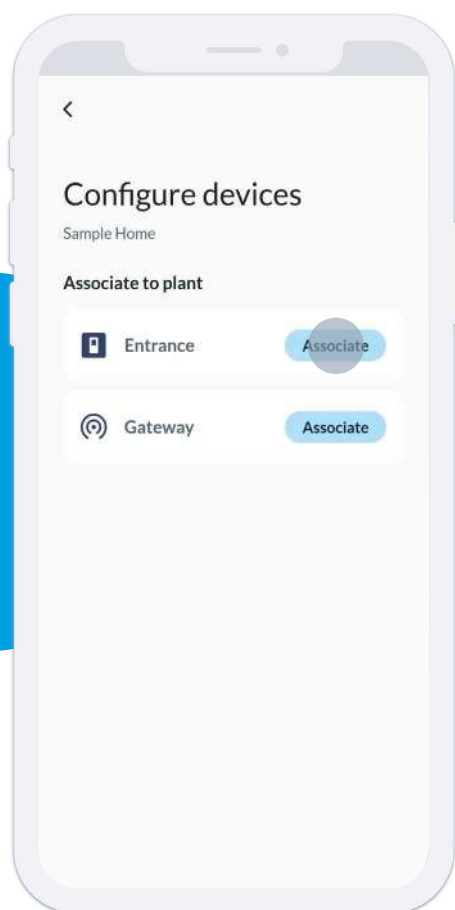

Once all dimmers and actuators are paired, select **“Associate”**.

Select the input interface that you wish to pair.
If more than one are present, press on the physical button wired to the interface to highlight it.

02

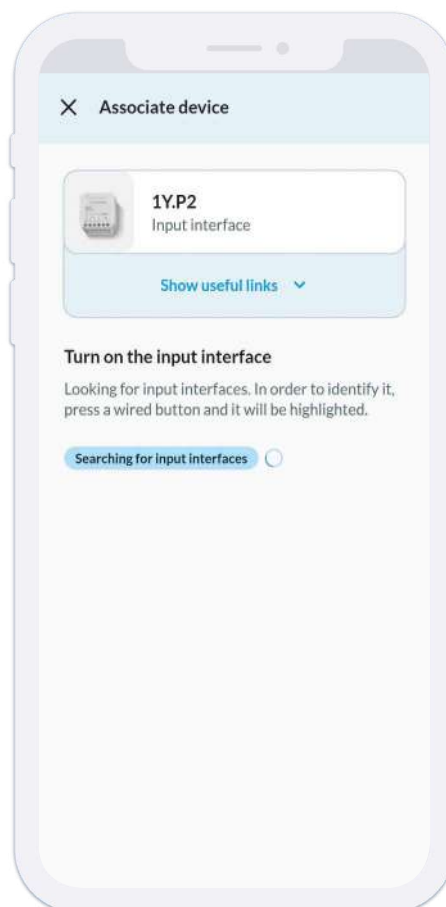

03

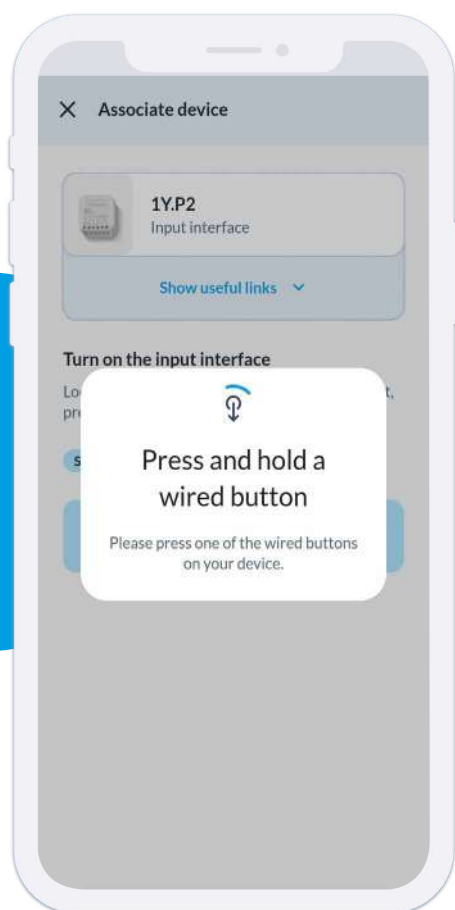

Once the desired input interface is selected, keep the physical button on the device pressed (either P1 or P2) or bring and maintain voltage on the terminal by other means (keeping safety as a priority).

Release the button or remove the voltage from P1 or P2 terminal when requested to do so. The interface will then be correctly paired and configured.

04

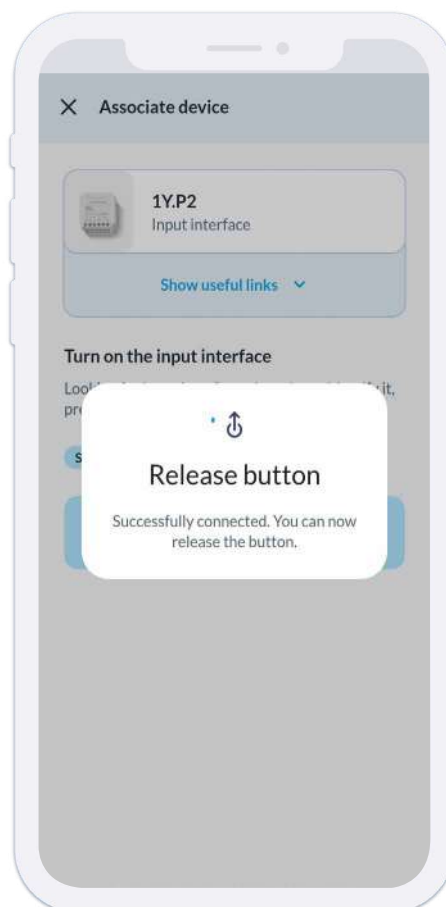

CONFIGURATION APPLICATION ON GATEWAYS TYPE 1Y.GU

01

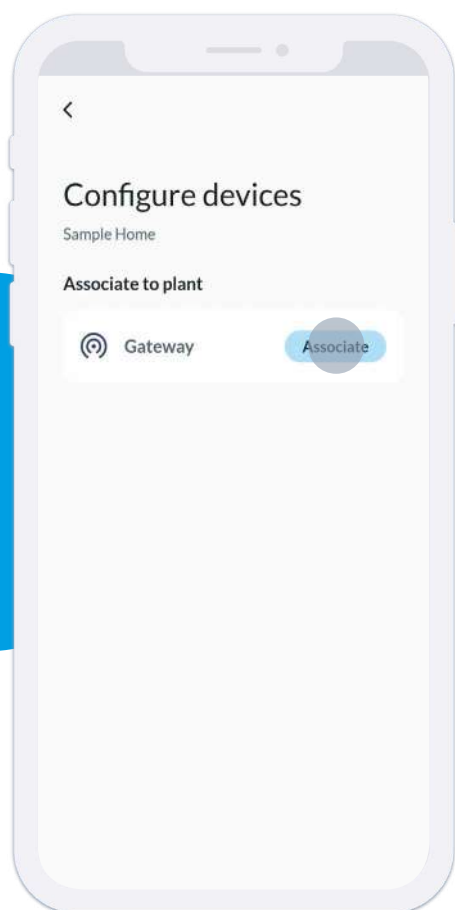

Once all the other devices are paired and only then, select **“Associate”**.

Select the gateway that you wish to associate. If more than one would be in range, press the physical button at the base of the gateway to highlight it.

02

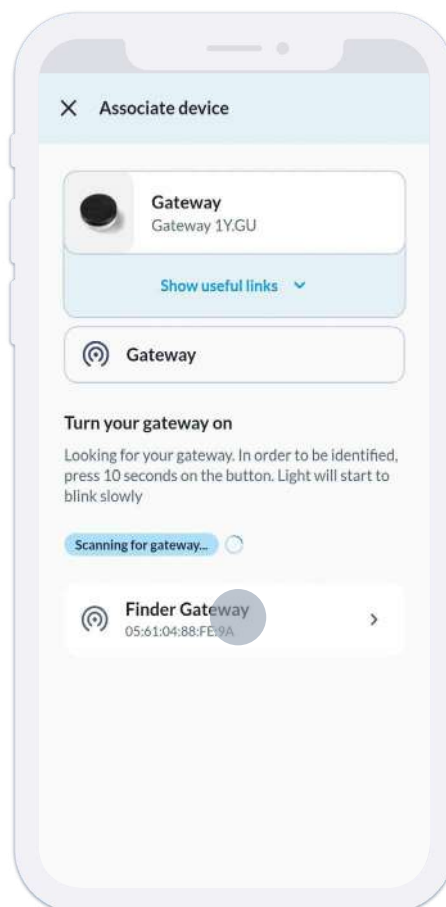

03

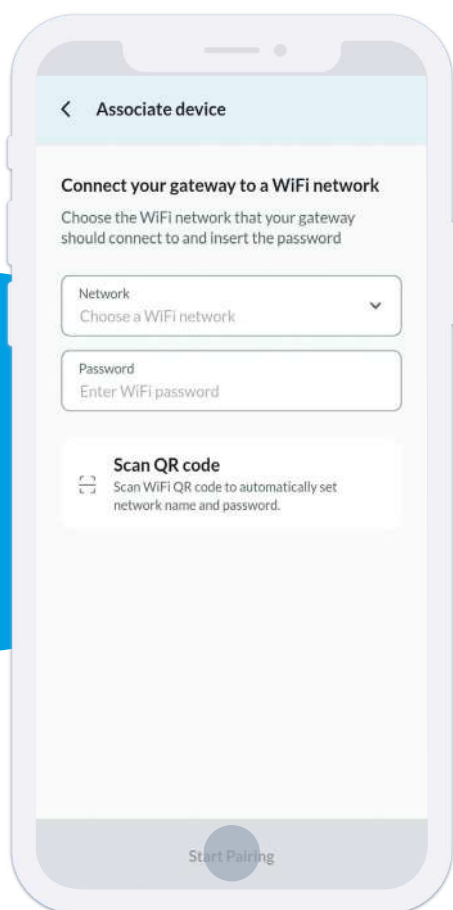

Enter the Wi-Fi credentials scan the QR code on the router.
Afterwards, select **“Start association”**.

Wait for the completion of the process and for the gateway to restart.
This may take a few minutes.

04

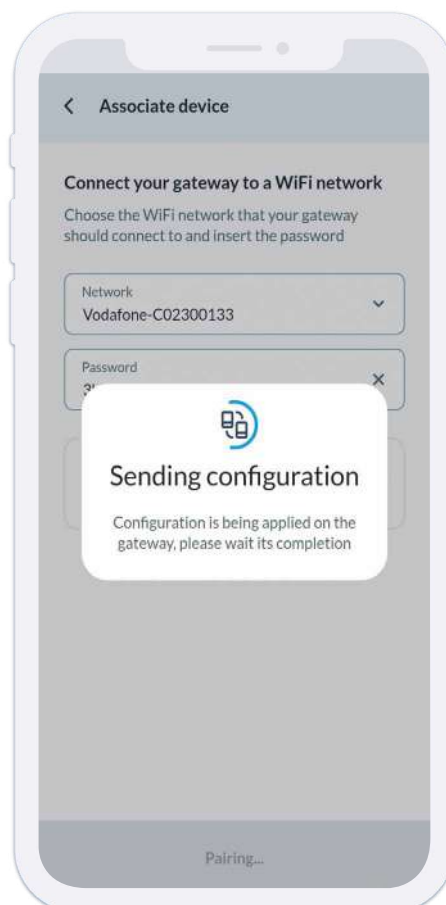

CONFIGURATION APPLICATION ON WIRELESS BUTTONS

BEYON E TYPE 013.B9

01

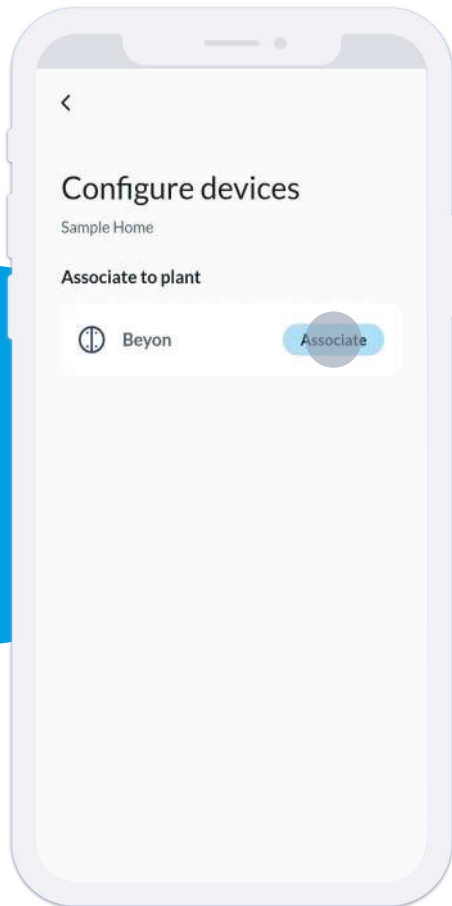

Select "Associate".

KEEP IN MIND

Perform this step before pairing before pairing actuators and dimmers that will be controlled by the wireless button.

Select "Start Pairing".

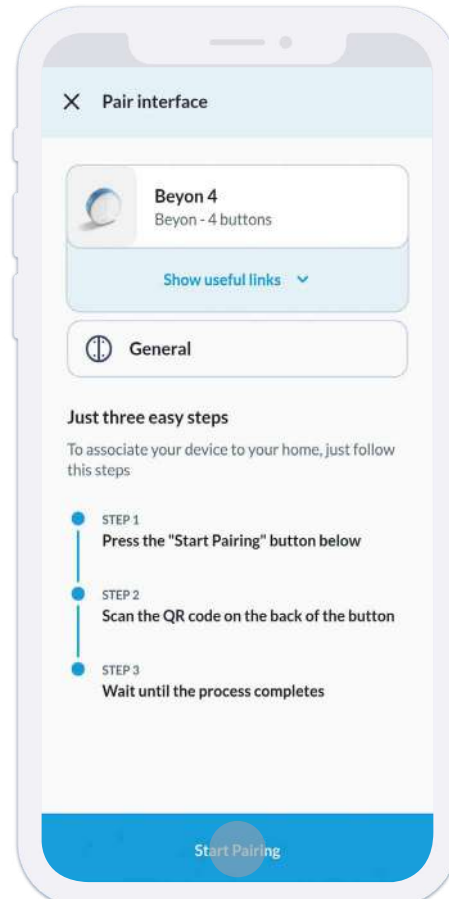

02

03



SCAN THE QR CODE ON THE BACK OF THE WIRELESS BUTTON

BLISS DEVICES

THE BLISS DEVICES ARE THE SMART THERMOSTATS PART OF THE SMART HOME OFFERING BY FINDER.
THE CATALOGUE OFFERS TWO VERSIONS

BLISS WI-FI (TYPE 1C.91)



- DOESN'T NEED A GATEWAY
- BATTERY LIFE: ONE SEASON
- 4x AA BATTERIES
- PERIODIC CONNECTION (5-30 MIN)
- NO HUMIDITY SENSOR
- NO REMOTE ACTUATORS
- THE DISPLAY SHUTS DOWN EVEN WHEN POWERED

BLISS2 (TYPE 1C.B1)



- NEEDS A GATEWAY
- BATTERY LIFE: ONE YEAR AND A HALF
- 3x AAA BATTERIES
- INSTANT CONNECTION
- HUMIDITY SENSOR
- POSSIBILITY TO USE REMOTE ACTUATORS
- THE DISPLAY IS ALWAYS ON IF THE UNIT IS POWERED

THERMOSTAT ASSOCIATION

BLISS WI-FI ASSOCIATION (TYPE 1C.91)

01

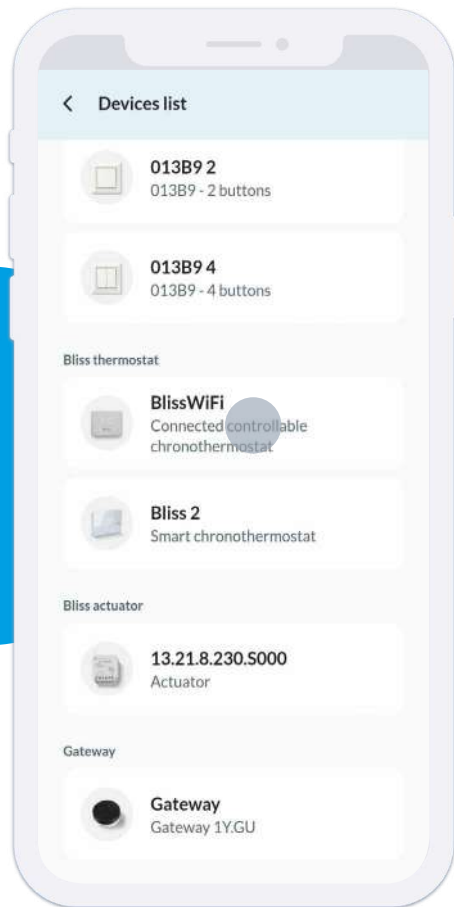

After having selecting “Add device”, scroll down and select “Bliss Wi-Fi”.

Name the thermostat and select a room.
Select “Next” to continue.

02

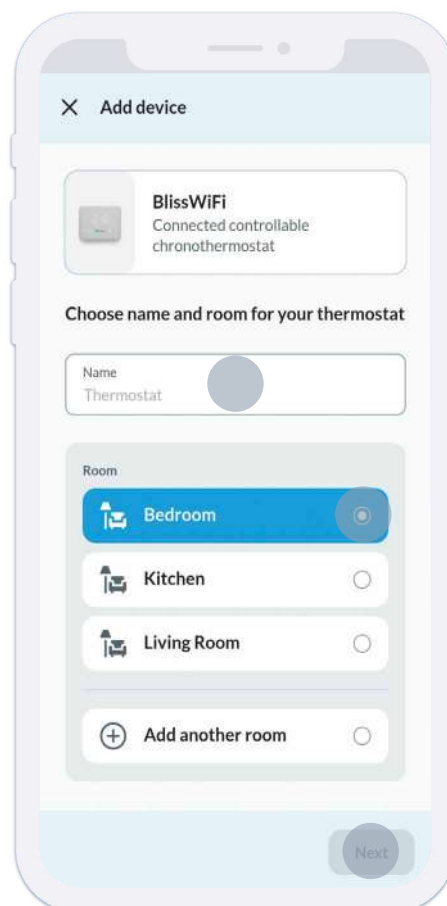

03

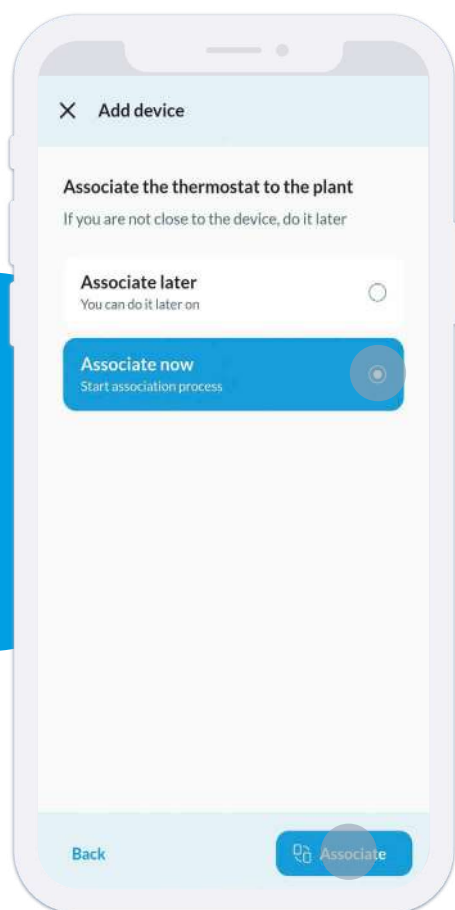

Select **“Associate now”**
(optionally you can associate it later on).
Select **“Associate”** to proceed.

Carefully follow the instructions:

- Set the Bliss Wi-Fi in pairing mode (see procedure in the next page)
- Go to the smartphone's Wi-Fi settings and connect to the **“Bliss-Finder”** network (cancel any attempt by the phone to get back to the main network)
- Select **“Start pairing”**

04

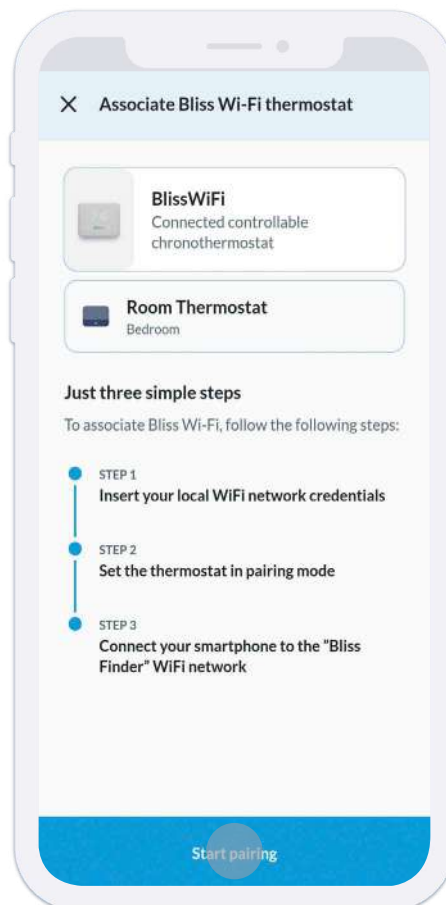

05

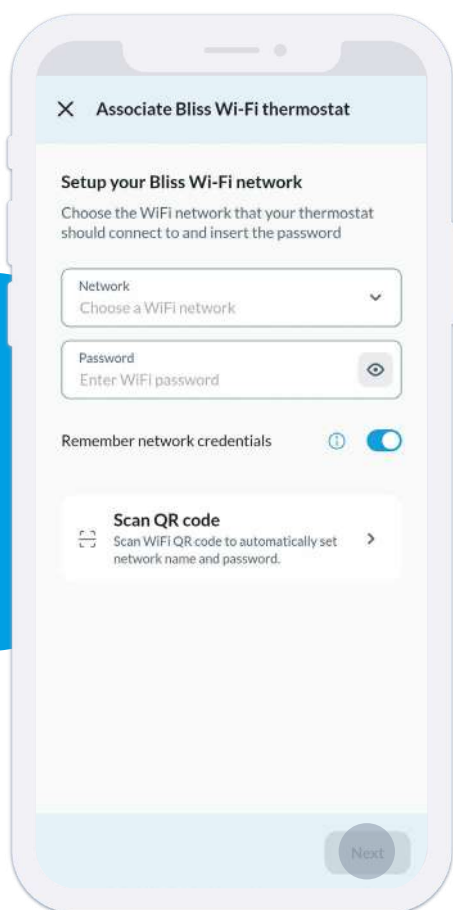

Enter your network credentials or scan the QR code located on your router. Then select **"Next"**.

NOTE

Pay VERY close attention to the correctness of the credentials because if they are incorrect the flow is not blocked, but a generic error will appear at the end of the procedure.

Follow the procedure proposed on the page next one.

06

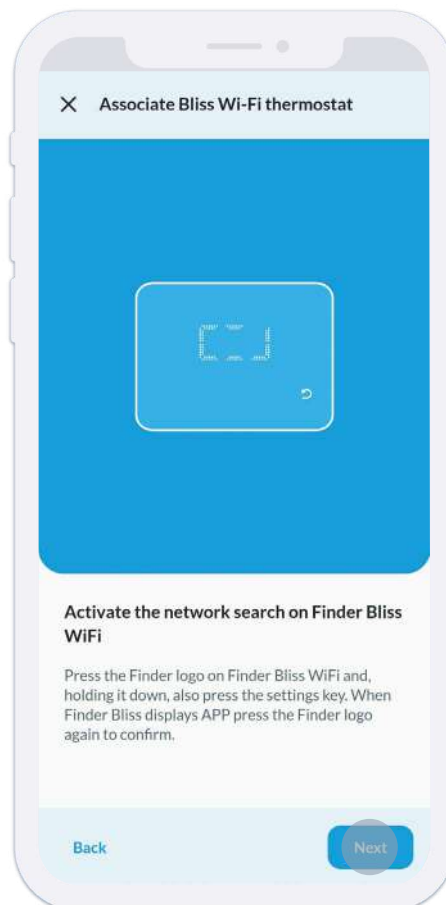

PROCEDURE TO ENTER BLISS WI-FI'S ASSOCIATION MODE

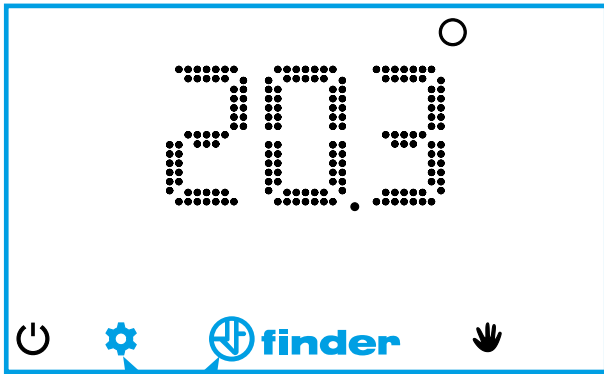

From the thermostat's home screen, keep the "Finder" button pressed, then press on the settings button.

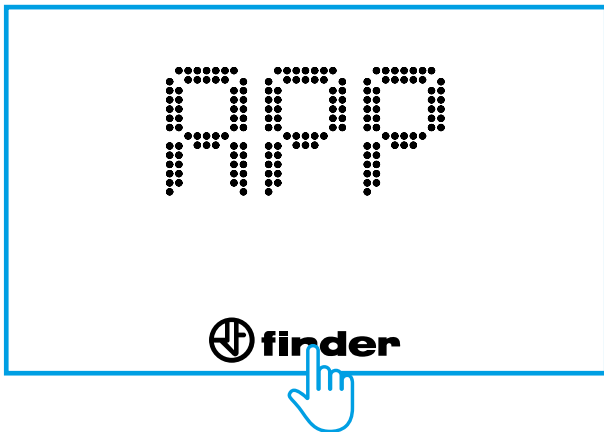

When "APP" comes up, press the "Finder" button again.

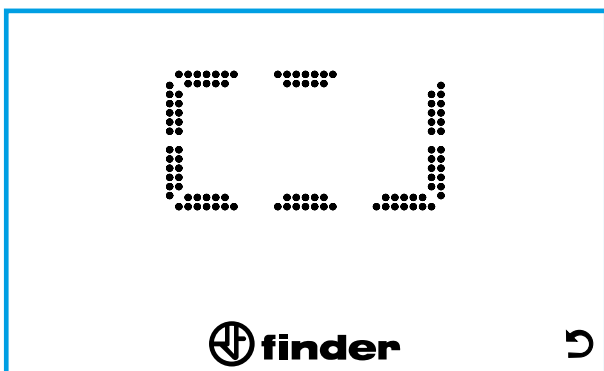

Now the segments rotate clockwise.
From now on the "Bliss-Finder" network appears on the available Wi-Fi networks list.

07

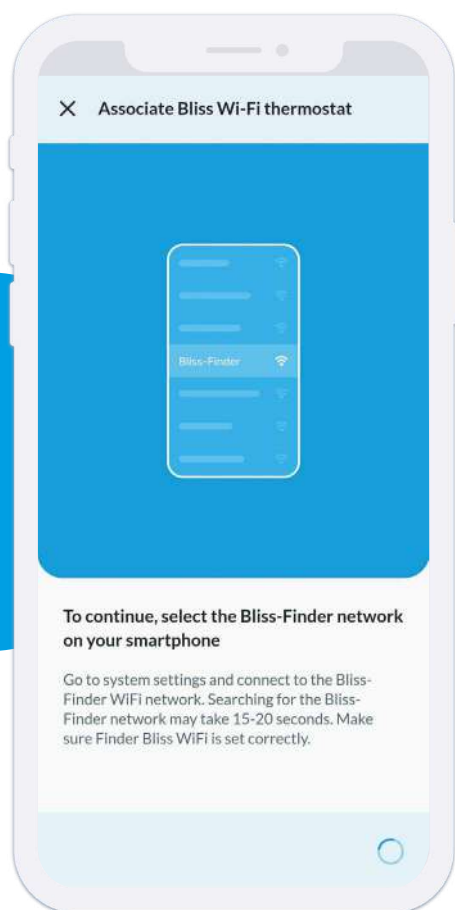

Once successfully connected to the “Bliss-Finder” network, go back to the YOU app.

When you see the following screen, your Bliss Wi-Fi has been successfully paired. Select “Finish” to end.

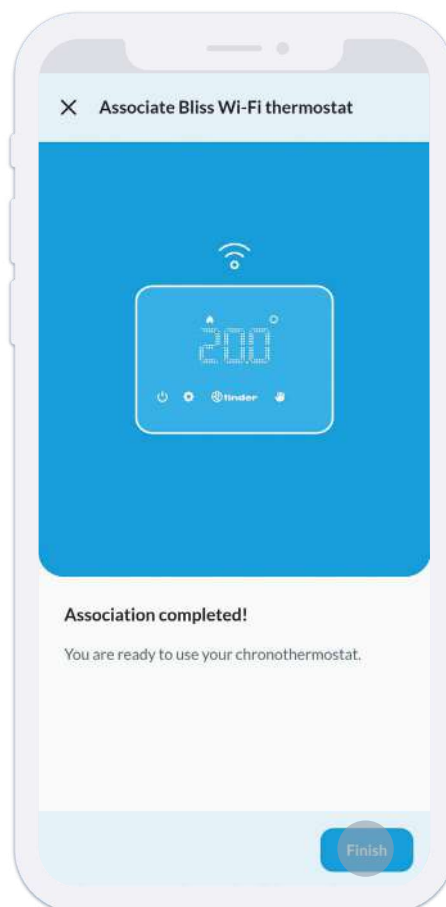

08

BLISS2 ASSOCIATION (TYPE 1C.B1)

01

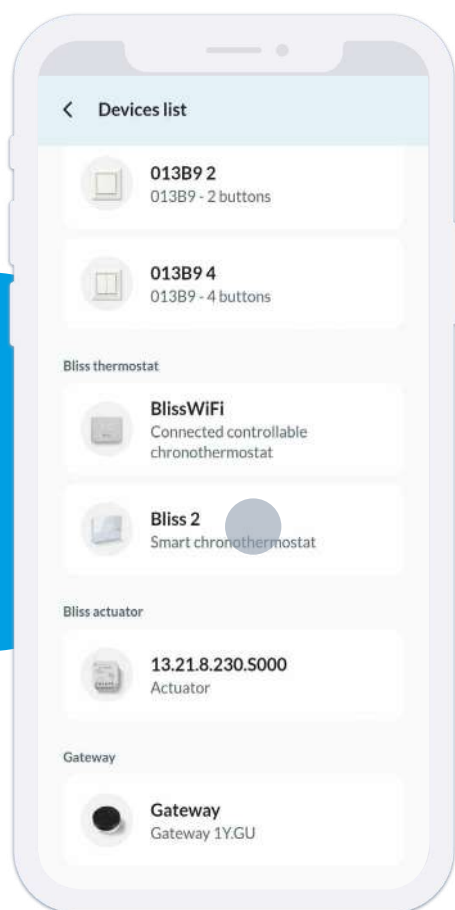

After having clicked on “Add device”, scroll down and select “Bliss 2”.

Name the thermostat and select a room.
Select “Next” to continue.

02

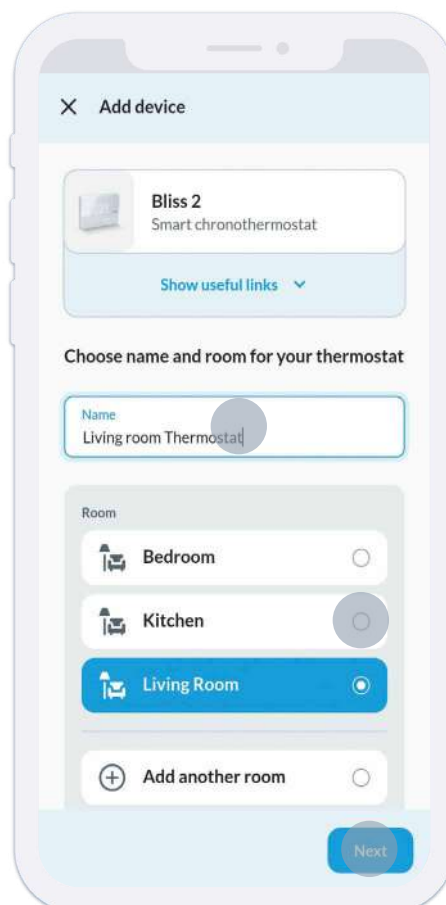

03

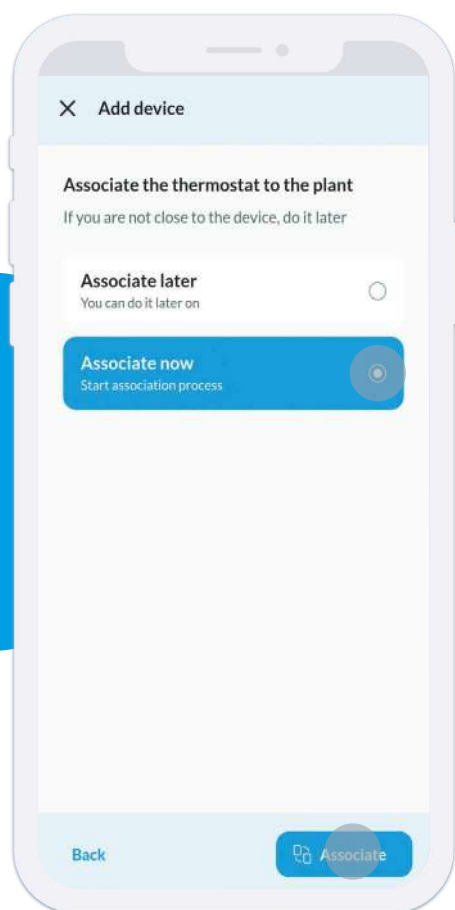

Select the gateway to which you wish to associate the thermostat to. If no gateway is present, follow the steps for the gateway association in this manual. Select **"Next"** to continue.

Select **"Associate now"** (optionally you can associate it later on). Select **"Associate"** to proceed.

04

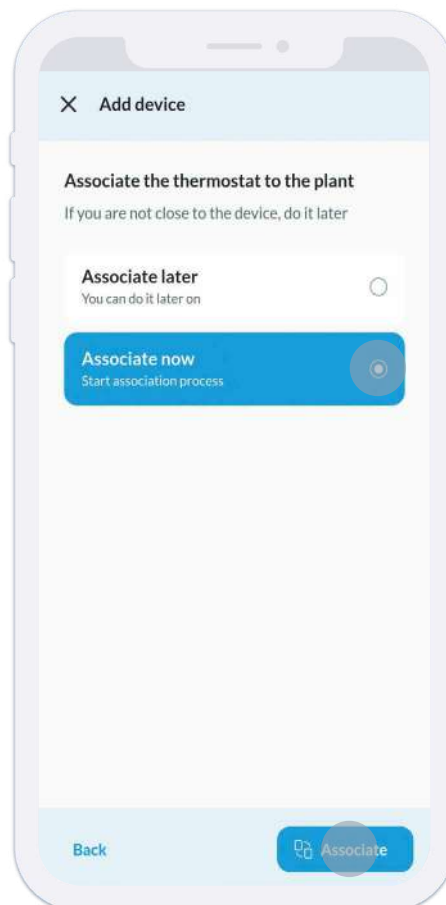

05

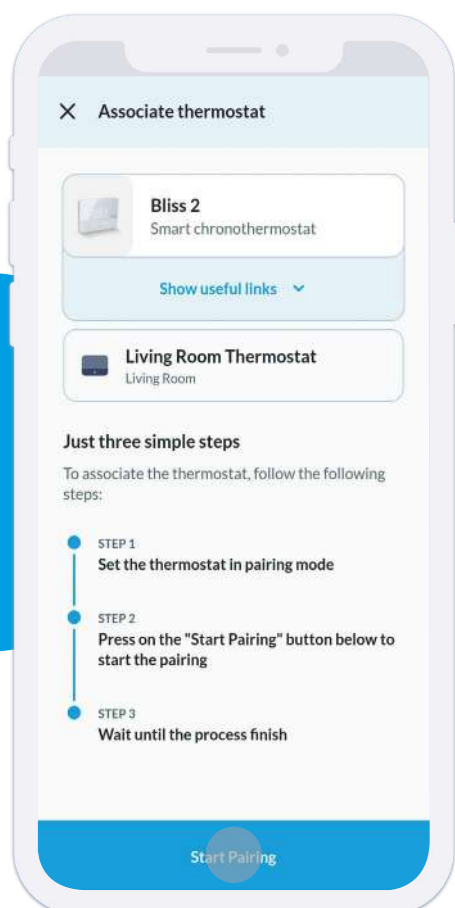

Carefully follow the instructions:

- Set the Bliss2 to pairing mode (see procedure in the next page)
- Select **"Start pairing"**
- Wait for completion

Procedure to enter Bliss2's association mode:

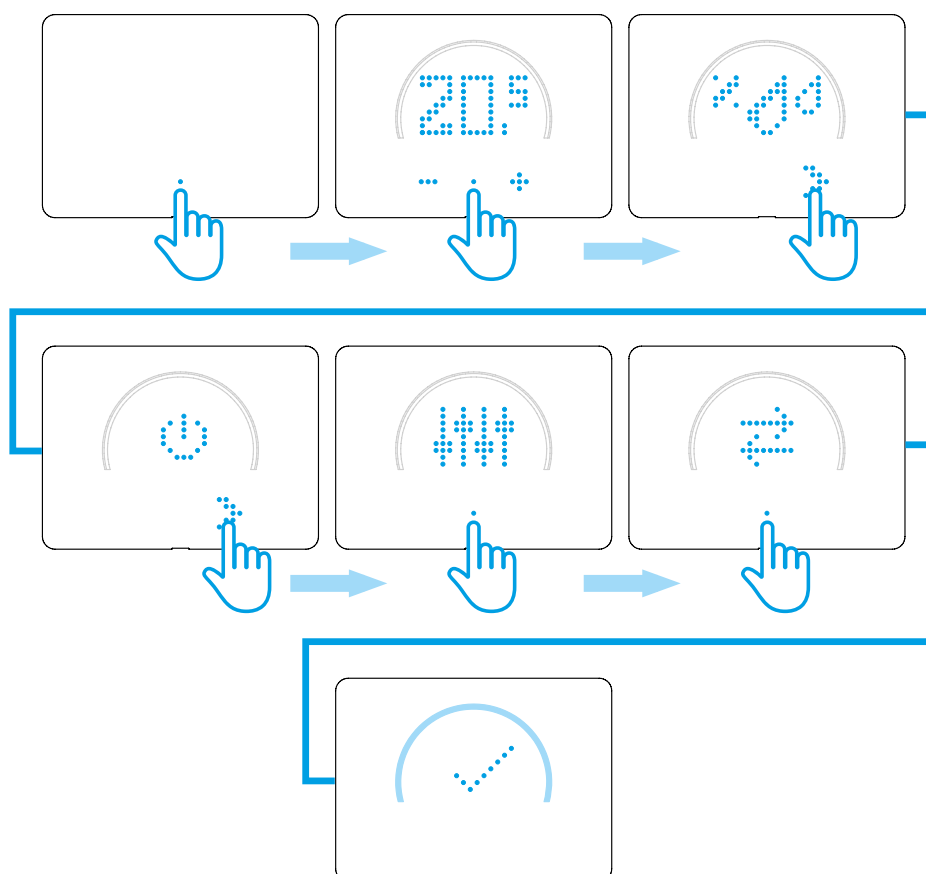

06

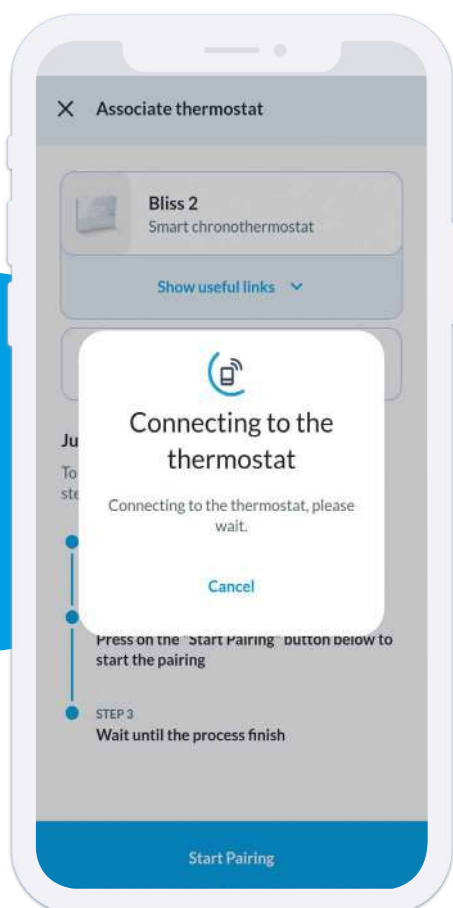

Wait for completion of the procedure.
This step may take a few minutes.

When the following screen comes up, the Bliss2 has been correctly associated.

Select **"OK"** to finish.

Keep in mind: after association check for gateway firmware updates in the advanced settings section.

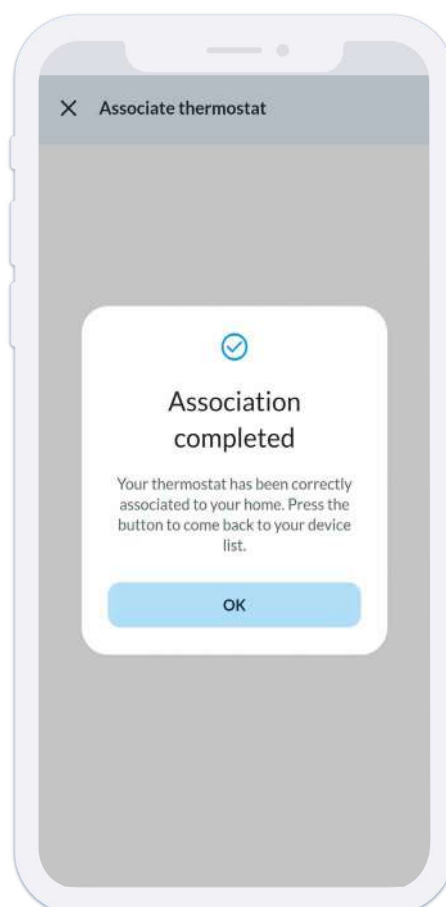

07

RADIO-FREQUENCY ACTUATOR ASSOCIATION (TYPE 13.21-S)

01

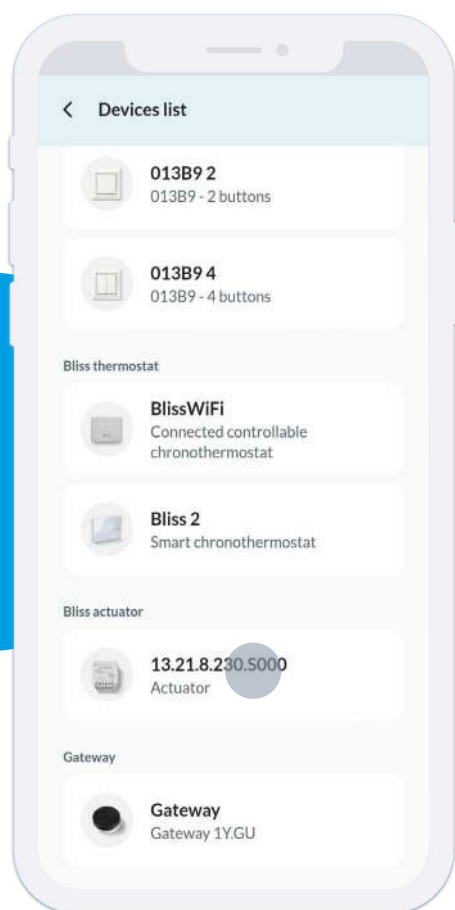

After pressing “Add devices”, scroll down and select “13.21-S”.

Name the device and select a room.
Select the desired function.

02

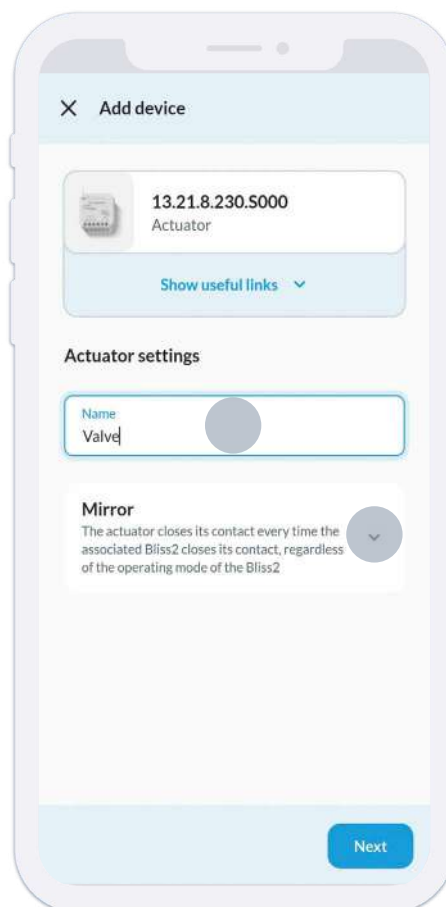

03

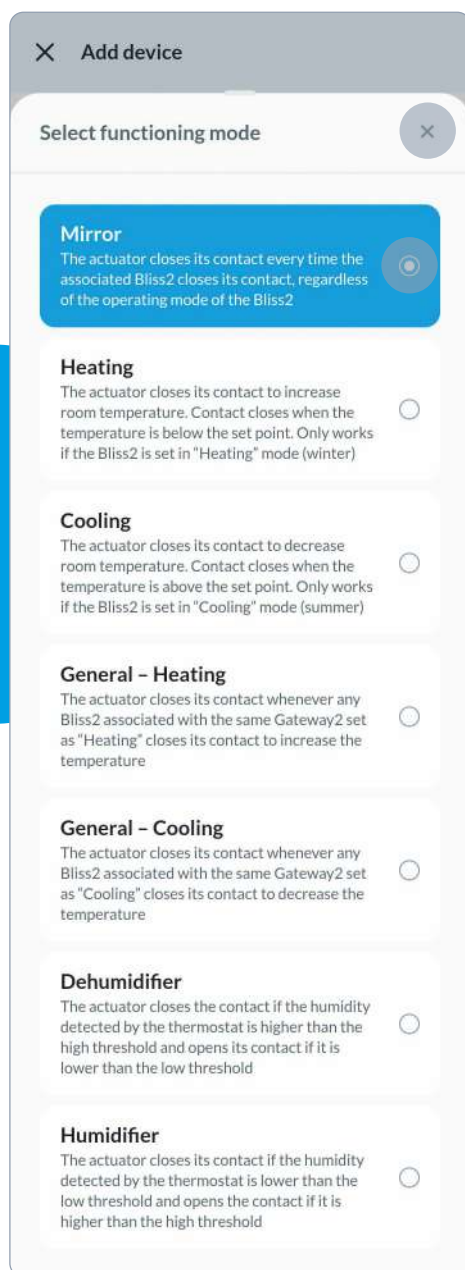

Select the Bliss2 which you wish to pair the thermostat to (or the gateway in case a general function is selected).
Select **"Next"** to continue.

Select the desired function based on the system conditions.
For more information press **"More info"** and select the complete manual.

04

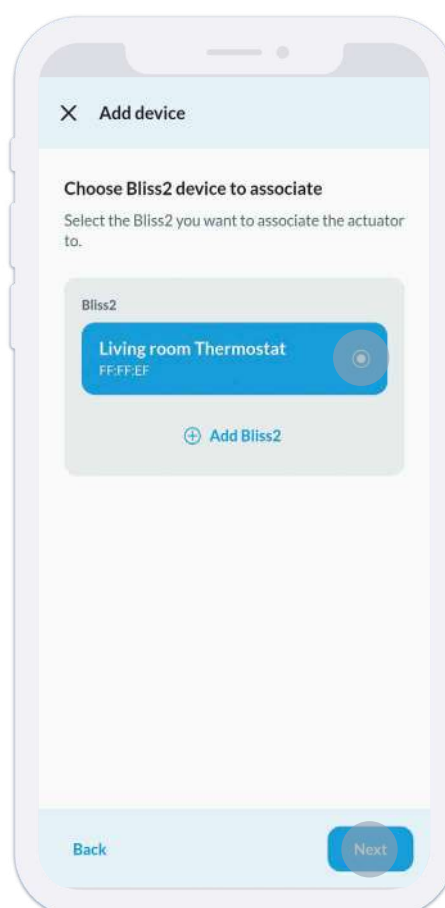

05

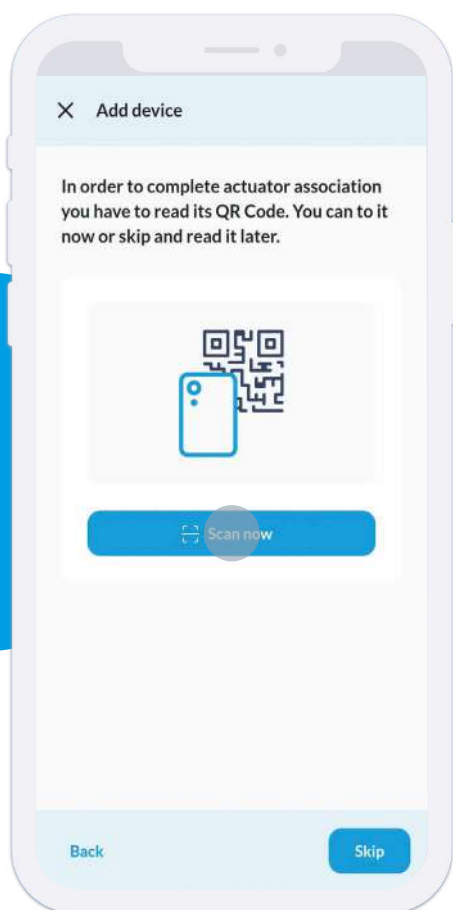

Select **“Scan now”** and scan the QR code on the back of the Type 13.21-S.
Optionally this operation can be executed later on.

Select **“Associate now”**
(optionally you can associate it later on).
Select **“Associate”** to proceed.

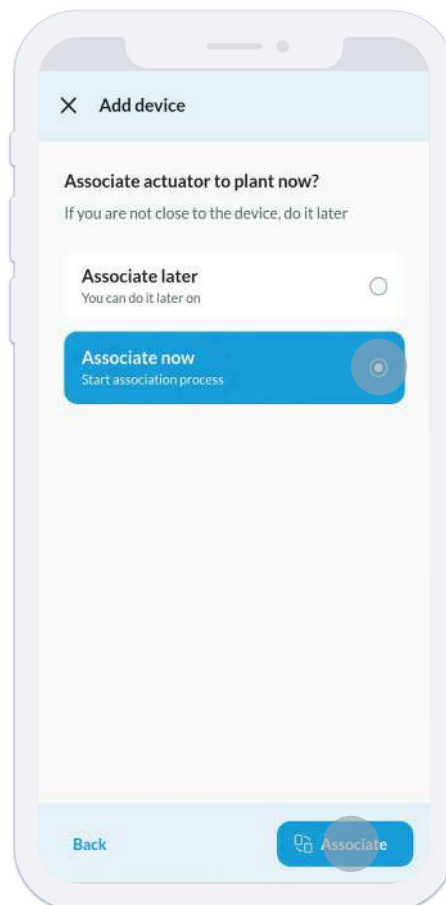

06

07

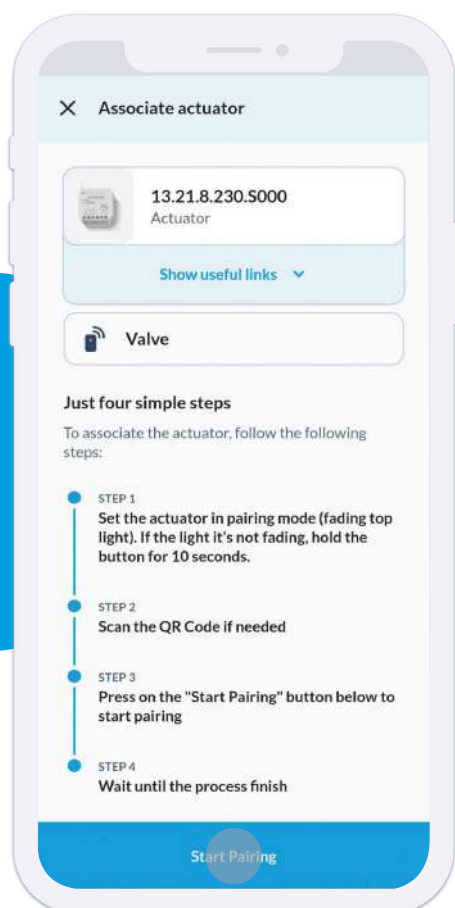

If no step has been skipped, select **“Start pairing”**, otherwise follow the reported instructions. Once you select **“Start pairing”**, wait up.

KEEP IN MIND

Check if the actuator’s LED is blinking slowly. If that isn’t the case, press the physical button on the actuator for 10 seconds with a clip until the LED start blinking fast.

When the following screen is shown, the Type 13.21-S has been correctly associated. Select **“OK”** to finish.

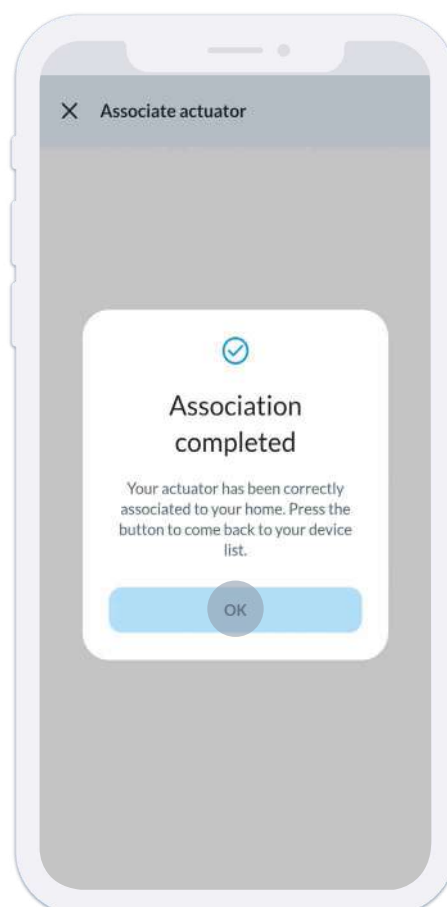

08

FUNCTIONS OF THE BLISS THERMOSTATS

GENERAL FUNCTIONS (Functions common to all thermostats)

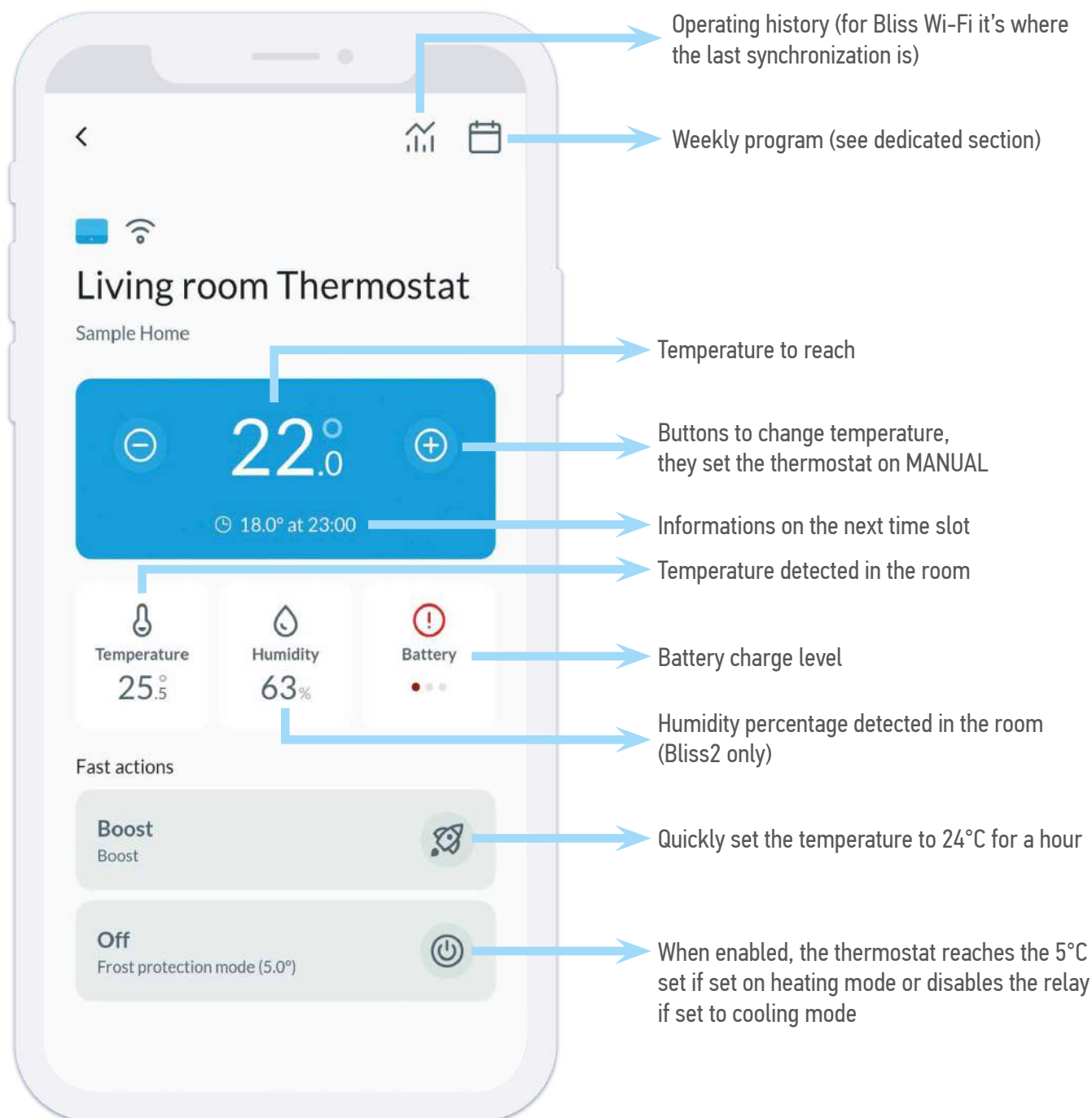

Normally the BLISS thermostats follow set time slots, being chronothermostats

MANUAL SETTING

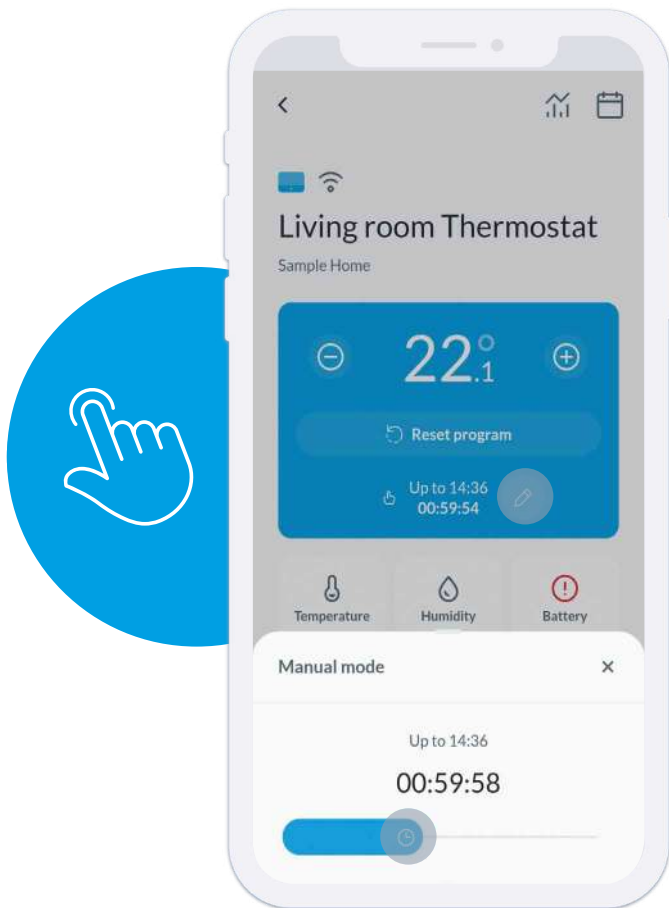

When you press + or – from the thermostat home screen, the desired temperature is maintained for a hour.

To change this parameter you can press **“Modify”** and select the time to keep the manually set temperature scrolling the slider.

In case you wish to keep the set temperature indefinitely you just need to scroll the slider to the right edge to remove the timing.

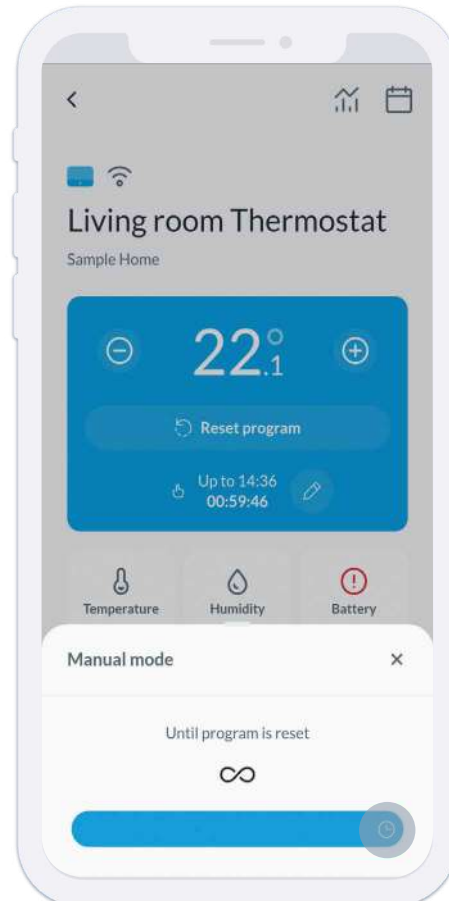

WEEKLY PROGRAMMING

THE WEEKLY PROGRAMMING IS THE SEQUENCE OF TIME SLOTS THAT THE THERMOSTAT FOLLOWS UNDER NORMAL CIRCUMSTANCES (AUTO SETTING)

01

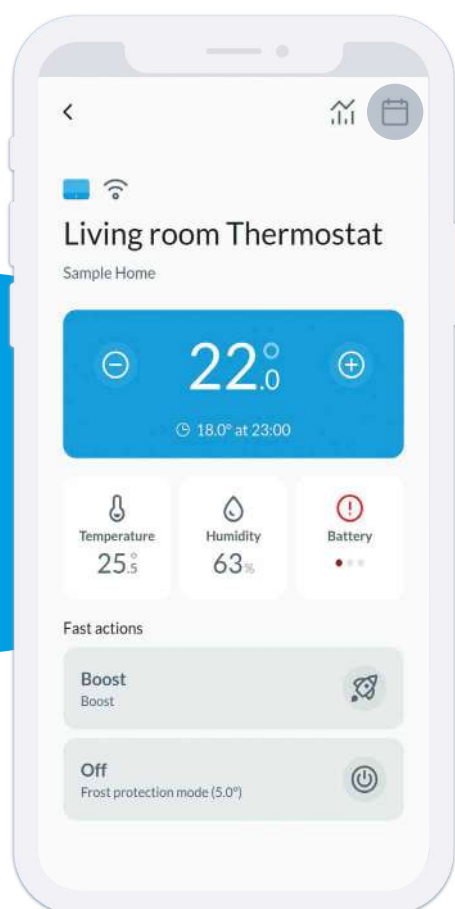

From the thermostat main screen, select the calendar icon.

Shown here is the default configuration. Select a time slot to modify it.

02

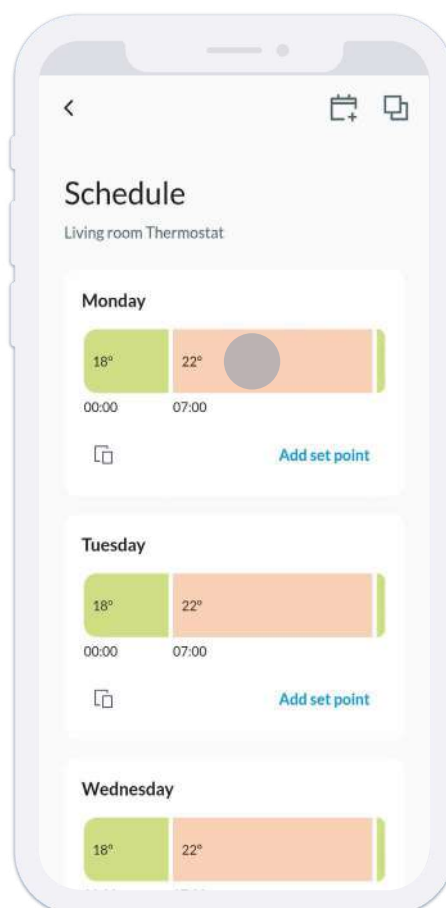

03

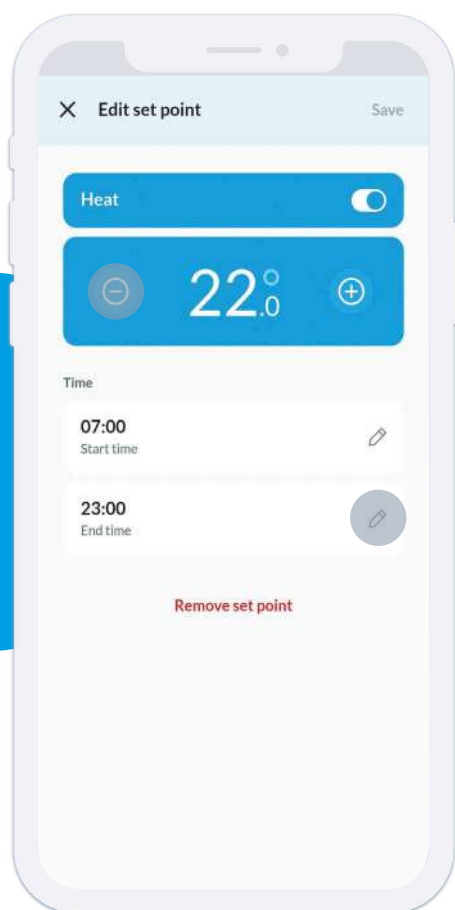

From here it's possible to set the time slot as inactive or change the start and stop times and the temperature to reach in that specific period of the day.

Once the desired temperature is set, modify the time and delete press add select **"Confirm"** to continue.

04

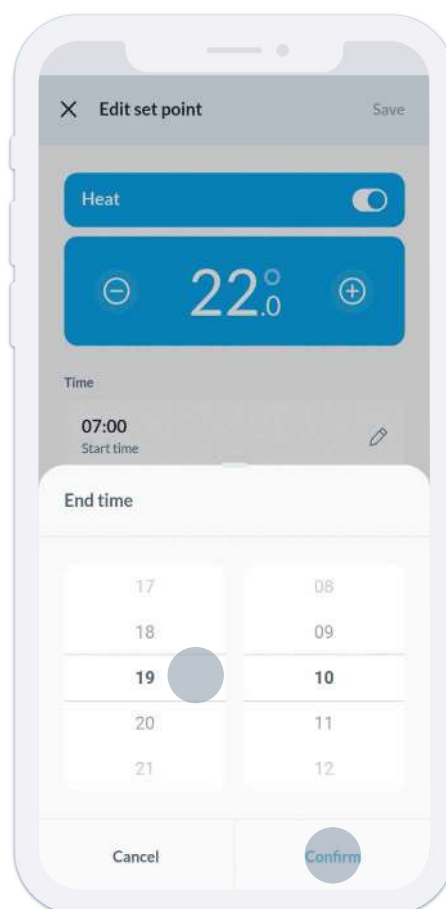

05

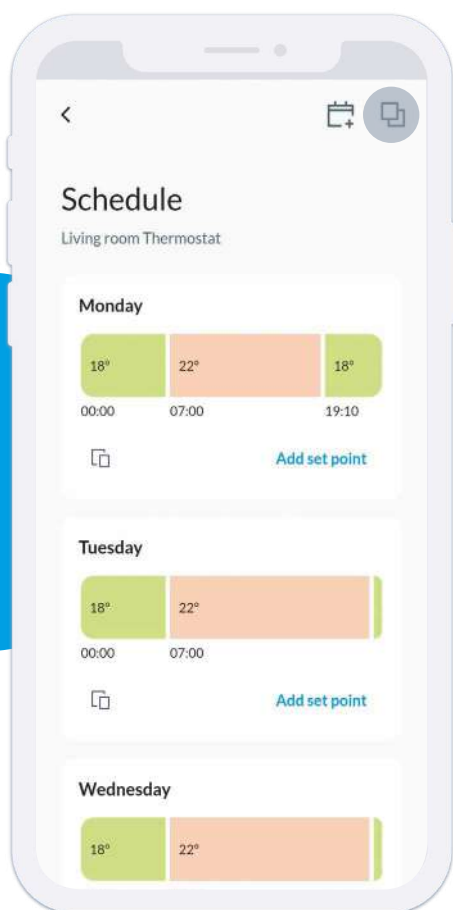

Once the program for a day is done, select the “**multiple paste**” icon to apply the configuration to other possible days of the week.

By selecting the day to copy, all days until Friday will be automatically selected. Refine the selection based on your needs and select “**Save**”.

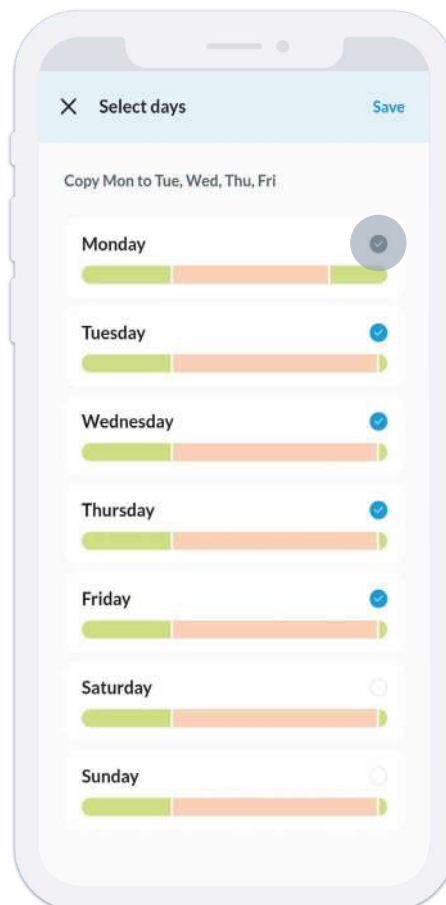

06

PRESETS: CREATION AND APPLICATION

PRESETS ARE DIFFERENT WEEKLY PROGRAMS TO APPLY IN DIFFERENT PERIODS OF THE YEAR, FOR EXAMPLE:
SUMMER AND WINTER

01

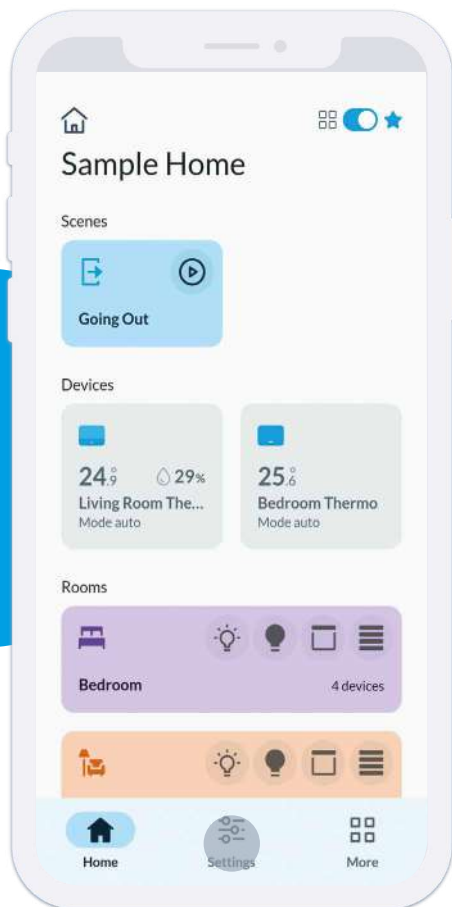

From the system's home screen, select **"Settings"**.

Select **"Plant Configuration"** to access the configurations of the thermostat from which you want to obtain the preset.

02

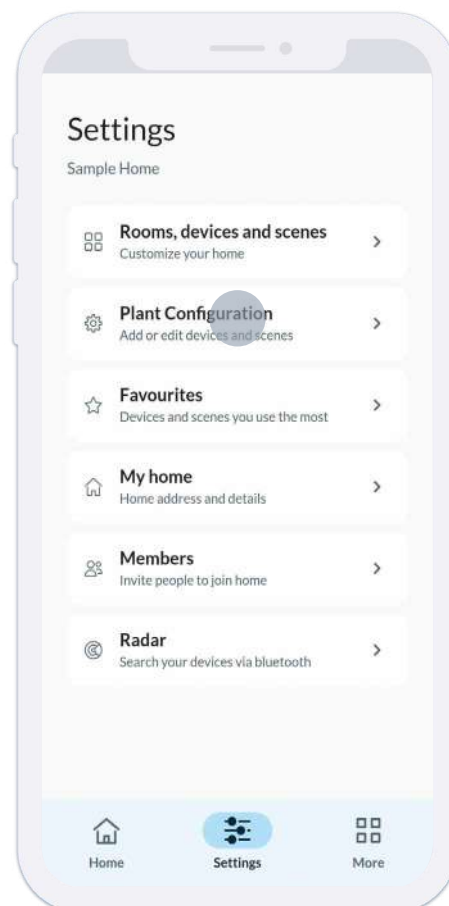

03

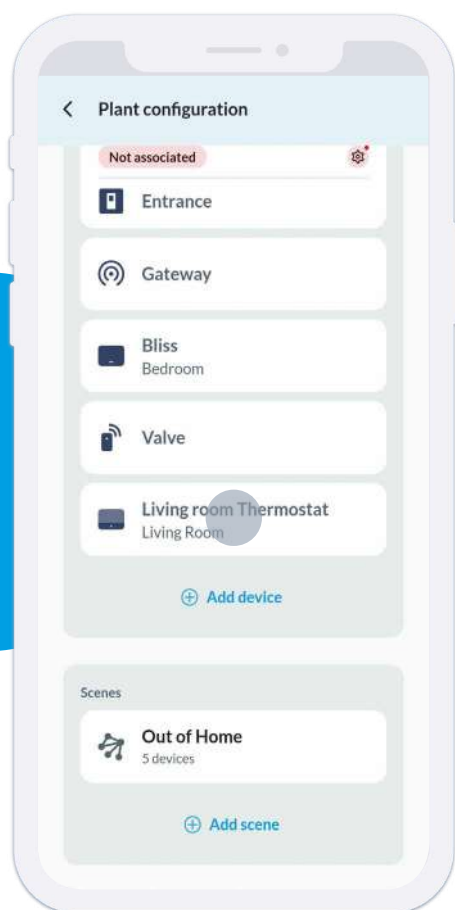

Select the thermostat from which you wish to obtain the configuration to create the preset.

Select "Presets".

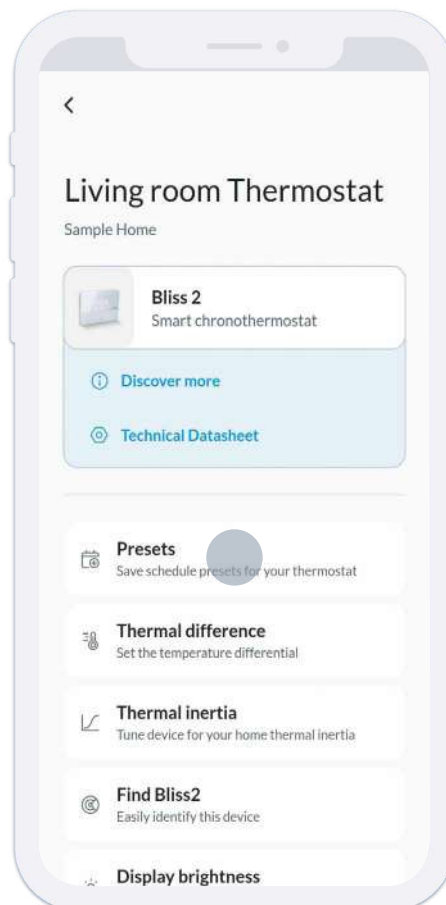

04

05

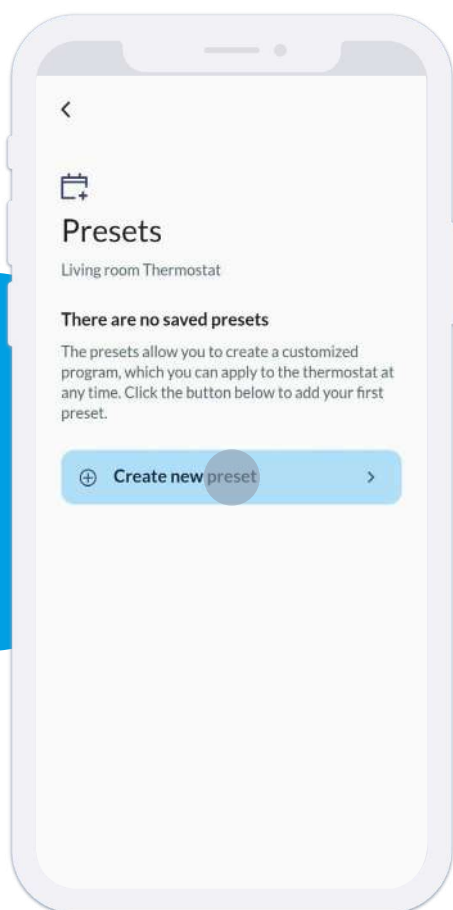

Select “Create new preset”.

Name the preset and eventually modify the weekly program.
Change press to select “**Save**” to continue.

06

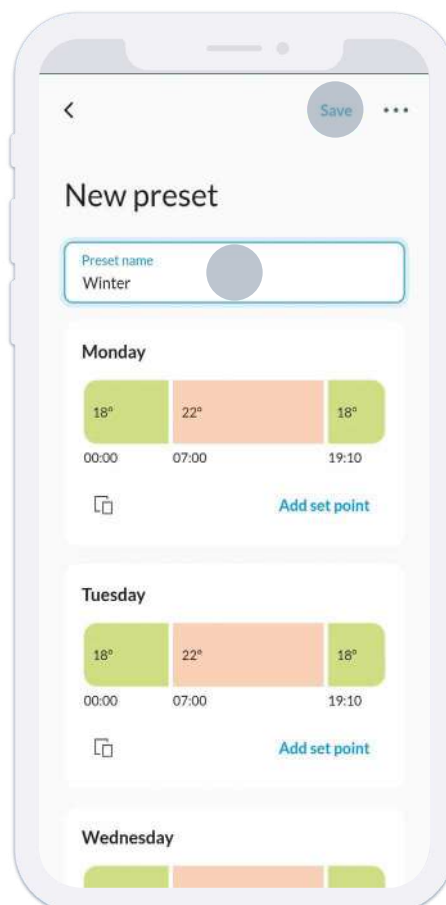

07

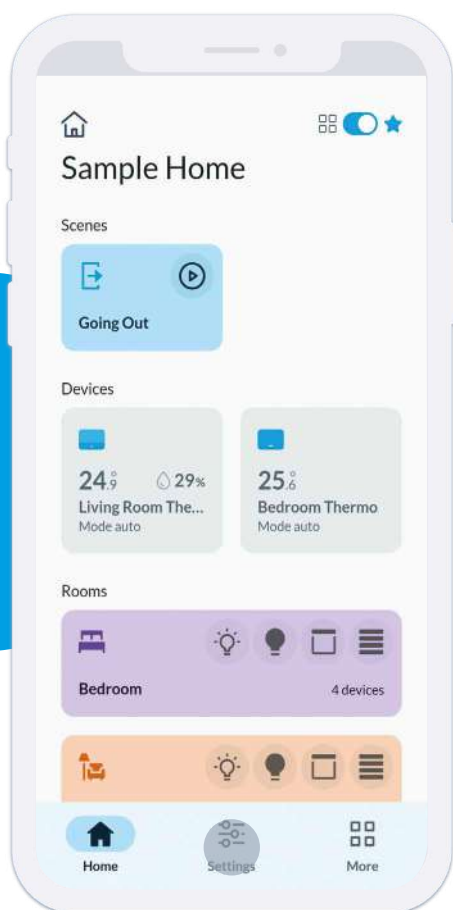

Get back to the home screen and select the thermostat on which you wish to apply the previously created preset.

Select the calendar icon.

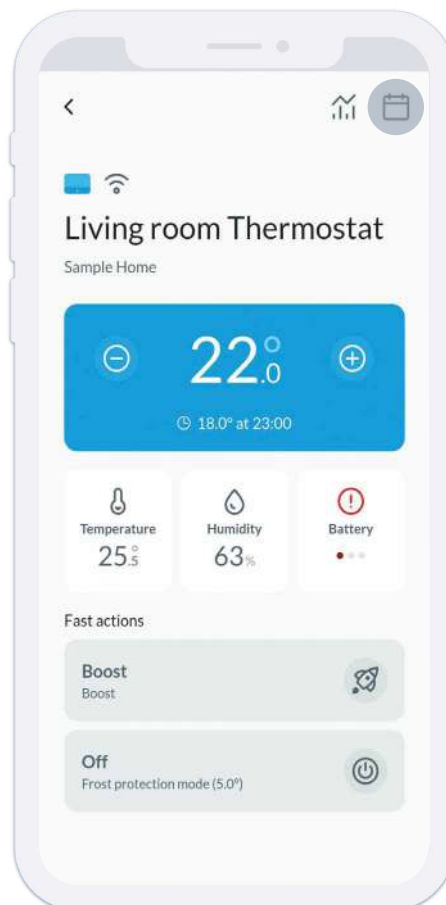

08

09

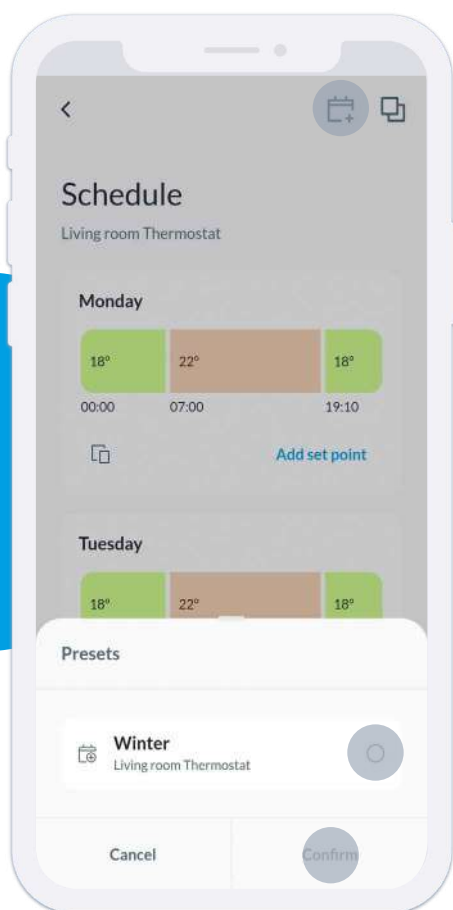

Press the icon above the presets, select the preset to apply, then select **"Confirm"**.

Correctly applied preset.

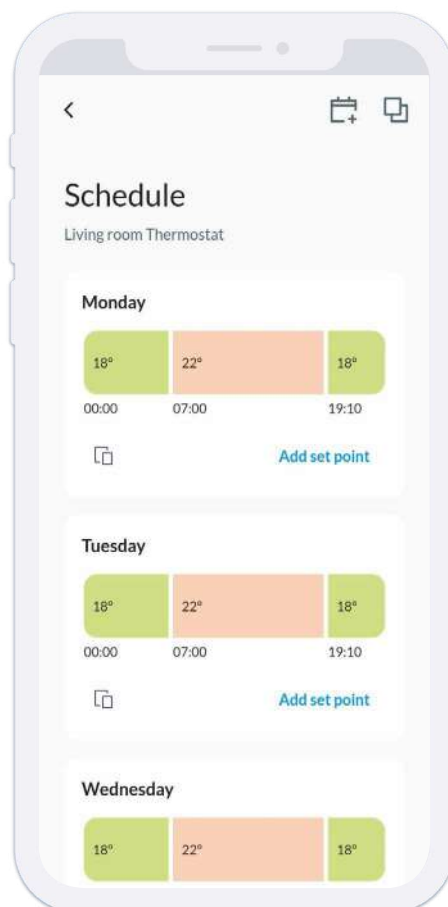

10

BLISS WI-FI SPECIFIC FUNCTIONS (TYPE 1C.91)

The screenshot shows the Bliss app interface for a 'Sample Home'. At the top, there's a back arrow and the title 'Bliss'. Below it, the status 'Sample Home' is shown. A card labeled 'BlissWiFi' indicates a 'Connected controllable chronothermostat'. The main menu includes several settings options, each with an icon and a brief description. Blue arrows point from these options to detailed explanations on the right.

Function	Description
Presets Save schedule presets for your thermostat	Creates one or more presets from the current weekly program
Thermal difference Set the temperature differential	Sets the lo gap in tenths of grade for the tolerance on the commutations to avoid stressing the thermoregulation system
Set season Change device mode	Changes the thermostat's functioning mode: winter (heating) or summer (cooling)
Timed temperature regulation Timed temperature regulation	Sets a temperature for a specific period of time that is coming in the future
Set pin Edit or remove device's PIN	Sets up a PIN to lock the display
Set update step Set the synchronization speed	Sets the speed at which the thermostat synchronizes with the server, from 1 (energy saving) to 4 (Super fast)
Advanced settings	Advanced settings, deletes the device

BLISS2 SPECIFIC FUNCTIONS (TYPE 1C.B1) LUMI

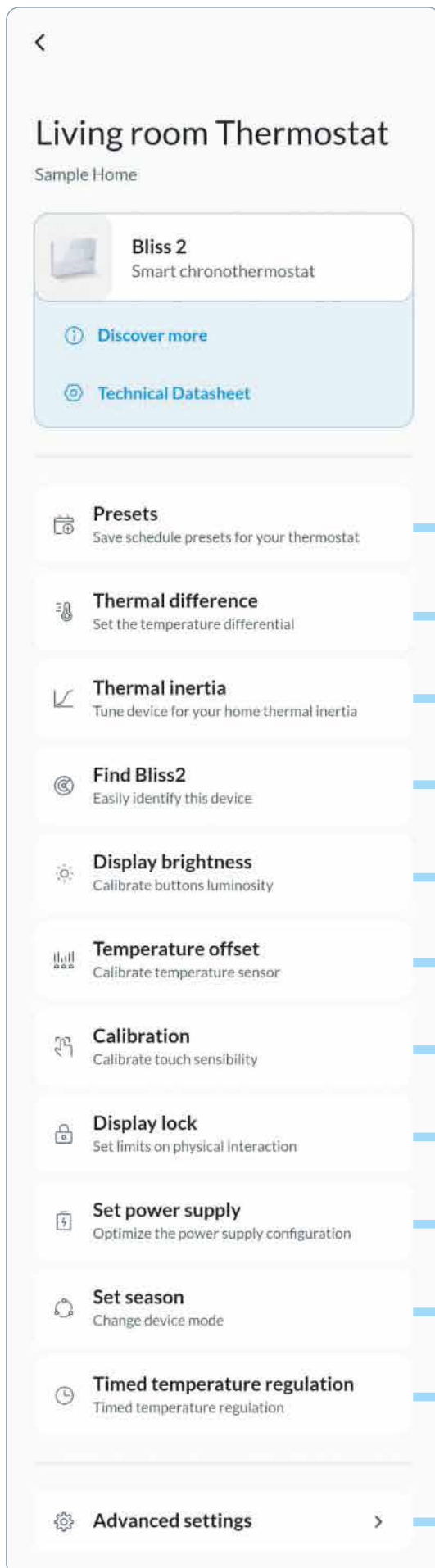

Creates one or more presets from the current weekly program

Sets the lo gap in tenths of grade for the tolerance on the commutations to avoid stressing the thermoregulation system

Sets the number of samples per hour based on which the average detected temperature is calculated

Blinks the LED to find the Bliss2

Sets the display brightness: levels from 1 to 10 or automatic

Calibrates the temperature sensor of the thermostat based off the value detected by a separated sensor

Calibrates the touch surface in case of Error 18

Blocks the manual setting of the temperature within customizable limits impostabili

Manually selects how the Bliss2 is powered. If you wish to shut down the thermostat when you use a power supply, select "Batteries".

Changes the thermostat's functioning mode: winter (heating) or summer (cooling)

Sets a temperature for a specific period of time that is coming in the future

Advanced settings, deletes the device

SETTINGS SECTION

THIS SCREEN IS ACCESSIBLE ONLY TO USERS WITH TECHNICIAN OR OWNER RIGHTS.
GUESTS CANNOT MODIFY ANYTHING IN THE SYSTEM.

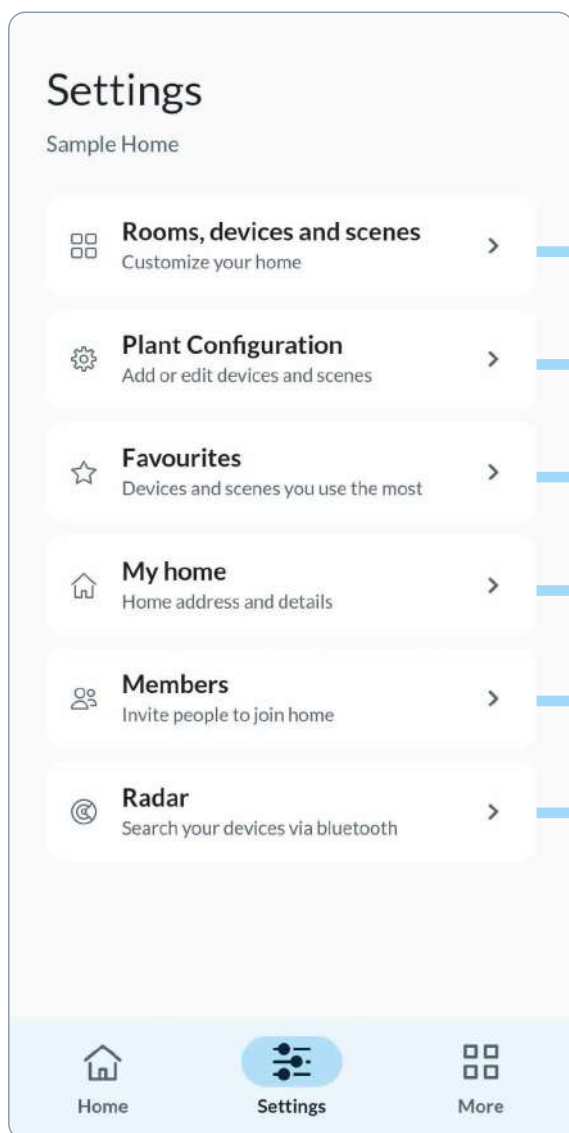

From here it is possible to rename the devices, change their icons and manage the rooms

In the advanced settings you can modify the configuration of the devices that make up the system, of the scenes and add new devices

The favourites highlight the devices that you wish to visualize in the homepage and the visualization order of the objects

From here you can manage the house address, the time zone and the autoaway. It is also possible to rename or delete the house

From the Users section you can manage accesses and shares of the house

The Radar function is useful to find the devices and to verify the status of inputs and outputs

HOUSE CUSTOMIZATION

ROOMS CUSTOMIZATION

01

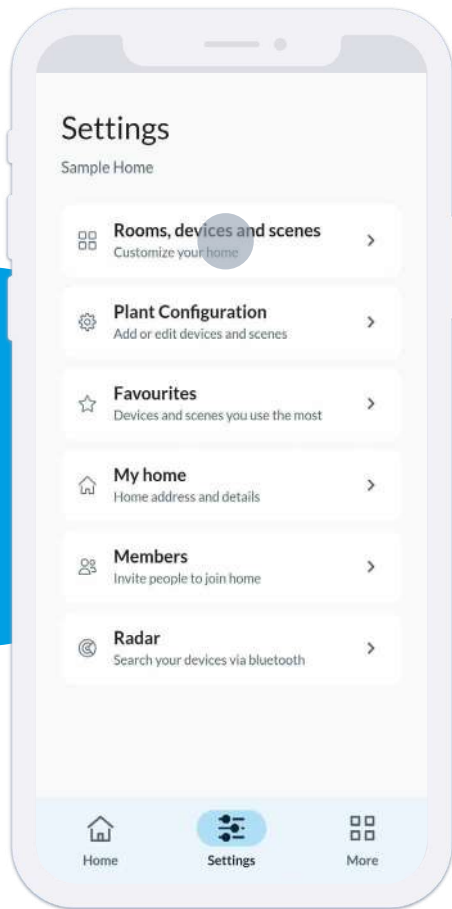

From the “Settings” screen, select “Rooms, devices and scenes”.

Select the “**Modify**” icon for the room that you wish to customize.

02

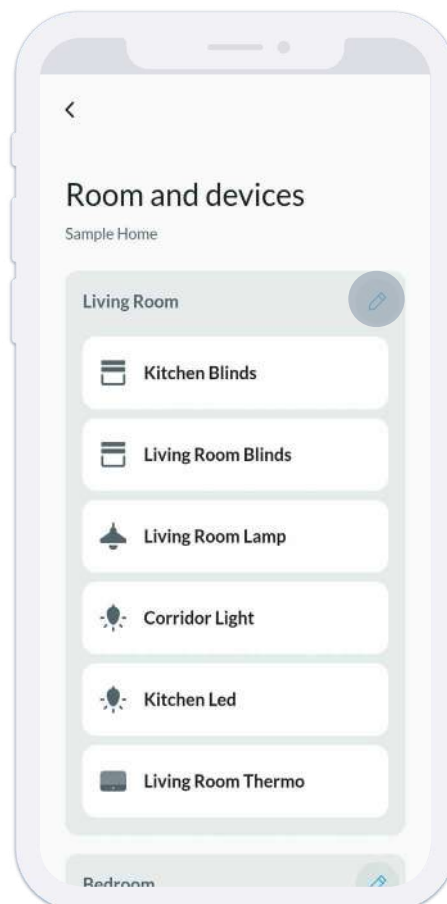

03

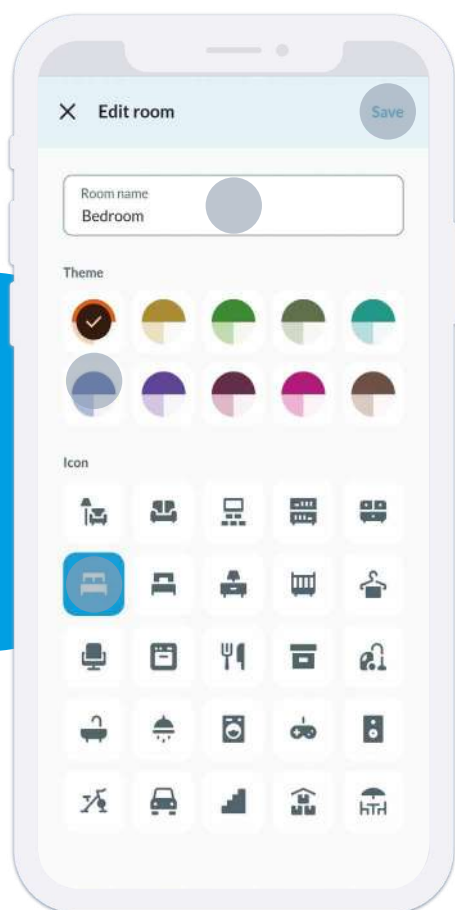

From here it is possible to rename and change the room's color and icon. Change press to select **"Save"** to confirm.

CUSTOMIZATION OF SINGLE DEVICES OR SCENES

01

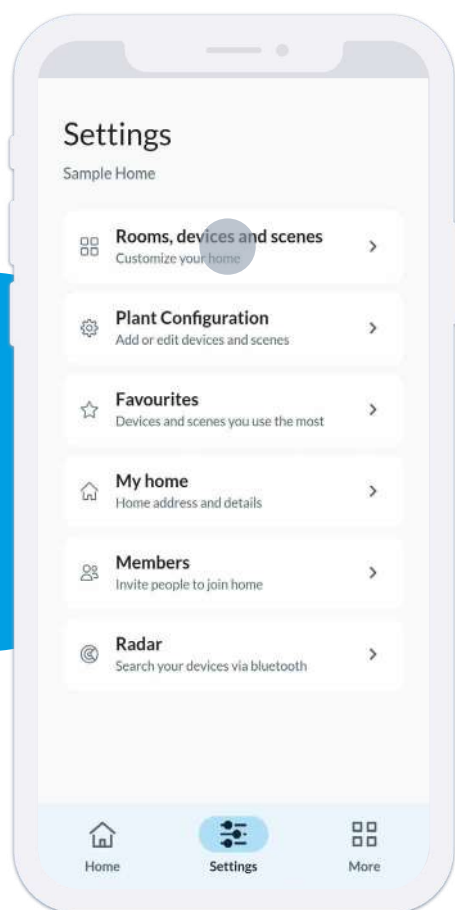

From the “Settings” screen, select “Rooms, devices and scenes”.

Select the device or the scene that you wish to customize.

02

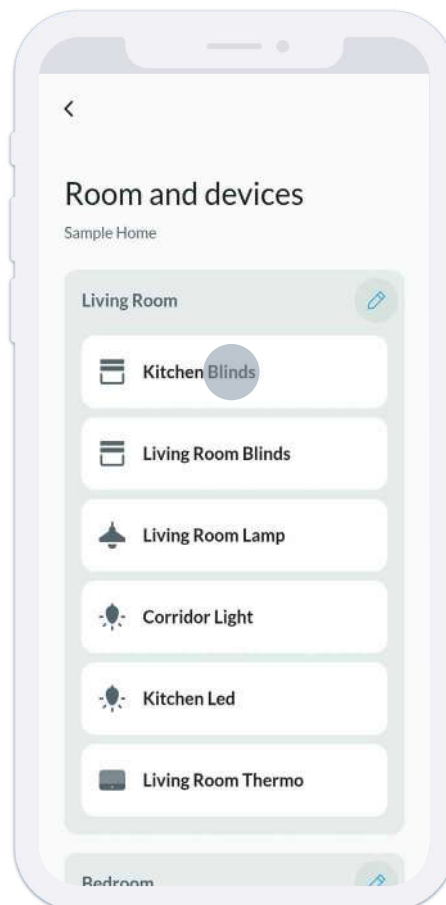

03

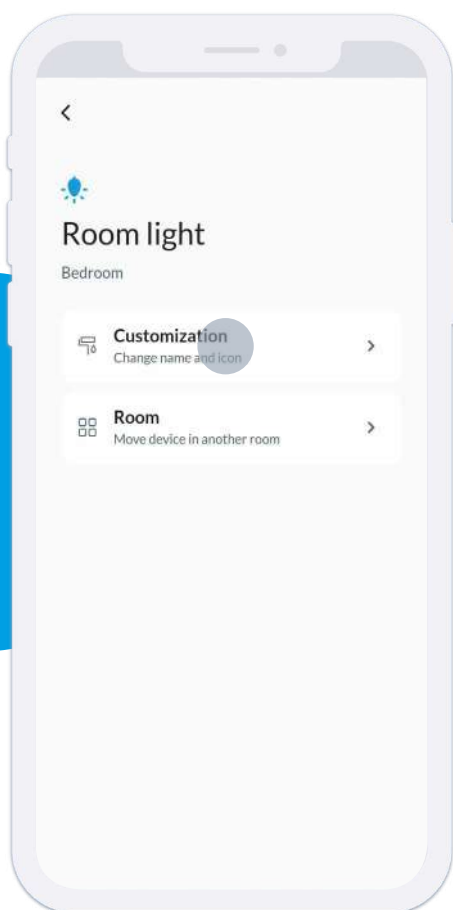

Select “Customization”.

From here it is possible to rename and change the icon of the device.
Change press to select “**Save**” to confirm.

04

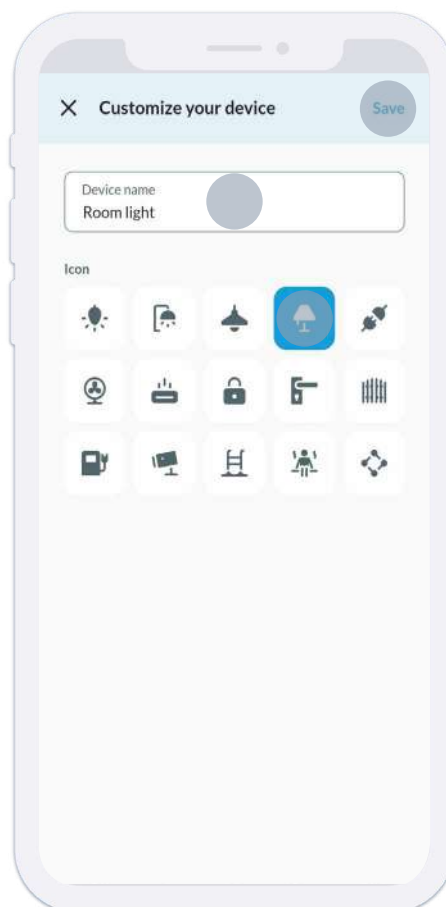

MOVING INDIVIDUAL DEVICES OR SCENES IN OTHER ROOMS SCENARIO

01

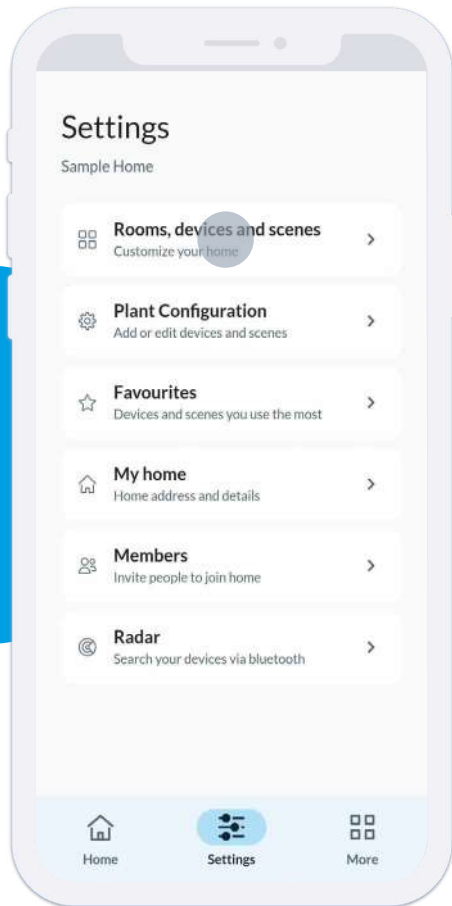

From the “Settings” screen, select “Rooms, devices and scenes”.

Select the device or the scene that you wish to customize.

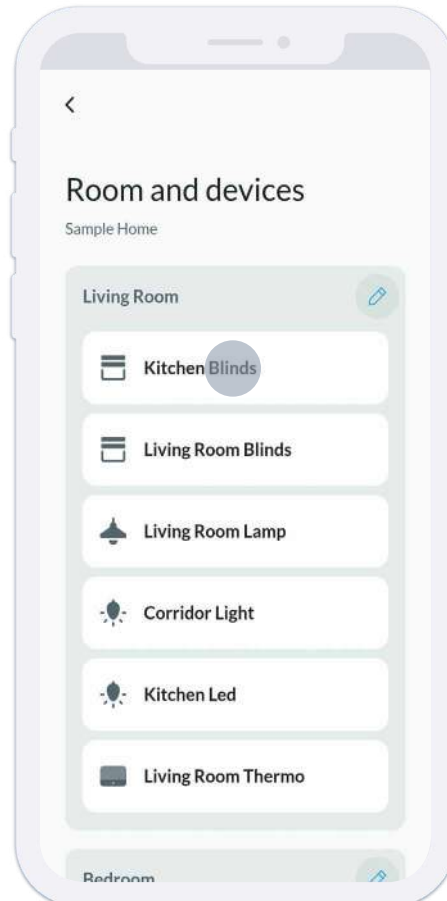

02

03

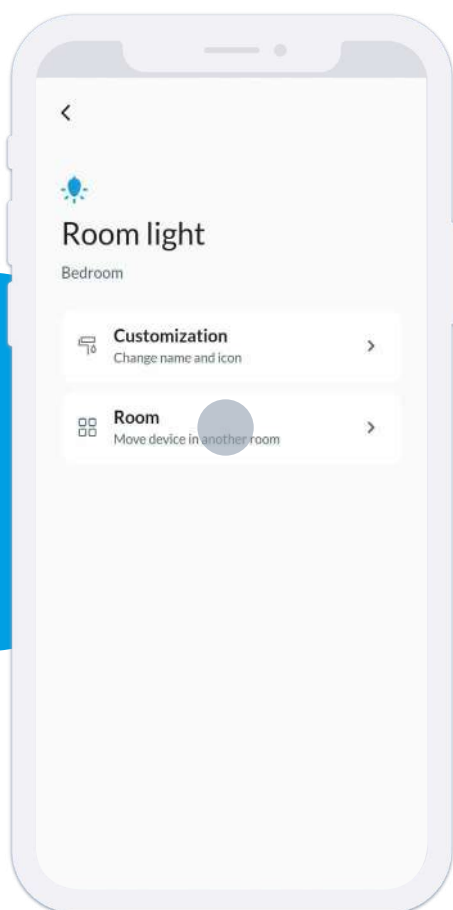

Select “Room”.

Select the room in which you wish to move the device or create a new one. Change press to select “**Save**” to confirm.

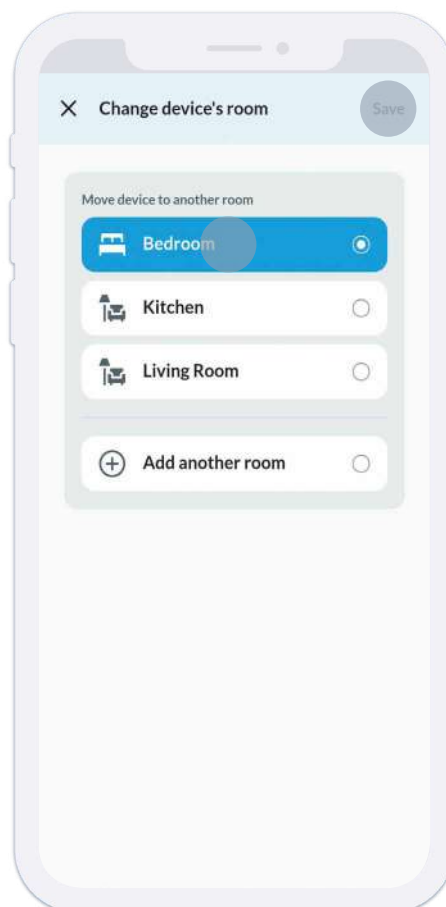

04

REARRANGING HOMEPAGE ELEMENTS

01

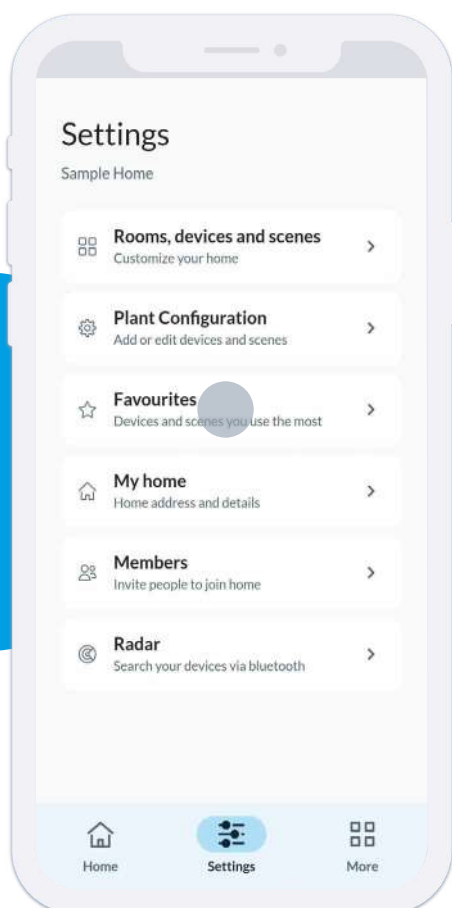

From the “Settings” screen, select “Favourites”.

Select “Reorder”.

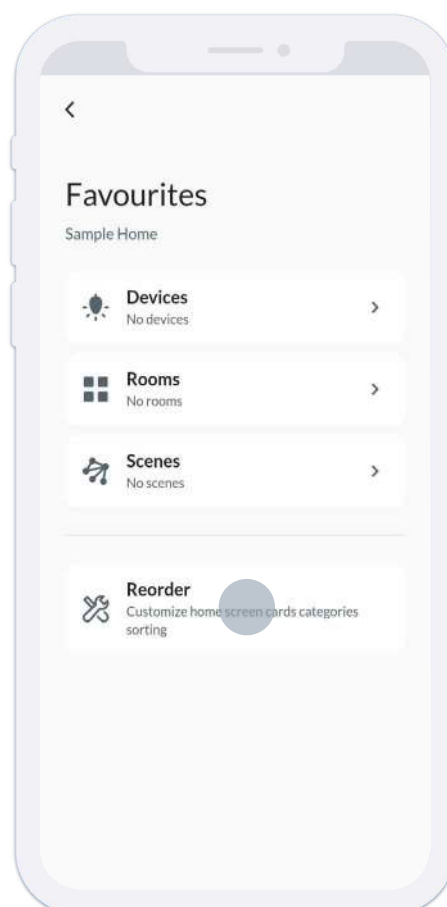

02

03

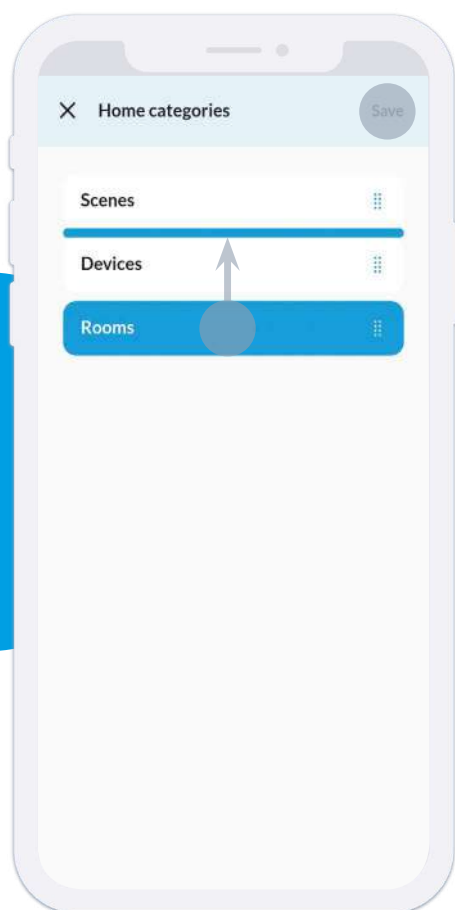

Keep pressed and drag the element to move in the new position.
Select **“Save”** to confirm.

Go back to the home page and press the selector to show the customized screen.

04

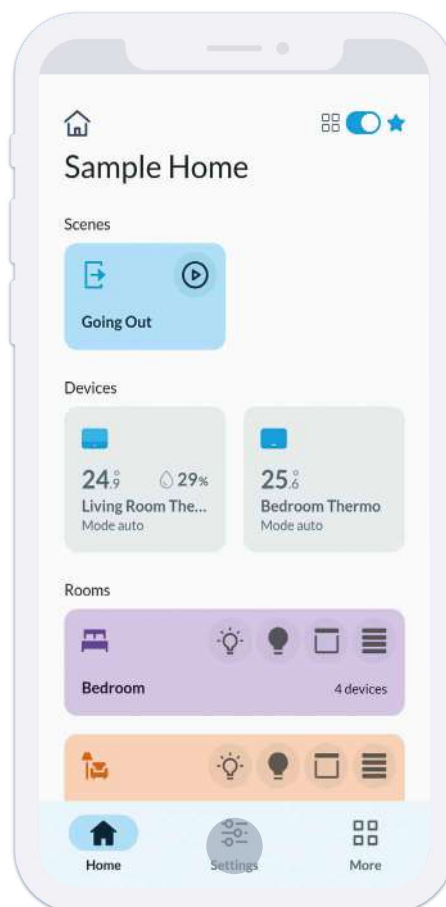

HOMEPAGE ELEMENTS CUSTOMIZATION

01

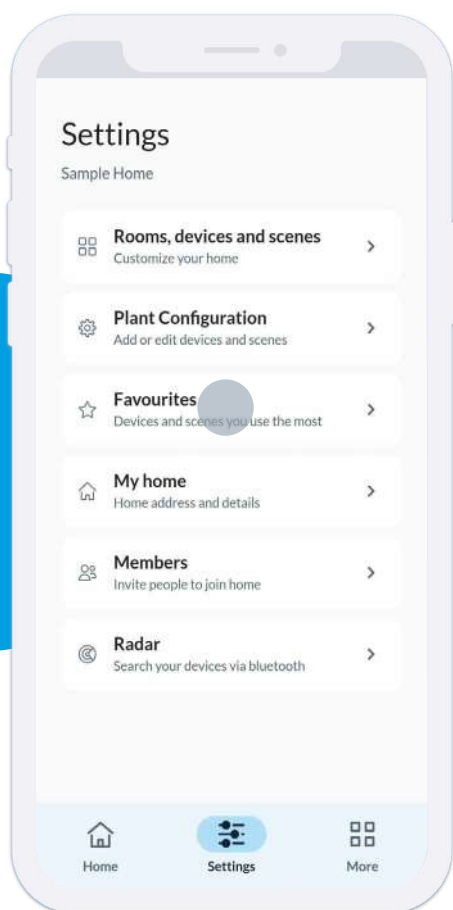

From the “Settings” screen, select “Favourites”.

Select the category of elements that you wish to customize.

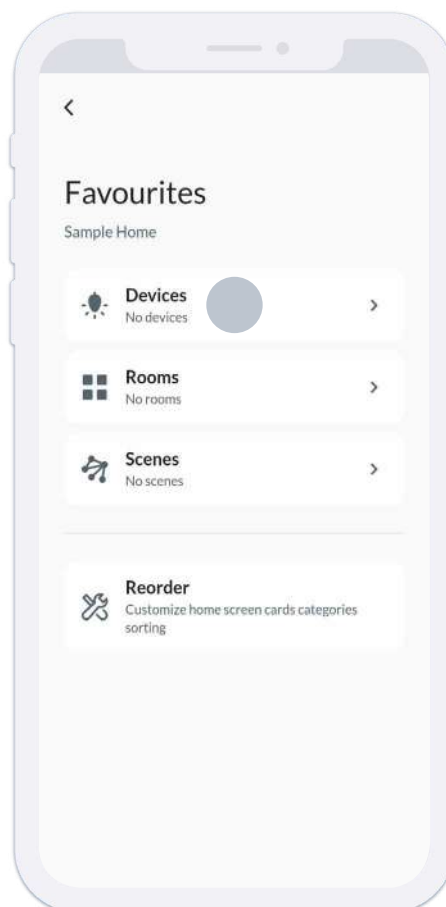

02

03

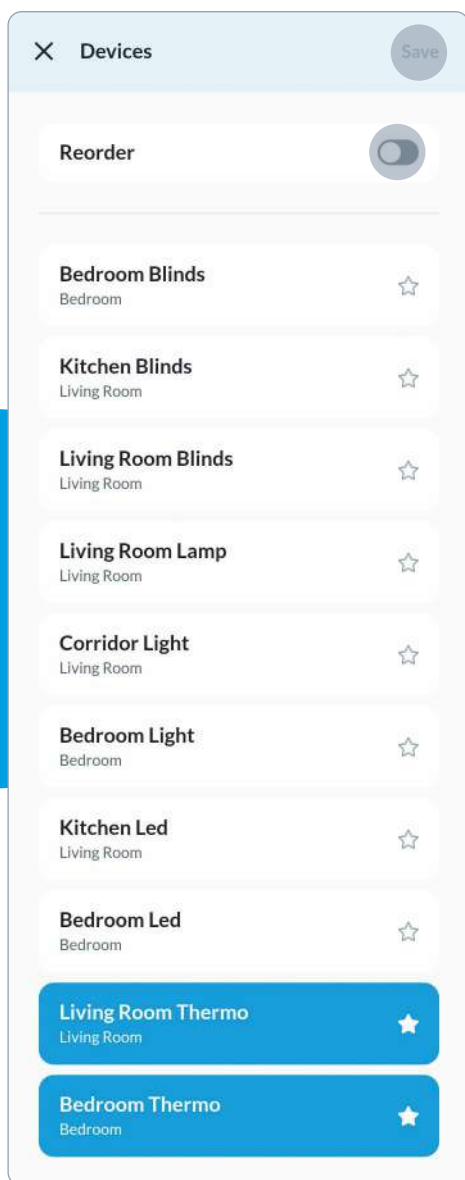

Go back to the home page and press the selector to show the customized screen.

Select the devices that you wish to visualize in the homepage.

To choose the visualization order, select **"Rearrange"**, then keep pressed and drag the element to move in the new position. Select **"Save"** to confirm.

If necessary, repeat this step for rooms and scenarios.

04

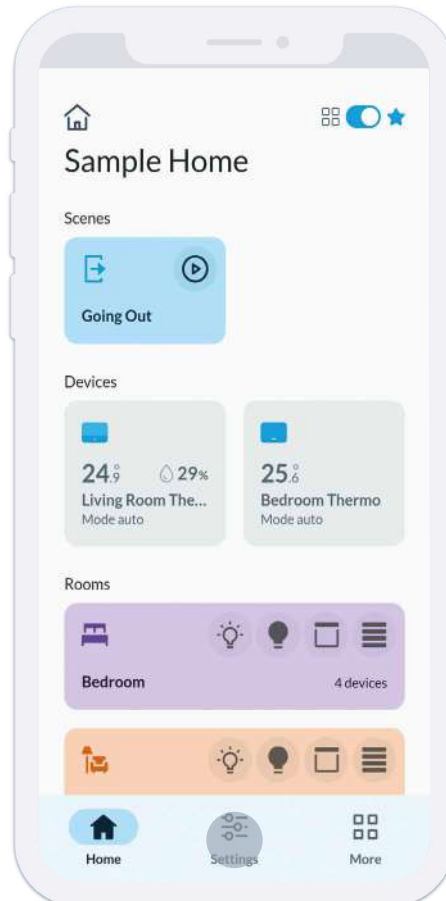

SHARES AND ACCESSES

BEFORE SHARING THE HOUSE IT'S IMPORTANT TO UNDERSTAND THE VARIOUS ACCESS TYPES:



TECHNICIAN

The technician is whoever physically wires the system but doesn't own it. The technician hands the house over to the owner once the configuration is done. The technician has similar access as the owner but cannot see the devices on voice assistants.



OWNER

The owner is whoever commissions the system to the technician. This kind of user has total control over the system. He can, in fact, modify its structure, manage any kind of shares, customize it and delete it. He can see the devices on the voice assistants.



GUEST

The guest can only use the devices without the right to modify any parameter. This kind of user may also be enabled for a limited time while sharing the house. Contrary to other kinds of access, there's no limit to the number of guests. The guest share is available exclusively for devices uploaded on gateways or for Bliss Wi-Fi thermostats.

KEEP IN MIND

A limited number of bluetooth accesses (cryptographics) are available, utilized by the Gateways and by the Technician or Owner accesses.

For this reason it's advisable to limit this type of accesses and revoke non necessary ones.

If all the accesses were to be utilized, follow the reset procedure automatically highlighted on the homepage banner.

01

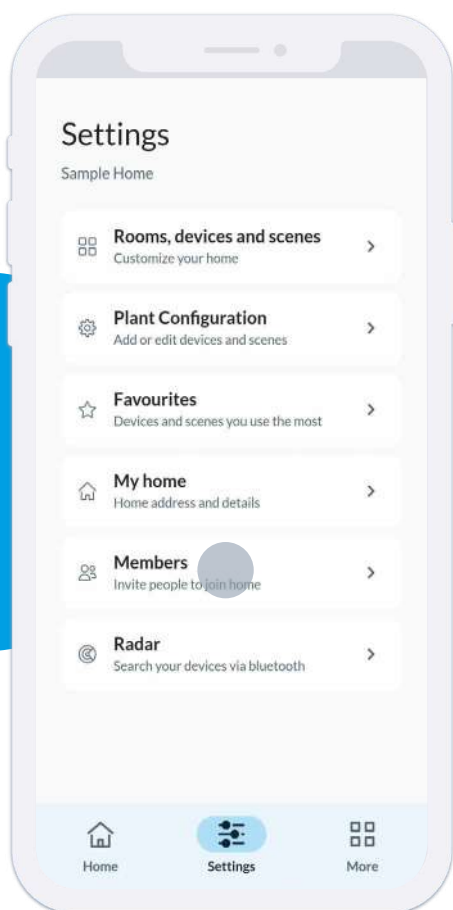

From the “Settings” screen, select “Members”.

From here it is possible to check and revoke the accesses to the house. Change press to select “Add user” to share the house.

02

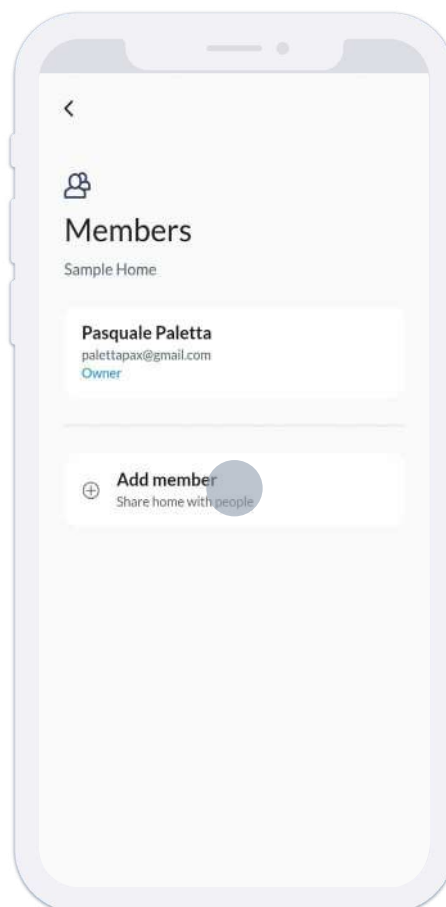

03

Invite member

Name: name

Email: email@mail.com

Privileges

Owner
They can control and modify all the devices in the house. Limited number of accesses. ☒

Technician
They can control and modify all the devices in the house. Limited number of accesses. ☐

Guest
They can control devices, but not edit them. Unlimited number of accesses. ☐

Enter the user's name and the mail which the house has to be shared to.

If the user is the owner, select the option and select **"Invite"**.

Shortly a mail will be delivered to the selected address from which the user can accept the invite.

If you wish to share the house to a guest, select the option and continue with the procedure.

Select **"Invite"** to finish the procedure. Shortly a mail will be delivered to the selected address from which the user can accept the invite. If you wish to share the house in part, or temporarily, follow the procedure.

04

Invite member

Name: name

Email: email@mail.com

Privileges

Owner
They can control and modify all the devices in the house. Limited number of accesses. ☐

Technician
They can control and modify all the devices in the house. Limited number of accesses. ☐

Guest
They can control devices, but not edit them. Unlimited number of accesses. ☒

Time share

Member for a limited time
Time period in which sharing is active. ☐

05

Invite member Invite

Technician
They can control and modify all the devices in the house. Limited number of accesses. ☐

Guest
They can control devices, but not edit them. Unlimited number of accesses. ☒

Time share

Member for a limited time

Select end time

28/10/2023	15	52
29/10/2023	16	53
30/10/2023	17	54
31/10/2023	18	55
01/11/2023	19	56

Cancel Confirm

Select **"Limited Time User"**, set the period in which the user has access to the house and select **"Confirm"**. Shortly a mail will be delivered to the selected address from which the user can accept the invite. If you wish to share only part of the house follow the procedure.

Select **"Invite"** to finish the procedure. Shortly a mail will be delivered to the selected address from which the user can accept the invite. If you wish to share the house in part or temporarily, follow the procedure.

06

Invite member Invite

Name
name

Email
email@mail.com

Privileges

Owner
They can control and modify all the devices in the house. Limited number of accesses. ☐

Technician
They can control and modify all the devices in the house. Limited number of accesses. ☐

Guest
They can control devices, but not edit them. Unlimited number of accesses. ☒

Time share

Member for a limited time
Time period in which sharing is active. ☐

07

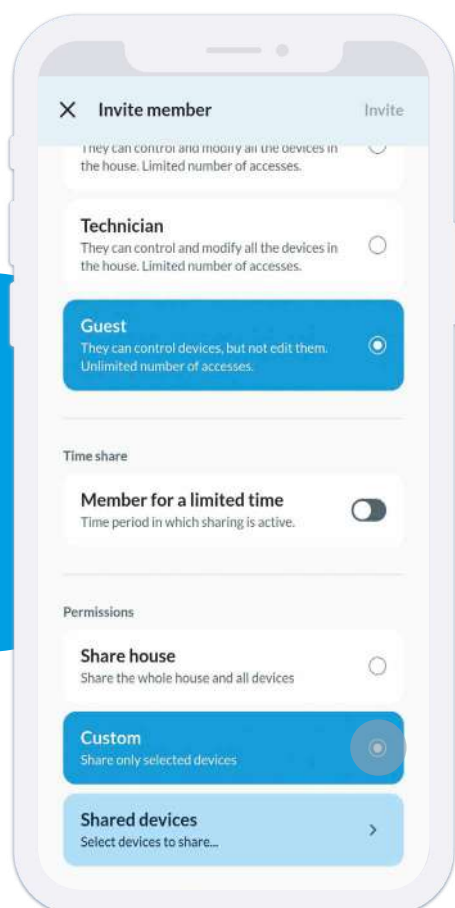

Select **"Custom"**.

Select the devices, scenes or the whole rooms that you wish to share.

Shortly a mail will be delivered to the selected address from which the user can accept the invite.

Select **"Invite"** to finish the procedure.

08

