

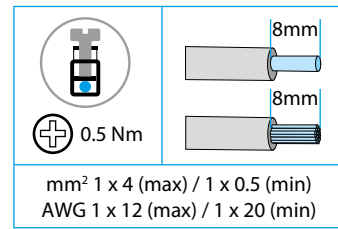

# 78.1B

<b>IN</b>	<b>78.1B.1.230.2403</b> $U_N$ (120...240)V AC (50/60 Hz) $U_N$ 220 V DC $U_{min} - U_{max}$ 100 - 265 V AC (50/60 Hz) $U_{min} - U_{max}$ 140 - 275 V DC $P_{(stand-by)} < 1$ W
<b>OUT</b>	- 5 A (max 10 A - 5 ms) 24 V DC, 120 W [IN 230 V AC, (-20...+40)°C] - 4.5 A (max 10 A - 5 ms), 24 V DC, 110 W [IN (100...275)V, 40°C]
	(-20...+70)°C
IP20	



78	$U_N$	LED
OK	✓	
Sh	✓	15s. OFF
ThL	✓	OFF

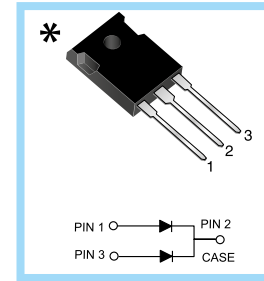
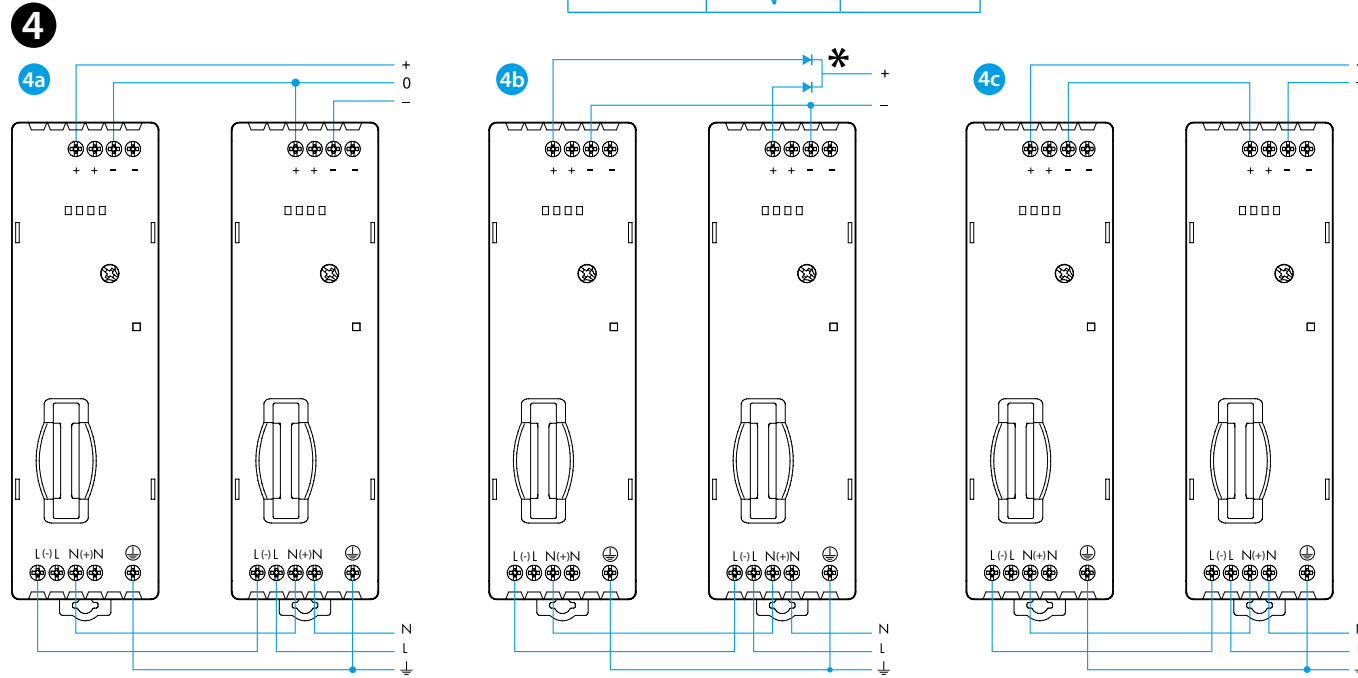
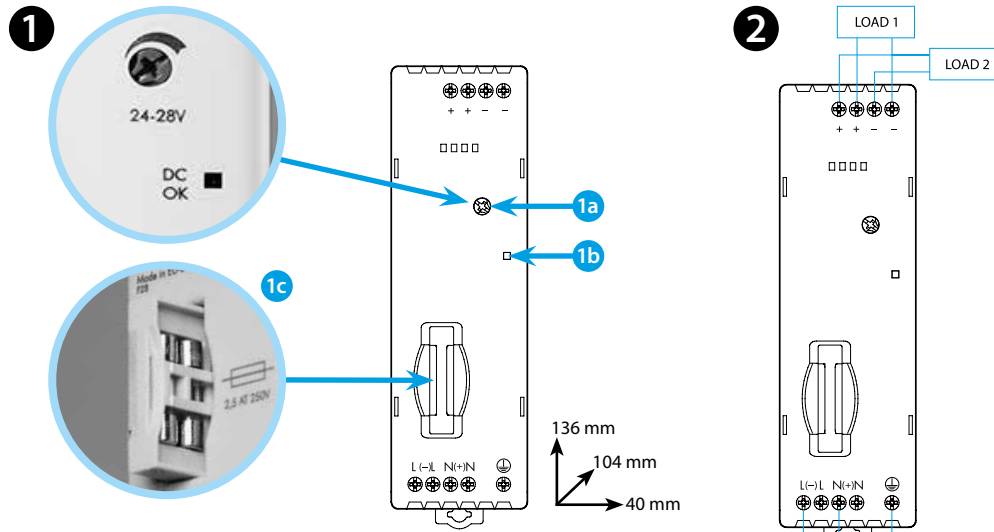

**UL US LISTED**  
 IND. CONT. EQ.  
 E361251

Input 115 V AC 50/60 Hz / 1.65 A  
 Output 24 V DC, 4 A / 96 W  
 Input 230 V AC 50/60 Hz / 1.1 A  
 Output 24 V DC, 4.5 A / 108 W

- Open Type Equipment - Pollution Degree-2 Installation Environment
- Maximum Surrounding Air Temperature 40°C
- Use 60°C / 75°C copper (CU) conductor and wire ranges No. 14-18 AWG, stranded or solid
- The terminal tightening torque of 0.5 Nm

- A readily accessible disconnect device shall be incorporated in the building installation wiring:
- Circuit breaker 6 A Z-curve
  - Input fuse 3.15 A - T - F1
  - Equipment intended for installation in restricted access location

# ENGLISH

## 78.1B SWITCH MODE POWER SUPPLIE

- 1 DIMENSIONS / FRONT VIEW**  
 1a Nominal output voltage 24 V DC adjustable between 24 and 28 V  
 1b Green LED: Indication of output status  
 1c Fuse protection of input supply (Fuse: 3.15 A-T - plus spare)

**2 CONNECTIONS**

**3 LED INDICATION AND FUNCTION**

- $U_N$  AC/DC Supply
- Sh Short circuit
- ThL Thermal limit
- Led (1b) LED Green

**4 WIRING DIAGRAM EXAMPLES**

- 4a Dual connection - for a Bipolar supply
- 4b Parallel connection ( $I \leq 2 \times I_N$ )  
 \* MBR 4060PT (TO247)
- 4c Series connection - for increased output voltage

**NOTE**

- Efficiency: 93% @ 230 V AC
- Automatic short circuit protection
- **The product can be used without particular wiring requirements, but, to ensure compliance with EN 61204-3: 2019, the length of the connection cables between the output terminals and the load must not exceed 30 m**