

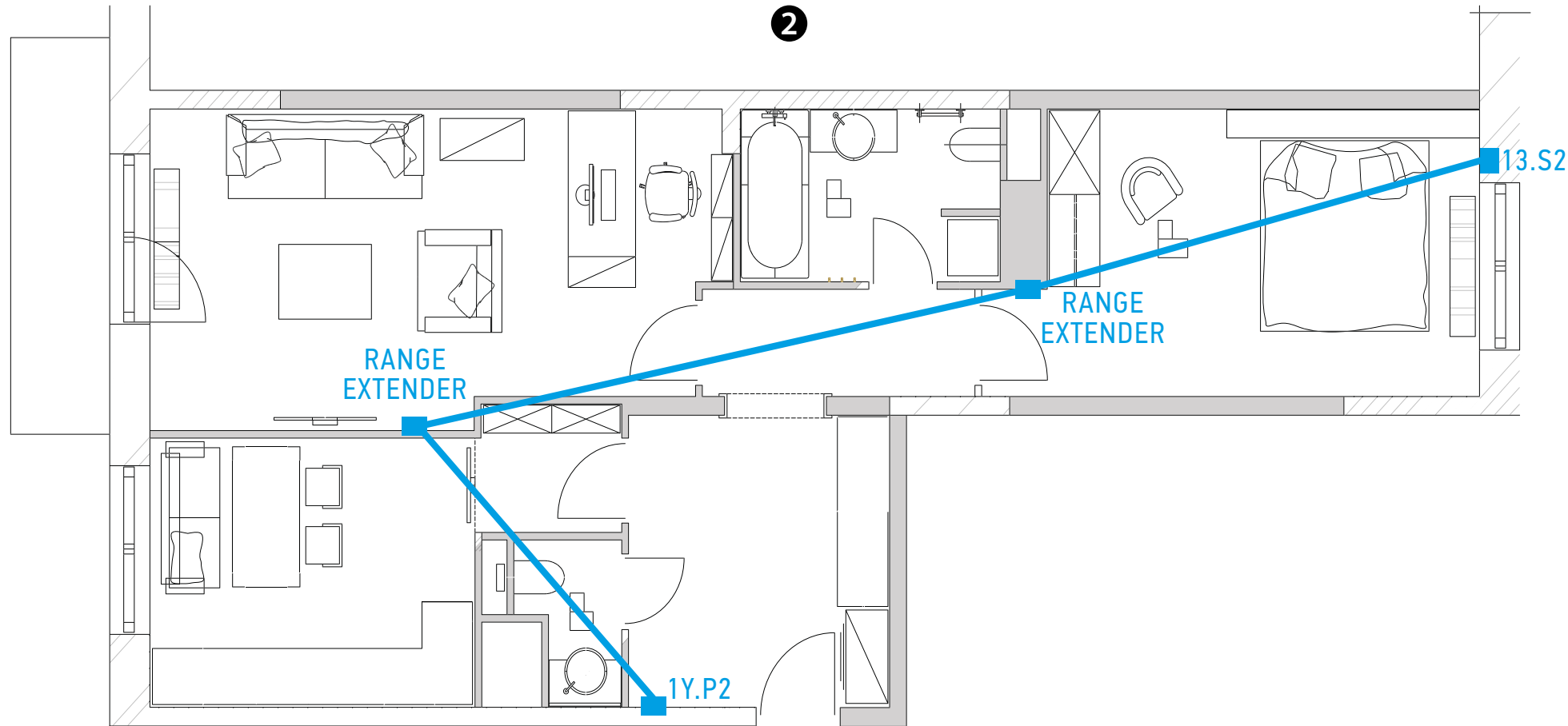

1Y.E8.230

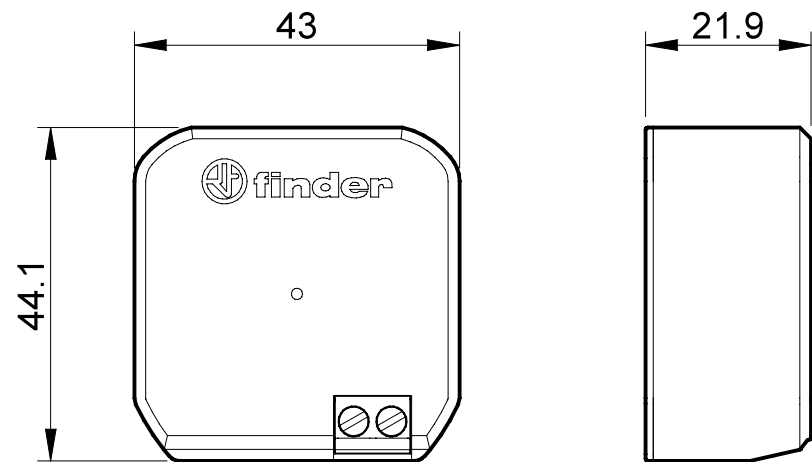
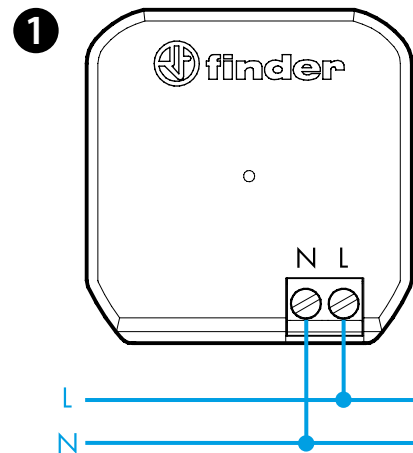
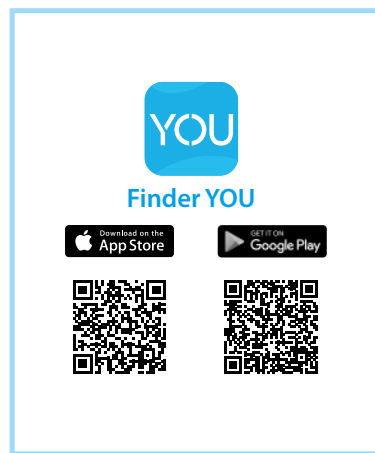

## ENGLISH

### 1Y.E8.230 RANGE EXTENDER 230 V AC

#### 1 WIRING DIAGRAM

#### 2 INSTALLATION

##### NOTE

- Interpose the range extender between the transmitter and the receiver in a central position inside the house in a non-perimeter position. Do not install the range extender near the 1Y.P2 interface
- Does NOT require configuration
- Maximum of 4 Range Extenders per YESLY device group

##### TECHNICAL SPECIFICATION

Power supply	110...230 V AC
Operating frequency	2.4 Ghz
Operating temperature	-10...+50°C
Approvals	CE, FCC, IC (Europe, US, Canada)
Transmission range	Approximately 10 m in free space and without obstacles. The transmission range may vary depending on the building structure