







18.A1

EN 60669-1 / EN 60669-2-1			
18.A1.8.230.0000			
U _N (110...230)V AC (50/60)Hz			
U _{min} - U _{max} 96 V AC – 253 V AC			
P 2 VA (50 Hz) / 0.8 W			
1 NO (SPST-NO) 10 A 120 V AC μ		1 NO (SPST-NO) 10 A 230 V AC μ	
AC1 1200 VA		AC1 2300 VA	
AC15 (120 V AC) 250 VA		AC15 (230 V AC) 450 VA	
 (120 V AC) 500 W		 (230 V AC) 1000 W	
 (120 V AC) 200 W		 (230 V AC) 350 W	
CFL-LED (120 V AC) 80 W		CFL-LED (230 V AC) 150 W	
 (-30...+50)°C			
IP55			

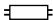

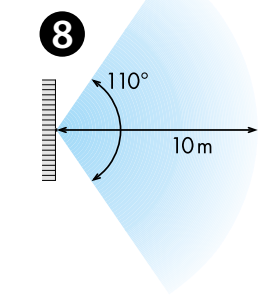
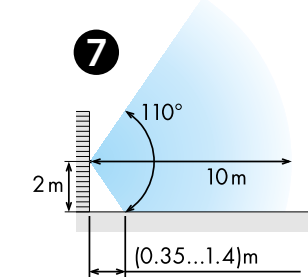
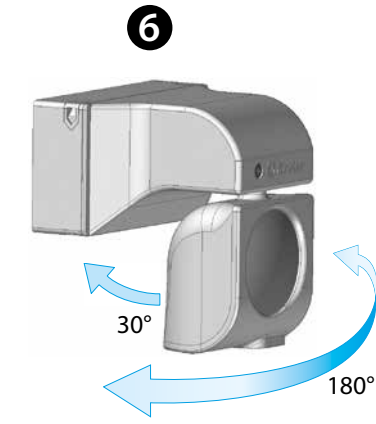
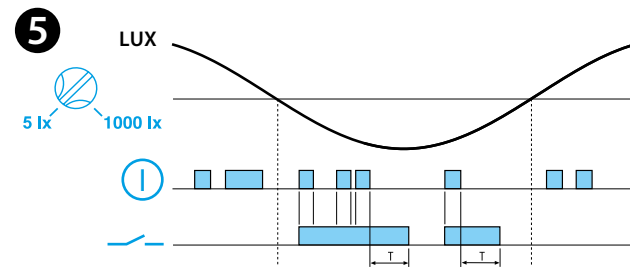
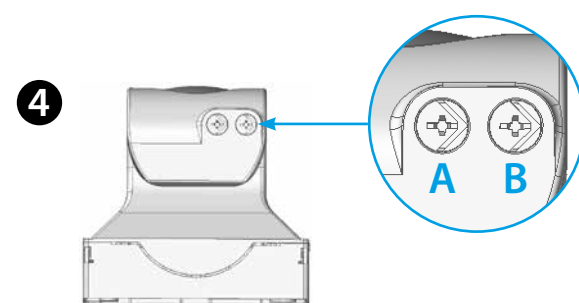
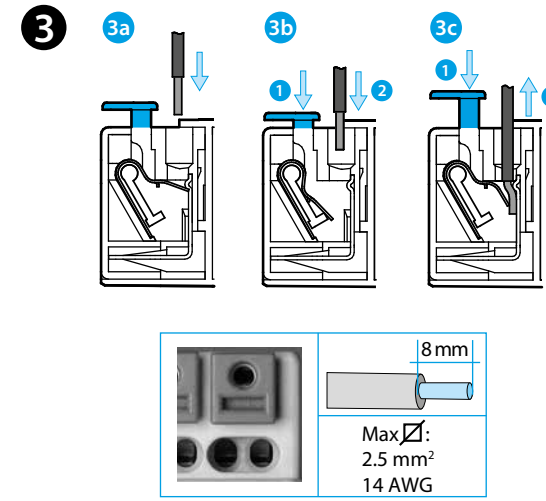
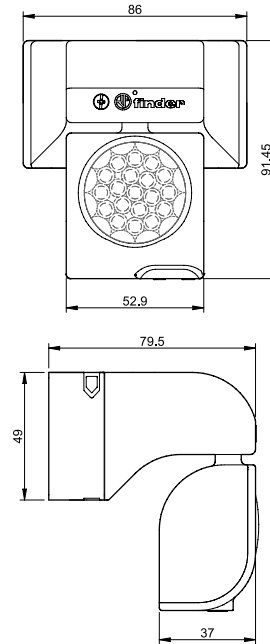
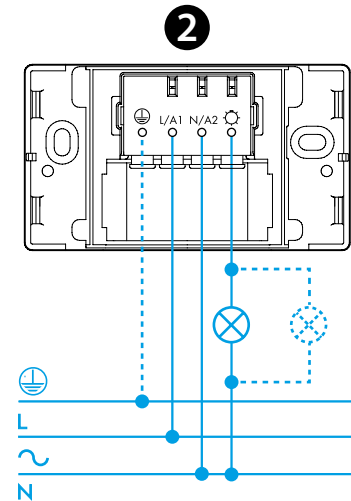
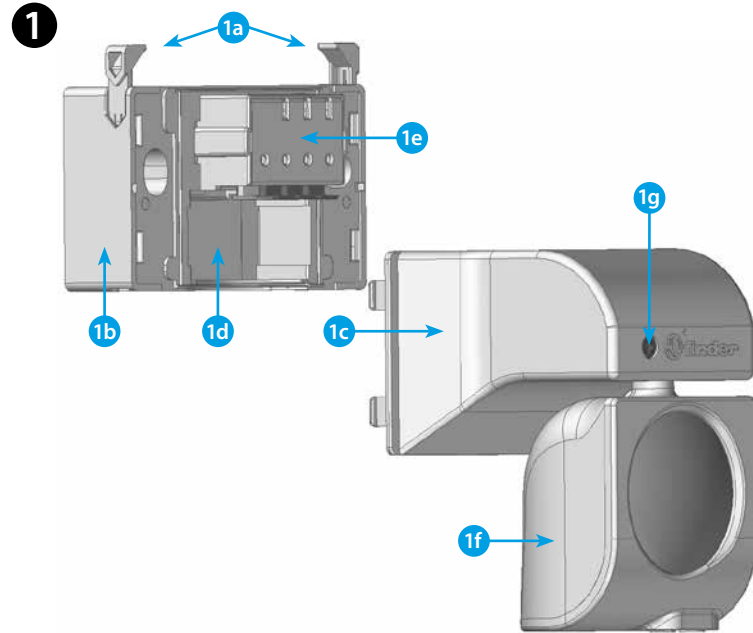
ENGLISH

18.A1 PIR MOVEMENT DETECTOR FOR EXTERNAL INSTALLATION

- 1 INSTALLATION SEQUENCE**
- Raise the side pins (1a)
 - Unhook the support (1b) from the lens body (1c) and fix it to the wall through the holes
 - Insert the wires into the detector puncturing the membrane (1d)
 - Insert the wires into the push-in terminals (1e), according to the schematic diagram of the point 2
 - Reattach the lens body (1c) to its support (1b)
 - Lower the side pins (1a), orient the lens body to the desired position (1f) and secure it in the desired position by tightening the screw (1g)

- 2 CONNECTION DIAGRAM**
(Maximum cable size: 2.5 mm²)

- 3 TERMINAL PUSH-IN CONNECTION**
- 3a Connection - solid cable or cable with ferrule
 - 3b Connection - stranded cable
 - 3c Disconnection

- 4 SETTINGS**
- A Output on-pulse time (10 s...20 min)
 - B Ambient light intervention threshold (5...1.000)lx [1000 lx = always ON (∞ lx)]

- 5 FUNCTION CHART**
- ⓘ Detection of movement
 - Output Contact

- 6 MOUNTING AND ORIENTATION**

- 7 SIDE VIEW**
(wall mounting - sensing area)

- 8 PLAN VIEW**
(wall mounting - sensing area)

NOTE
Following the initial power-on, and power-on following a power interruption, the detector makes a hardware-software initialisation for approximately 30 seconds.