



1321-S

EN 60669-1/EN 60669-2-1	
	13.21.8.230.S000 U_N 110...230 V AC (50/60 Hz) U_{min} 96 V AC U_{max} 253 V AC P 2.8 VA (50 Hz)/0.8W
	1 CO (SPDT) 16 A 250 V AC
	AC1 3600 VA AC15 (230 V AC) 600 VA (230 V AC) 0.5 kW DC1 (30/110/220V) (16/0.3/0.12)A
	(-10...+50)°C
IP20	

YOU
Finder YOU

Download on the App Store
 GET IT ON Google Play

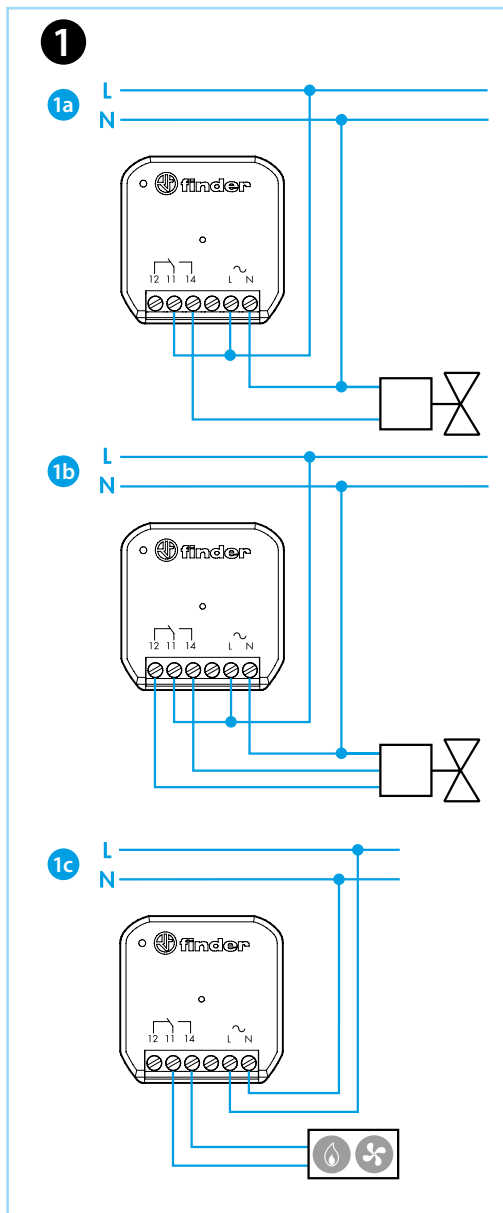
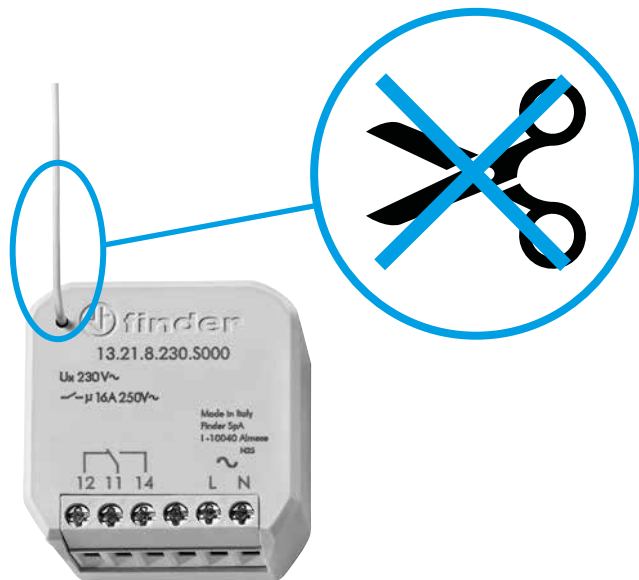

ENGLISH

13.21.8.230.S000 RF remote actuator with 16 A changeover contact for use with the Bliss2 smart thermostat

APPLICATION

The 13.21-S000 actuator when integrated with the Bliss2 Thermostat and the Gateway2 is ideal for temperature regulation within multizone installations - thanks to its long-range radio frequency transmission capability.

It can add greatly to the versatility in the way heating and cooling systems are controlled.

And it can also be programmed to function as a hygrostat in controlling dehumidification systems - using the Humidity sensor within the Bliss2 Thermostat.

INSTALLATION

The 13.21-S000 Actuator must be used in conjunction with the Gateway2 and the Smart Bliss2 Thermostat.

To configure, load the Finder Bliss application from the Google Play Store or the Apple Store and proceed with the association, following the tutorial on the App.

For more info: yesly.life/setup-bliss2

1 CONNECTION DIAGRAM

1a Example of connection with solenoid valve (2 wires)

1b Example of connection with motorized valve (3 wires)

1c Installation of the heating / air conditioning system (refer to instructions for your heating system (pump, valve, boiler, etc.))

SIGNALING LED

White LED on the side:

Fading flashing: waiting for configuration

Red LED in the center:

Flashing: sending / receiving 868 MHz radio commands

RESET

Press the button on the top face for > 10 seconds to restore the factory settings.

