

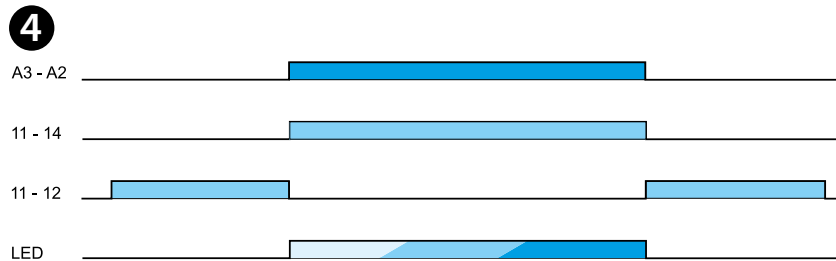

19.31

	<b>19.31.0.024.0000</b> U <sub>N</sub> 24 V AC (50/60 Hz) / DC U <sub>min</sub> - U <sub>max</sub> (19.2 - 26.4)V AC / DC P 0.4 VA / 0.25 W
	1CO (SPDT) 1 A 125 V AC
	AC1 125 VA AC15 (230 V AC) 25 VA DC1 (24/110/220)V: (1/0.3/-)A
	(-20...+50)°C
IP20	

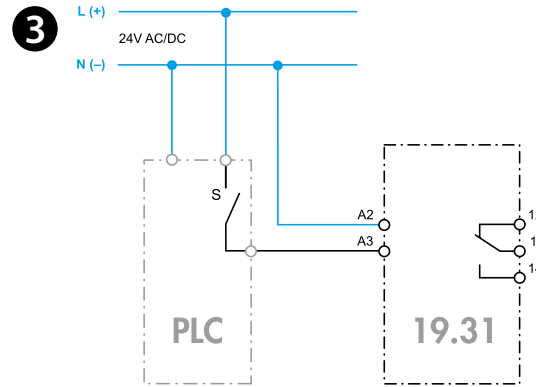
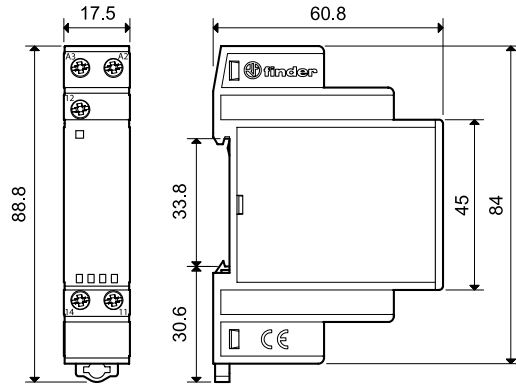
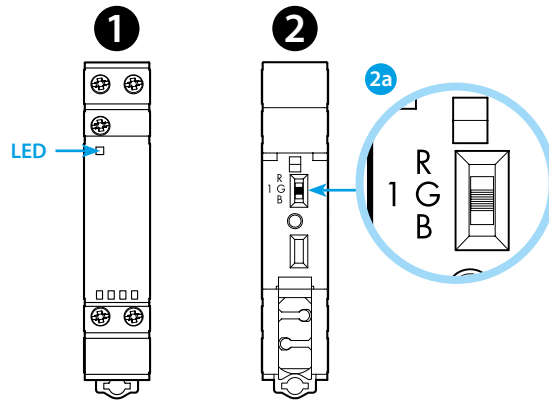

# ENGLISH

## 19.31 1-CHANNEL STATUS INDICATING MODULE

- 1 FRONT VIEW**
- 2 REAR**  
2a LED selector, 3 colours: Red (R), Green (G), Blue (B)
- 3 WIRING DIAGRAM**  
(application example)
- 4 FUNCTION**  
The LED colour is selected by the dip-switch on the rear face of the module, prior to mounting on the 35 mm rail.  
The colour is determined by the system designer according to the urgency or importance of the signal.  
Commonly, the following levels of importance or urgency are assigned to the Red, Green and Blue colours according to EN 60073:
  - Red LED: Error
  - Green LED: In operation
  - Blue LED: Alarm (fire or similar)
 A change-over output contact, following the input to the module.